



Datasheet

Customer : Campbell Collins

Drawing no. : 100002963

Page 1 / 1

Hauke Michelsen Date : 25.03.02 10:57

Type : LFAZ32050035050

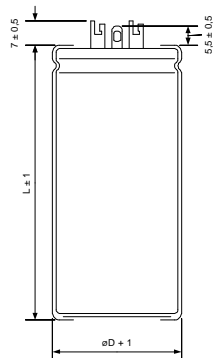

Ø D : 35 mm

L : 50 mm

Terminals : Solder lugs

Electrical Parameter

Rated capacitance (C_R) 100 Hz / 20 °C	32 + 32 μF	
Tolerance	-10 +30 %	
Rated voltage (U_R)	500 V	
Peak voltage (U_P) max. 5 x 1 min / h	550 V	
Reverse voltage (U_U) max. 1 s	2 V	
Leakage current (I_L) U_B / 5 min / 20 °C	128 μA	
ESR typ. 100 Hz / 20°C	4 Ω	
Tan δ typ. 100 Hz / 20°C	8 %	
Z max. 10 kHz / 20°C	7 Ω	
ESL typ.	20 nH	
Rated ripple current (I_R) 100 Hz / °C	0,4 A	
Useful life @ $I_R, U_R, ^\circ\text{C}$	4000 h	
IEC climatic category / standards	40 /85/ 56	IEC 384
Applications	Tube amplifier	
Your article no. / Project		