

1. Features of C301369A Series :

- 34.0 × 34.0mm Max.(L×W), 26.0mm Max. Height.
- Inductance range: 5.3mH~10.0mH, Custom values are welcomed.
- AC common mode noise filter for Power Supplies and Lighting Application.
- Rated Voltage: 250VAC.
- Dielectric strength:1500Vrms,winding to winding.
- UL 94 V-0 Material.
- Operating temperature: -40 to +105°C.
- RoHS Compliant Components.



2. Electrical Characteristics of C301369A Series:

| ITG Part Number | OCL ¹ (PIN1-4/2-3) (mH) ±30% | DCR (mΩ) Max. @25°C | Irated ² (A) Max. @25°C | Dim. F (mm) Nom. |
|-----------------|--|---------------------------|--|------------------------|
| C301369A-532NU | 5.30 | 27.00 | 7.60 | Φ1.10 |
| C301369A-752NU | 7.50 | 32.50 | 7.00 | Φ1.10 |
| C301369A-103NU | 10.00 | 44.00 | 6.00 | Φ1.00 |

3. Mechanical Dimension of C301369A Series (Unit:mm):

| A Max. | B Max. | C ±0.50 | D Max. | E1 ±0.50 | E2 ±0.50 | E3 ±0.50 | F Nom. |
|-----------|-----------|------------|-----------|-------------|-------------|-------------|-----------------|
| 34.00 | 34.00 | 5.00 | 26.00 | 22.00 | 18.00 | 14.00 | See table above |

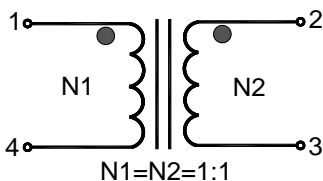

SCHEMATIC DIAGRAM

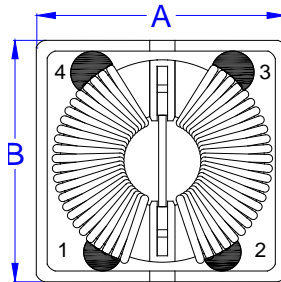

Side View

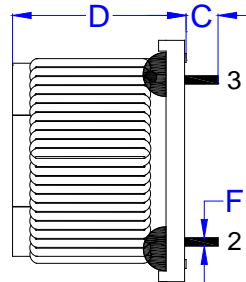

Front View

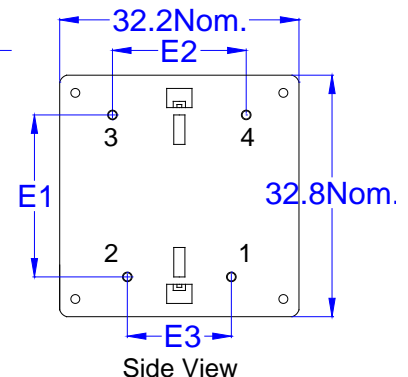

Side View

Third Angle Projection:

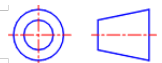

Notes:

1. Open Circuit Inductance (OCL) measured at 1KHz, 0.1mA @ 25°C.
2. Irated: Irate is defined as the applied current level that cause 40 °C temperature rise without force air flow.
3. Impedance measures with both windings in parallel and at ambient temperature(25°C).



C301369A Series



4. Impedance vs Frequency Curve of C301369A Series :

