

3M™ MOLDED ASSEMBLY, 1M SERIES
 .100" X .100" FOR .050" PITCH CABLE, CABLE ASSEMBLY CONNECTOR

3M™ MOLDED SOCKET CONNECTOR
 871 SERIES

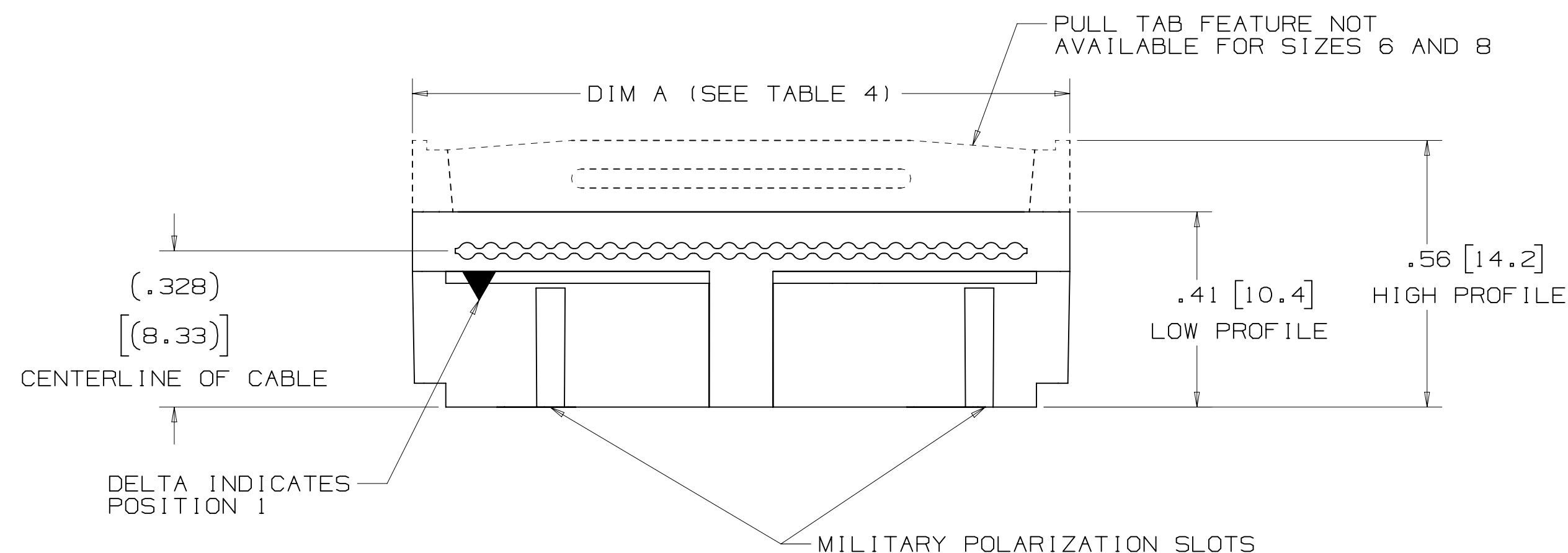
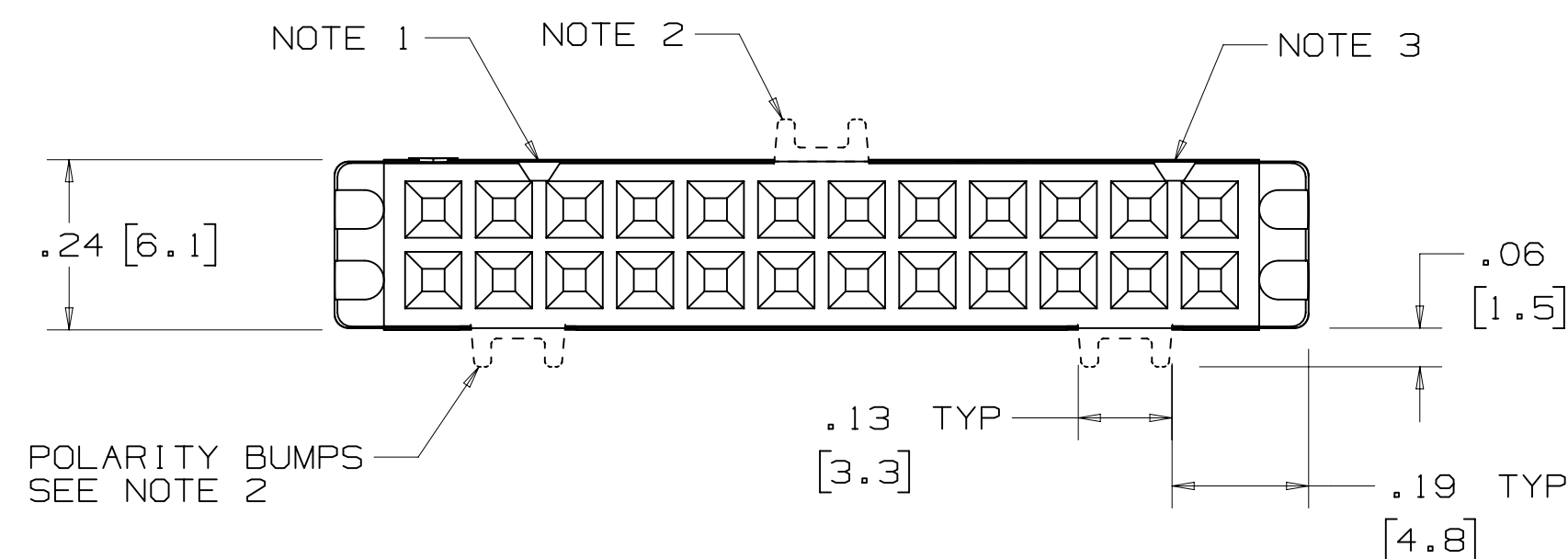
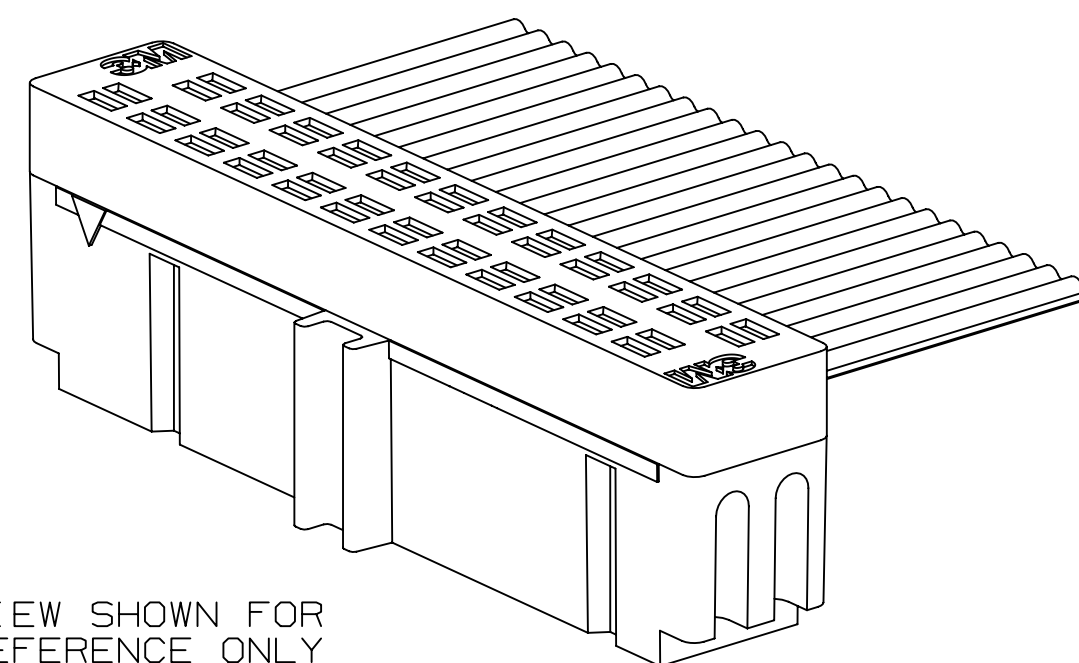

TABLE 4	
CONTACT QTY	DIM A
6	.48 [12.2]
8	.58 [14.7]
10	.68 [17.3]
12	.78 [19.8]
14	.88 [22.4]
16	.98 [24.9]
20	1.10 [30.3]
24	1.38 [35.1]
26	1.48 [37.6]
30	1.68 [42.7]
34	1.88 [47.8]
36	1.98 [50.3]
40	2.18 [55.4]
50	2.68 [68.1]
60	3.18 [80.8]
64	3.38 [85.9]



- NOTES:
 1. THIS POLARIZATION SLOT IS NONEXISTENT ON SIZES 6, 8, 10, 12 AND 14.
 2. OPTIONAL CENTERBUMP POLARITY FEATURE.
 3. THIS POLARIZATION SLOT IS NONEXISTENT ON SIZES 6 AND 8.



PULL TAB FEATURES VARY WITH CONNECTOR SIZE

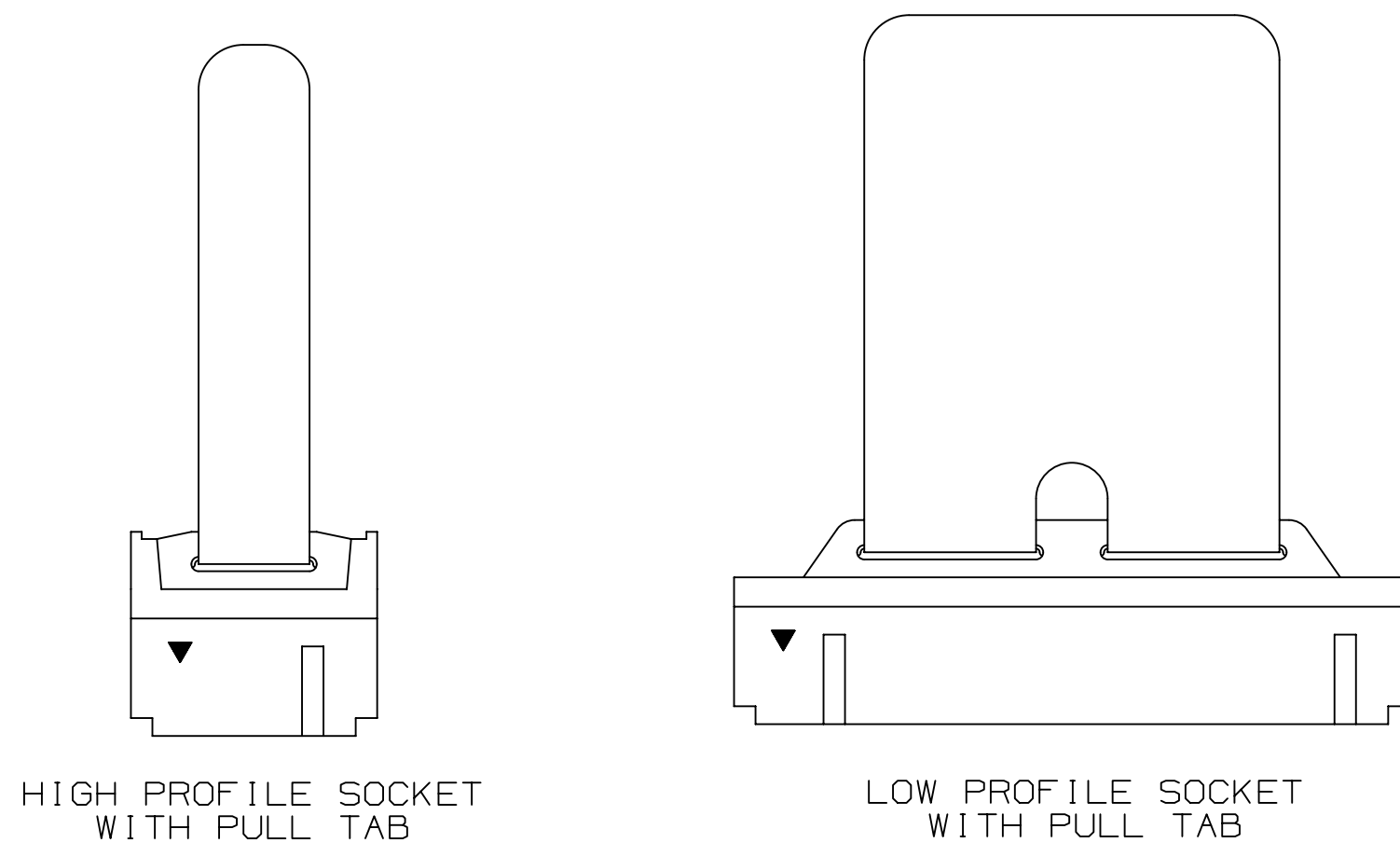

3M ELECTRONICS MATERIALS SOLUTIONS DIVISION
 INTERCONNECT SOLUTIONS
<http://www.3M.com/interconnect>

3M IS A TRADEMARK OF 3M COMPANY.
 FOR TECHNICAL, SALES OR ORDERING
 INFORMATION CALL 800-225-5373

DESIGN REFERENCE	NEXT ASSEMBLY	REV	ECO	ISSUE DATE AND DESCRIPTION	DRFT	CHKD
				MAY 27, 2022 WORK REQUEST 13229 INITIAL RELEASE	LDS	JG
APPROVED	DATE	DATE	DATE	DATE	DATE	DATE
DRP L SCHMIDT	MAR 04, 2022	MFG				
CHKD J GOERTZ	APR 29, 2022	APPL				
DIVISION	DIVISION CODE	© 3M COPYRIGHT 2022 This document and the information it contains are 3M property and may not be reproduced or further distributed without 3M permission, or used or disclosed other than for 3M authorized purposes. All rights reserved.				
DO NOT SCALE DRAWING	SCALE 1/1	TOLERANCES EXCEPT AS NOTED INCHES: .0 ± .01 .00 ± .005 .0000 ± .0002 MILLIMETERS: 0 ± .05 .00 ± .005 .000 ± .0005 ANGLE ± 1°				
THIRD ANGLE PROJECTION	INTERPRET PER ASME Y14.5 - 2018	TITLE MOLDED CABLE ASSY .100 WITH SOCKET AND PCB CONNECTORS				
MAX SURFACE ROUGHNESS 125	ALL SURFACES MARKED ONLY	CAGE NUMBER	SIZE	DRAWING NO.	REV.	
		D		78-5100-2754-9	A	
		MODEL	DET	ISTS	YES	NO
					SHT	3 OF 5

78-5100-2754-9
 DRAWING NUMBER
 A REVISION
 6
 Drf-set (hrs)
 6
 UTC
 5/27/2022
 Time

3M™ MOLDED ASSEMBLY, 1M SERIES
 .100" X .100" FOR .050" PITCH CABLE, CABLE ASSEMBLY CONNECTOR

3M™ MOLDED 2-ROW PCB CONNECTOR
 878 SERIES

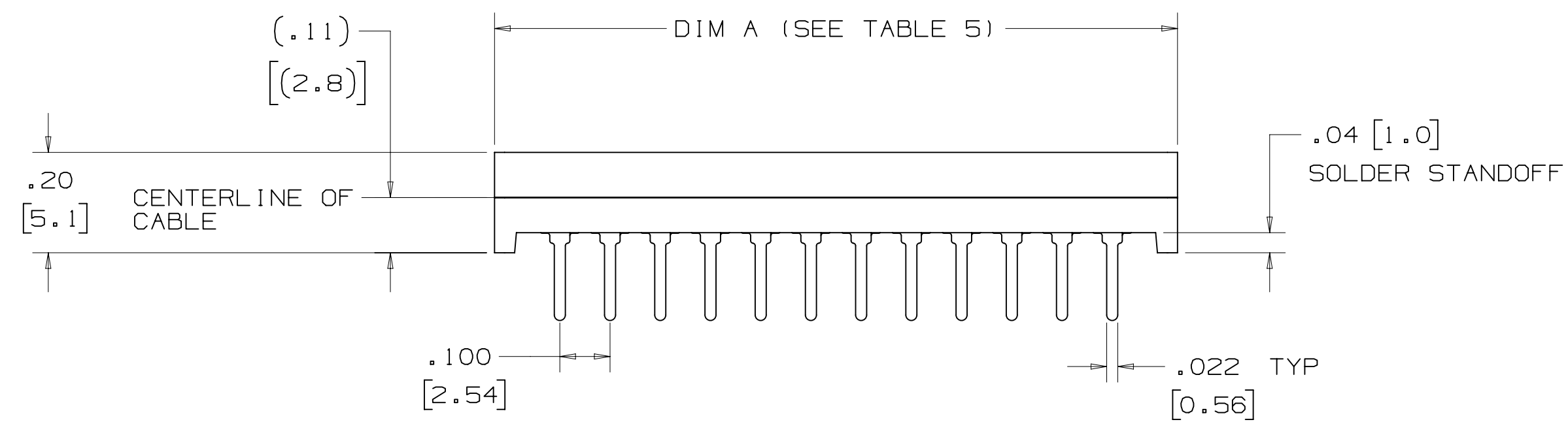
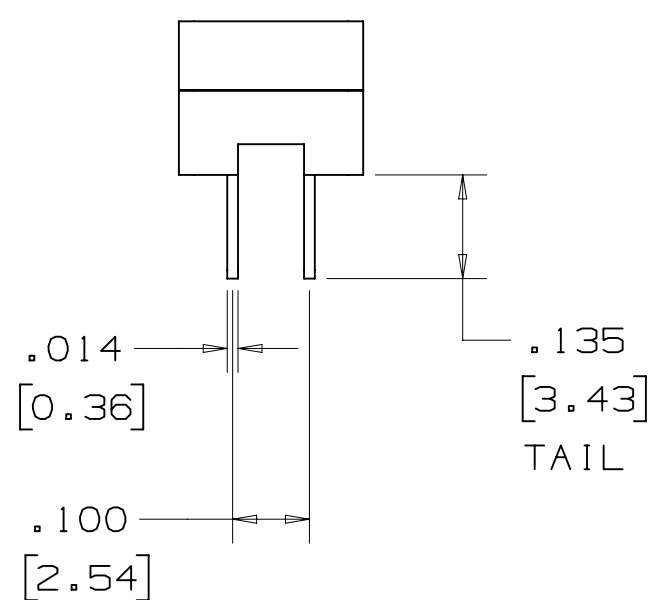
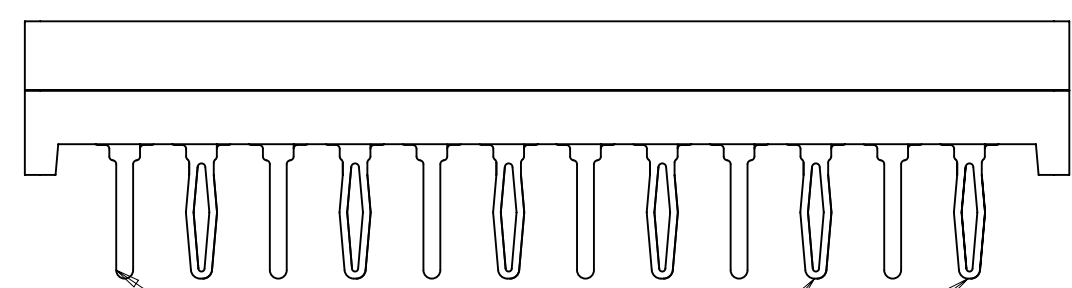

RETENTION CONTACTS ORIENTED AS SHOWN EVERY OTHER CONTACT WITH THE FIRST AND SECOND ROW ORDER SHIFTED BY ONE CONTACT. (ORIENTATION NOT BASED ON DELTA LOCATION AND MAY VARY FROM CONNECTOR TO CONNECTOR)

TABLE 5	
CONTACT QTY	DIM A
06	.46 [11.7]
08	.56 [14.2]
10	.66 [16.8]
14	.86 [21.8]
16	.96 [24.4]
20	1.16 [29.5]
24	1.36 [34.5]
26	1.46 [37.1]
30	1.66 [42.1]
34	1.86 [47.2]
36	1.96 [49.8]
40	2.16 [54.9]
44	2.36 [59.9]
50	2.66 [67.6]
60	3.16 [80.3]
64	3.36 [85.3]

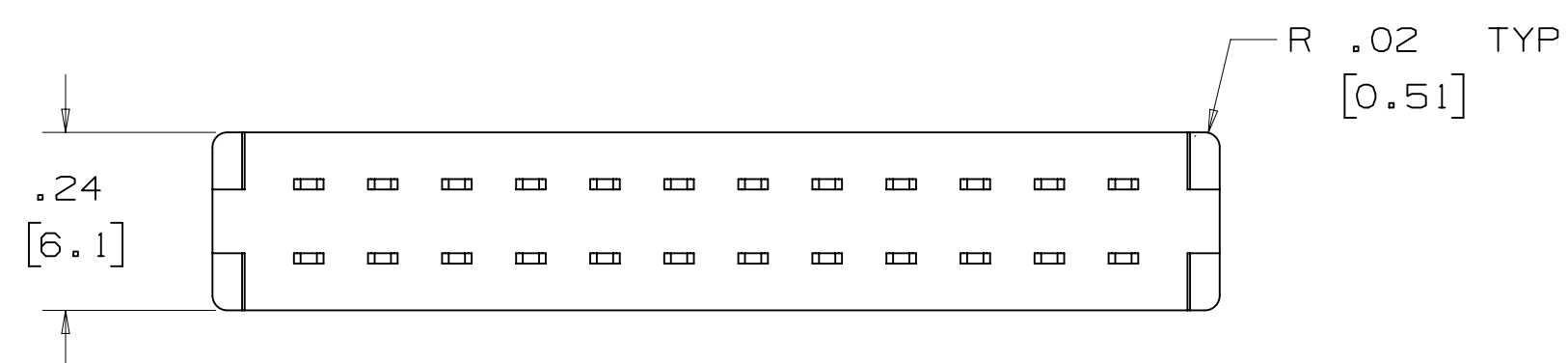

OR .040 ±.003 [1.02]

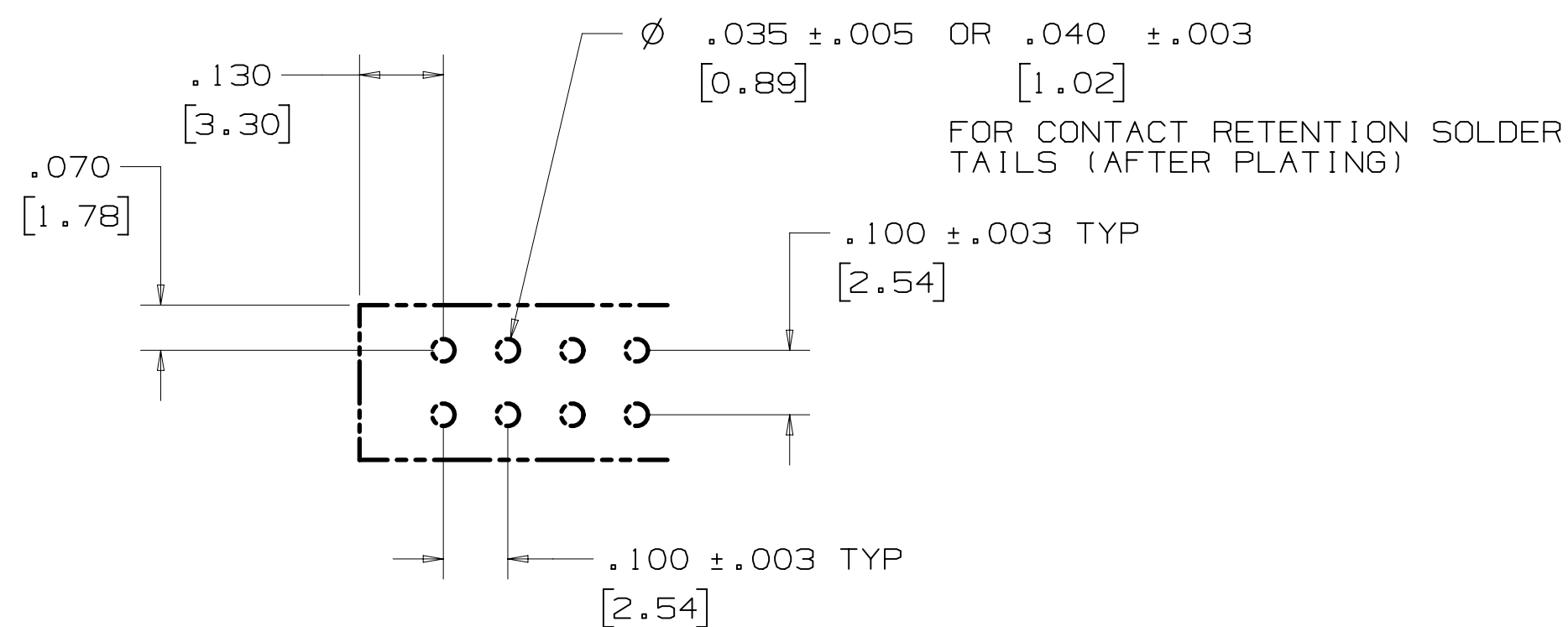

RECOMMENDED MOUNTING HOLE PATTERN
 (SHOWN FROM MOUNTING SIDE OF BOARD)

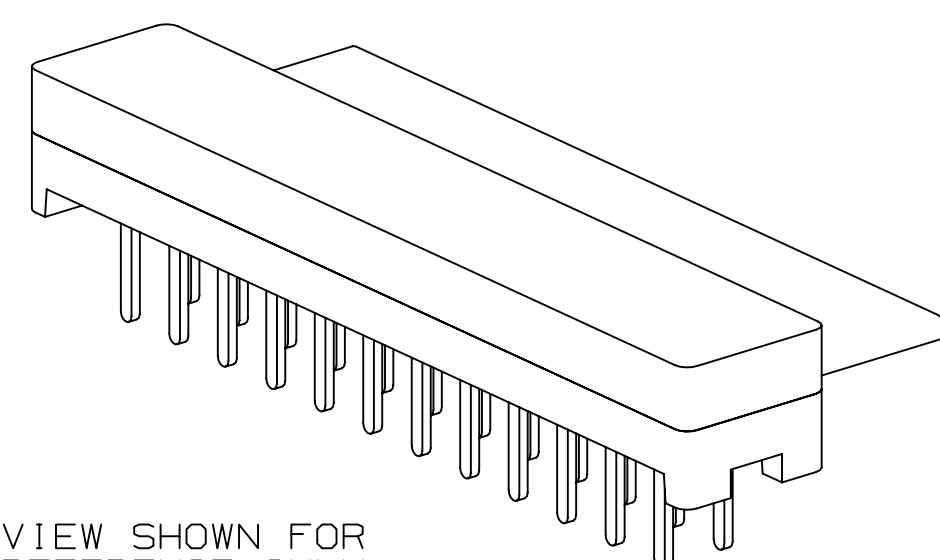

VIEW SHOWN FOR REFERENCE ONLY

3M ELECTRONICS MATERIALS SOLUTIONS DIVISION
 INTERCONNECT SOLUTIONS
<http://www.3M.com/interconnect>

3M IS A TRADEMARK OF 3M COMPANY.
 FOR TECHNICAL, SALES OR ORDERING
 INFORMATION CALL 800-225-5373

DESIGN REFERENCE	NEXT ASSEMBLY	REV	ECO	ISSUE DATE AND DESCRIPTION	DRFT	CHKD
				MAY 27, 2022 WORK REQUEST 13229 INITIAL RELEASE	LDS	JG
APPROVED	DATE	DATE	DATE	DATE	DATE	DATE
DIVISION		DIVISION CODE		© 3M COPYRIGHT 2022 This document and the information it contains are 3M property and may not be reproduced or further distributed without 3M permission, or used or disclosed other than for 3M authorized purposes. All rights reserved.		
DO NOT SCALE DRAWING	SCALE 1/1	TOLERANCES EXCEPT AS NOTED		3M Center St. Paul, MN 55144		
THIRD ANGLE PROJECTION		INCHES .0 ±.1 .00 ±.01 .000 ±.005 .0000 ±.0002		TITLE MOLDED CABLE ASSY .100 WITH SOCKET AND PCB CONNECTORS		
INTERPRET PER ASME Y14.5 - 2018		MILLIMETERS 0 ±		CAGE NUMBER D78-5100-2754-9		
MAX SURFACE ROUGHNESS 125		.0 ± .00 ± .000 ±		DRAWING NO. 78-5100-2754-9		
<input type="checkbox"/> ALL SURFACES <input checked="" type="checkbox"/> MARKED ONLY		ANGLES ±1°		REV. A		
				MODEL DET. [] SHT 4 OF 5		

REVISION
 DRAWING NUMBER
 78-5100-2754-9
 UTC
 Drf-set (hrs) 6

3M™ MOLDED ASSEMBLY, 1M SERIES
 .100" X .100" FOR .050" PITCH CABLE, CABLE ASSEMBLY CONNECTOR

Regulatory: For regulatory information about this product, visit 3M.com/regs or contact your 3M representative.

Technical Information: The technical information, recommendations and other statements contained in this document are based upon tests or experience that 3M believes are reliable, but the accuracy or completeness of such information is not guaranteed.

Product Use: Many factors beyond 3M's control and uniquely within user's control can affect the use and performance of a 3M product in a particular application. Given the variety of factors that can affect the use and performance of a 3M product, user is solely responsible for evaluating the 3M product and determining whether it is fit for a particular purpose and suitable for user's method of application.

Warranty, Limited Remedy, and Disclaimer: Unless an additional warranty is specifically stated on the applicable 3M product packaging or product literature, 3M warrants that each 3M product meets the applicable 3M product specification at the time 3M ships the product. 3M MAKES NO OTHER WARRANTIES OR CONDITIONS, EXPRESS OR IMPLIED, INCLUDING, BUT NOT LIMITED TO, ANY IMPLIED WARRANTY OR CONDITION OF MERCHANTABILITY OR FITNESS FOR A PARTICULAR PURPOSE OR ANY IMPLIED WARRANTY OR CONDITION ARISING OUT OF A COURSE OF DEALING, CUSTOM OR USAGE OR TRADE. If the 3M product does not conform to this warranty, then the sole and exclusive remedy is, at 3M's option, replacement of the 3M product or refund of the purchase price.

Limitation of Liability: Except where prohibited by law, 3M will not be liable for any loss or damage arising from the 3M product, whether direct, indirect, special, incidental or consequential, regardless of the legal theory asserted, including warranty, contract, negligence or strict liability.

3M Company
 Electronics Materials Solutions Division
 13011 McCallen Pass, Bldg. C
 Austin, TX 78753-5380
 1-800-225-5373
www.3M.com/interconnect

3M ELECTRONICS MATERIALS SOLUTIONS DIVISION
 INTERCONNECT SOLUTIONS
<http://www.3M.com/interconnect>

3M IS A TRADEMARK OF 3M COMPANY.
 FOR TECHNICAL, SALES OR ORDERING
 INFORMATION CALL 800-225-5373

DESIGN REFERENCE		NEXT ASSEMBLY		REV	ECO	ISSUE DATE AND DESCRIPTION		DRFT	CHKD																																										
A 0104943						MAY 27, 2022 WORK REQUEST 13229 INITIAL RELEASE		LDS	JG																																										
DRW	DATE	MFG	DATE	This document and the information it contains are 3M property and may not be reproduced or further distributed without 3M permission, or used or disclosed other than for 3M authorized purposes. All rights reserved.																																															
L SCHMIDT	MAR 04, 2022			© 3M COPYRIGHT 2022																																															
CHKD	DATE	APPL	DATE	3M Center St. Paul, MN 55144																																															
J GOERTZ	APR 29, 2022			<table border="1"> <tr> <td>DO NOT SCALE DRAWING</td> <td>SCALE 1/1</td> <td>TOLERANCES EXCEPT AS NOTED</td> </tr> <tr> <td></td> <td></td> <td>INCHES</td> </tr> <tr> <td></td> <td></td> <td>.0 ± .1</td> </tr> <tr> <td></td> <td></td> <td>.00 ± .01</td> </tr> <tr> <td></td> <td></td> <td>.000 ± .005</td> </tr> <tr> <td></td> <td></td> <td>.0000 ± .0002</td> </tr> <tr> <td>THIRD ANGLE PROJECTION</td> <td></td> <td>MILLIMETERS</td> </tr> <tr> <td></td> <td></td> <td>0 ±</td> </tr> <tr> <td>INTERPRET PER ASME Y14.5 - 2018</td> <td></td> <td>.0 ±</td> </tr> <tr> <td></td> <td></td> <td>.00 ±</td> </tr> <tr> <td>MAX SURFACE ROUGHNESS</td> <td></td> <td>.000 ±</td> </tr> <tr> <td>125</td> <td><input type="checkbox"/> ALL SURFACES</td> <td></td> </tr> <tr> <td></td> <td><input checked="" type="checkbox"/> MARKED ONLY</td> <td></td> </tr> <tr> <td></td> <td></td> <td>ANGLES ±1°</td> </tr> </table>						DO NOT SCALE DRAWING	SCALE 1/1	TOLERANCES EXCEPT AS NOTED			INCHES			.0 ± .1			.00 ± .01			.000 ± .005			.0000 ± .0002	THIRD ANGLE PROJECTION		MILLIMETERS			0 ±	INTERPRET PER ASME Y14.5 - 2018		.0 ±			.00 ±	MAX SURFACE ROUGHNESS		.000 ±	125	<input type="checkbox"/> ALL SURFACES			<input checked="" type="checkbox"/> MARKED ONLY				ANGLES ±1°
DO NOT SCALE DRAWING	SCALE 1/1	TOLERANCES EXCEPT AS NOTED																																																	
		INCHES																																																	
		.0 ± .1																																																	
		.00 ± .01																																																	
		.000 ± .005																																																	
		.0000 ± .0002																																																	
THIRD ANGLE PROJECTION		MILLIMETERS																																																	
		0 ±																																																	
INTERPRET PER ASME Y14.5 - 2018		.0 ±																																																	
		.00 ±																																																	
MAX SURFACE ROUGHNESS		.000 ±																																																	
125	<input type="checkbox"/> ALL SURFACES																																																		
	<input checked="" type="checkbox"/> MARKED ONLY																																																		
		ANGLES ±1°																																																	
CAGE NUMBER		SIZE	DRAWING NO.	REV.																																															
D 78-5100-2754-9				A																																															
MODEL		DET		SHT		5 OF 5																																													
		LISTS		YES		X NO																																													

78-5100-2754-9
 DRAWING NUMBER
 A
 REVISION
 6
 Dff-set
 (hrs)
 6
 UTC
 5/27/2022
 Time
 Standard
 Central
 Imaged: