

# SMT Power Inductors

## Special Features

- High current capacity
- Ferrite bobbin core
- Low core loss for high frequency power application
- Compact size
- Large terminal surface for good PCB bonding
- Operating temperature -30 to +100 °C
- Tape & reel packaged 1500/reel

## Notes

- \* Current to cause max. 10 % of inductance drop, or 40 °C temperature rise

PM54 Series							
Part Number	L (μH) ±20 %	Test Freq.	SRF	DCR	I, DC* (A)	Bourns Equivalent	
			(MHz) Typ.	Ω Max.			
PM54-100M-RC	10	2.52 MHz	30	0.10	1.44	SDR0604	
PM54-120M-RC	12	2.52 MHz	27	0.12	1.40		
PM54-150M-RC	15	2.52 MHz	25	0.14	1.30		
PM54-180M-RC	18	2.52 MHz	23	0.15	1.23		
PM54-220M-RC	22	2.52 MHz	19	0.18	1.11		
PM54-270M-RC	27	2.52 MHz	17	0.20	0.97		
±15 %							
PM54-330L-RC	33	2.52 MHz	16	0.23	0.88		
PM54-390L-RC	39	2.52 MHz	15	0.32	0.80		
PM54-470L-RC	47	2.52 MHz	13	0.37	0.72		
±10 %							
PM54-560K-RC	56	2.52 MHz	12	0.42	0.68		
PM54-680K-RC	68	2.52 MHz	11	0.46	0.61		
PM54-820K-RC	82	2.52 MHz	10	0.60	0.58		
PM54-101K-RC	100	1 KHz	9	0.70	0.52		
PM54-121K-RC	120	1 KHz	8	0.93	0.48		
PM54-151K-RC	150	1 KHz	8	1.10	0.40		
PM54-181K-RC	180	1 KHz	6	1.38	0.38		
PM54-221K-RC	220	1 KHz	5	1.57	0.35		

Available only as RoHS compliant beginning July 2007.

When ordering non-RoHS compliant versions before July 2007, do not include the -RC suffix in the part number.

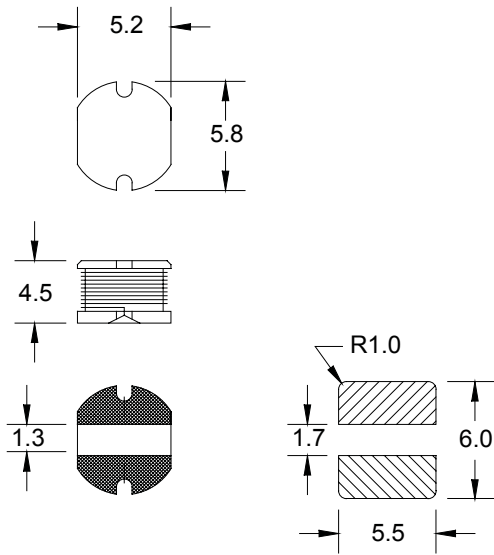

Dimensions: mm  
Tolerance: -/+0.35

Pad Layout

**BOURNS®**

Tel. (877) 426-8767 • Fax (951) 781-5006

www.bourns.com