

### 90° PC PHONO JACK

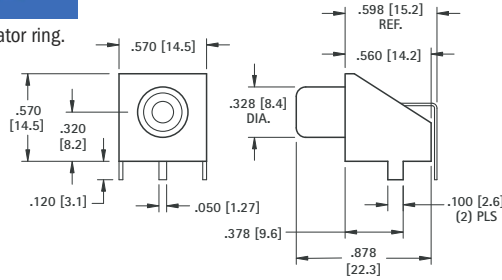

Complete one piece jack for insertion into PC board.  
Time Saving. No Wiring Required.

- Black insulator ring.



**MATERIAL:**  
Base: Steel, Tin Plate  
Shell: Steel, Nickel Plate  
Contact: Brass, Tin Plate

**CAT. NO. 902**

Mounting Detail

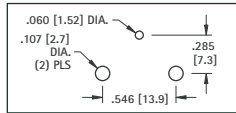

### SNAP-FIT 90° PC PHONO JACKS

#### CHOICE OF TIN OR GOLD PLATE



Complete one piece jack for insertion into PC board.  
Time Saving. No Wiring Required.  
Snap-fits into PC board.

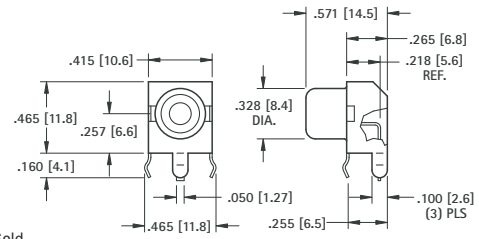

**MATERIAL:**  
Shell: Steel  
Contact: Brass  
Plating: Tin or Gold

TIN PLATE CAT. NO.	INSULATOR COLOR	GOLD PLATE CAT. NO.
587	WHITE	936
588	RED	937
901	BLACK	900
589	YELLOW	938

Mounting Detail

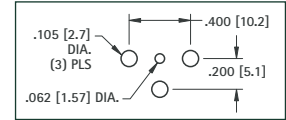

### SNAP-FIT VERTICAL PC JACK

- Snaps into holes on PC board and firmly held for soldering
- No staking required



- Red insulator ring

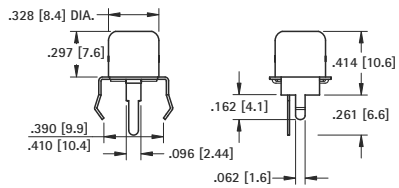

**MATERIAL:**  
Shell: Steel, Tin Plate  
Contact: Brass, Tin Plate

**CAT. NO. 572**

Mounting Detail

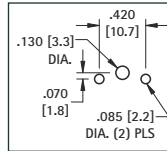

### SNAP-FIT VERTICAL PC PHONO JACKS

- Extra long, one piece shell to accept plugs with longer pins for greater contact
- Snaps into holes on PC board and firmly held for soldering
- No staking required

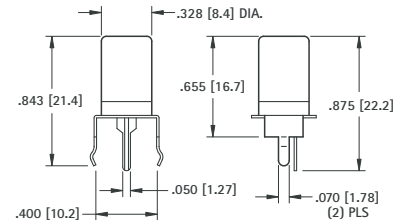

CAT. NO.	INSULATOR COLOR
584	WHITE
577	RED
585	BLACK
586	YELLOW

**MATERIAL:**  
Shell: Steel, Nickel Plate  
Contact: Brass, Tin Plate

Mounting Detail

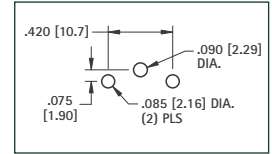

### PC PHONO JACKS

#### VERTICAL

- For applications requiring staking to product



- White insulator ring

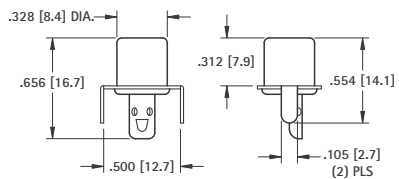

**MATERIAL:**  
Shell: Steel, Tin Plate  
Contact: Brass, Tin Plate

**CAT. NO. 573**

Mounting Detail

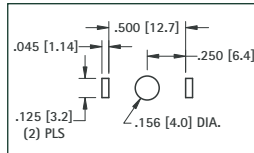

#### HORIZONTAL

- Mounted on bracket ready for insertion into pre-drilled holes
- Solder lug allows remote attachment of signal to PC board



- Red insulator ring

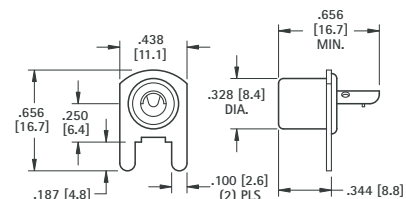

**MATERIAL:**  
Shell: Steel, Tin Plate  
Contact: Brass, Tin Plate

**CAT. NO. 571**

Mounting Detail

