

**Dimensions mm[inch]**  
tolerances according to DIN ISO 2768-m  
Toleranzen gem. DIN ISO 2768-m

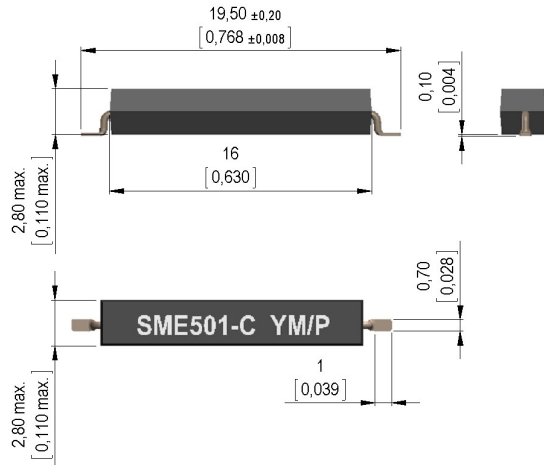

**Isometric**  
Scale: 2:1  
Maßstab 2:1



**Marking**  
according to EN60062/factory code  
gem. EN60062/Fertigungsstätte

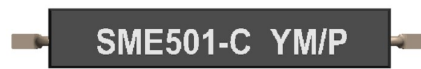

**Recommended PCB Pad Layout**

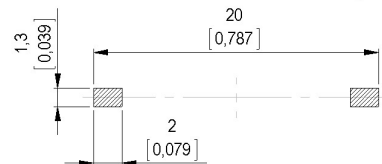

**Solder Reflow Profile**

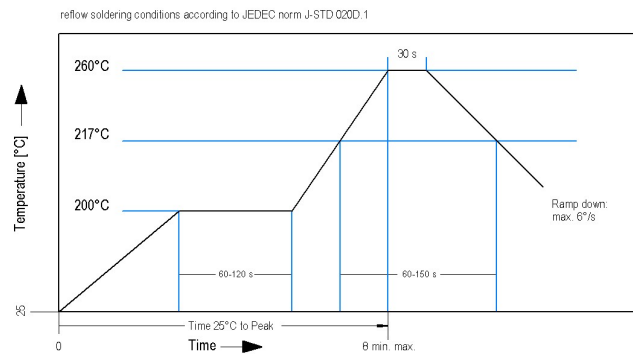

**Packaging**  
(4001350075)

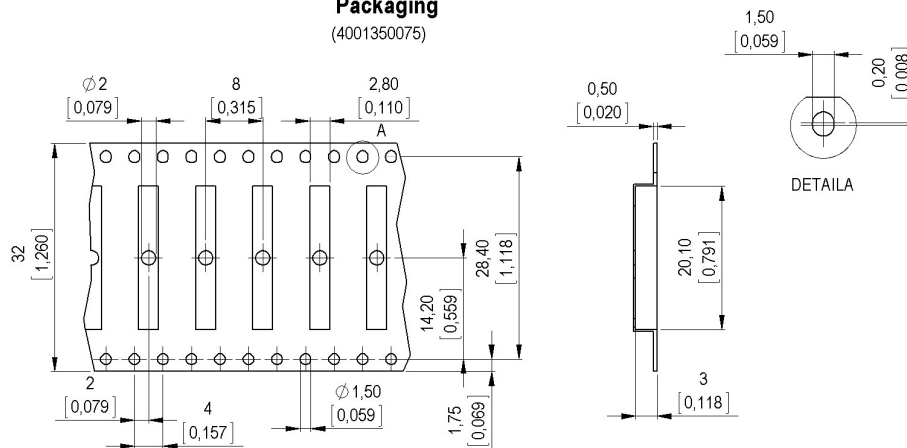

Modifications in the sense of technical progress are reserved

Designed at: 09.04.13 Designed by: WKOVACS  
Last Change at: 14.10.14 Last Change by: WKOVACS

Approval at: 13.08.13 Approval by: DRUDOLF  
Approval at: 20.10.14 Approval by: AWEBER

Version: 03



Europe: +49 / 7731 8399 0

| Email: info@standexmeder.com

Item No.:

USA: +1 / 508 295 0771

| Email: salesusa@standexmeder.com

9155010023

Asia: +852 / 2955 1682

| Email: salesasia@standexmeder.com

Item:

MK15-501-C-2

| Magnetic properties                   | Conditions                                  | Min            | Typ | Max  | Unit |
|---------------------------------------|---|----------------|-----|------|------|
| Pull-In                               | at 20°C                                     | 28             |     | 54   | AT   |
| Test equipment                        |   | KMS-11 + AP097 |     |      |      |
| Pull-In in milliTesla (modified conta | MS150 -<br>phys. caused tolerance +/- 0,1mT | 1,8            |     | 2,35 | mT   |
| Test equipment                        |   | MS-150         |     |      |      |

| Contact data 06/2         | Conditions   | Min       | Typ | Max | Unit |
|---------------------------|--|-----------|-----|-----|------|
| Contact-form              |  | A         |     |     |      |
| Contact-material          |  | PGM-alloy |     |     |      |
| Contact rating            | Any DC combination of V & A<br>not to exceed their individual max.'s |           |     | 10  | W    |
| Switching voltage         | DC or Peak AC  |           |     | 200 | V    |
| Switching current         | DC or Peak AC  |           |     | 0,5 | A    |
| Carry current             | DC or Peak AC  |           |     | 1   | A    |
| Contact resistance static | Measured with 40% overdrive<br>Start value                           |           |     | 100 | mOhm |
| Insulation resistance     | RH <45 %, 100 V test voltage   | 10        |     |     | GOhm |
| Breakdown voltage         | according to EN 60255-5  | 250       |     |     | VDC  |
| Operate time incl. bounce | measured with 40% overdrive  |           |     | 0,5 | ms   |
| Release time              | measured with no coil excitation                                     |           |     | 0,1 | ms   |
| Capacity                  | @ 10 kHz across open switch  |           | 0,3 |     | pF   |

| Special Product Data | Conditions | Min                  | Typ | Max | Unit |
|----------------------|------------|----------------------|-----|-----|------|
| Housing material     |            | mineral-filled epoxy |     |     |      |

| Environmental data  | Conditions                         | Min          | Typ | Max | Unit |
|---------------------|------------------------------------|--------------|-----|-----|------|
| Shock               | 1/2 sine, duration 11ms, in 3 axis |              |     | 30  | g    |
| Vibration           | from 10 - 2000 Hz                  |              |     | 20  | g    |
| Ambient temperature |                                    | -40          |     | 125 | °C   |
| Storage temperature |                                    | -50          |     | 155 | °C   |
| Cleaning            |                                    | fully sealed |     |     |      |

Modifications in the sense of technical progress are reserved

Designed at: 09.04.13 Designed by: WKOVACS

Approval at: 13.08.13 Approval by: DRUDOLF

Last Change at: 14.10.14 Last Change by: WKOVACS

Approval at: 20.10.14 Approval by: AWEBER

Version: 03