

Male

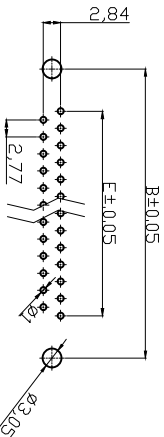

RECOMMENDED PCB LAYOUT

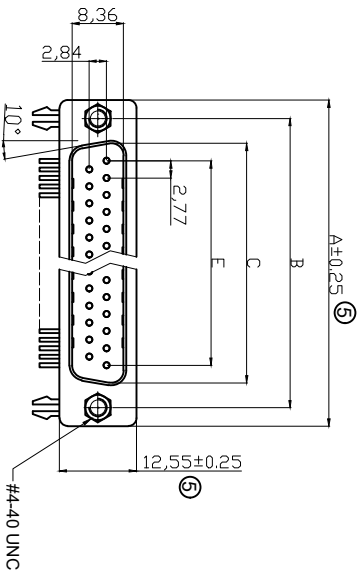
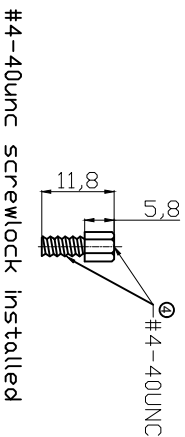
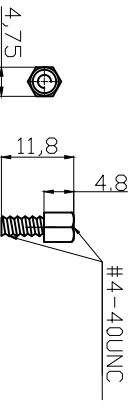

#4-40UNC screwlock installed

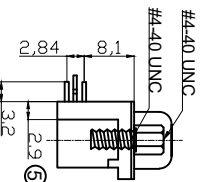
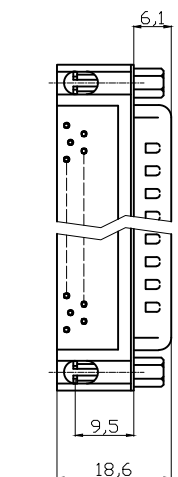

NOTES:

MATERIAL

- 1. Insulator Material: Glass-Filled Thermoplastic PBT, UL 94V-0, Black
- 2. Contact Material : Brass
- 3. Contact plating : See order code
- 4. Shell : Steel, 100u" Tin over 50u" min copper
- 5. Clinch Nut : Copper alloy, Nickel plated
- 6. Boardlock : Brass, Tin plated
- 7. Screwlock : Steel, Nickel plated

ELECTRICAL

- 1. Current Rating : 3AMP
- 2. Voltage Rating : 250V AC/rms 60Hz
- 3. Contact Resistance: 20mΩ max at 1 AMP DC
- 4. Insulation Resistance: 1000MΩ at 500 V DC
- 5. Withstand Voltage : 1000V AC/rms 60Hz for 1 minute
- 6. Operating Temperature: -55°C--+105°C

Order Code: A-Dx xx A/KG-xx * on request

- Contact style:
 - F - Female
 - S - Male
- No. of Contacts: 09 / 15 / 25 / 37
- Version:
 - T2 - with locking bolts UNC (Gold flash full gold)
 - T2S - with locking bolts UNC (Gold flash selective Sn)
 - T4 - without locking bolts *(Gold flash full gold)
 - T4-2 - without locking bolts *(selective 15u" Au for 9&15P)
 - T4S - without locking bolts *(Gold flash selective Sn)
- Standard: Quality class III

⑧ ⑨ T2A - with UNC screw of 5.8mm, NON-UL (Gold flash full gold)

| Dimensions | A | B | C | E |
|------------|----|-------|-------|-------|
| Positions | 9 | 30.81 | 24.99 | 16.92 |
| | 15 | 39.20 | 33.30 | 25.25 |
| | 25 | 53.05 | 47.04 | 38.96 |
| | 37 | 69.40 | 63.50 | 55.42 |
| | | | | 49.86 |

7.2mm Footprint

ROHS compliant

Unit: mm



| Scale | Free | ⑧ | Update the specification of T2A | Daniel | 29.03.2022 |
|------------------|-------|---|--|--------|------------|
| TOLERANCE | | ⑦ | Update the description of plating | Daniel | 17.09.2021 |
| X. | ±0.38 | ⑥ | Add UL logo | Winnie | 27.02.2020 |
| X.X | ±0.25 | ⑤ | Add insulator thickness, update tolerance and adjust profile | Xavier | 18.02.2019 |
| X.XX | ±0.13 | ④ | Add the specification: T2A | Winnie | 13.06.2017 |
| DIM | TOL | ③ | Add the plating specification 15u" Au | Winnie | 05.03.2015 |
| X.° | ±3° | | | | |
| X.X° | ±1.0° | | | | |
| Angle | TOL | | Modification | | |

| Date | Name | Customer-No. |
|------------|--------|--------------|
| 15.08.2012 | Lucas | |
| 29.03.2022 | Daniel | |

ASSMANN WSW-No.
A-DX xx A/KG-T2/T2S/T4/T4-2/T4S/T2A

Drawing-No.
ASS 4888 CO

Replace
rev08

Sheet
1/2



1

2

3

4

5

6

7

1

2

3

4

5

6

7

A

B

C

D

E

F

G

H

Female

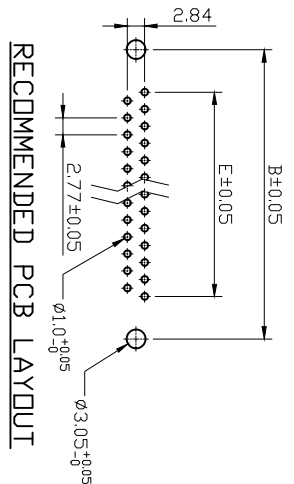
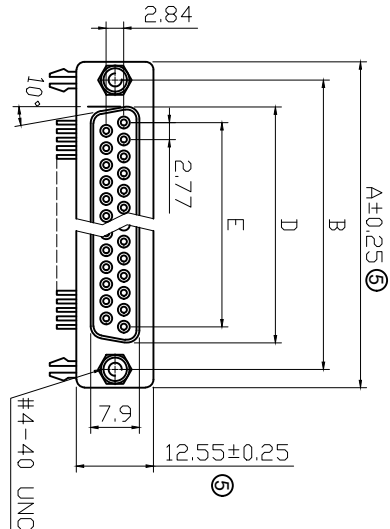

RECOMMENDED PCB LAYOUT

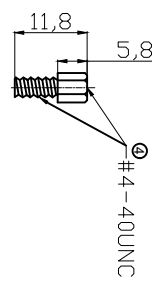
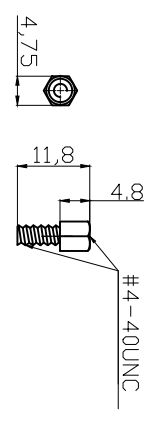

#4-40UNC screwlock installed

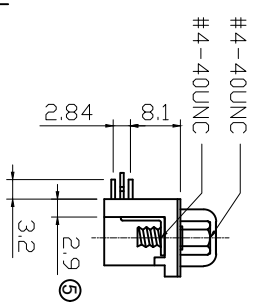
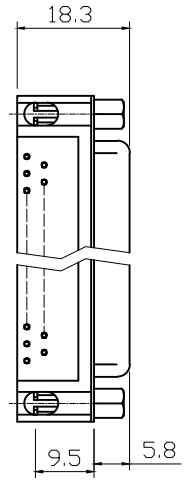

7.2mm Footprint

- NOTES:**
- MATERIAL**
- Insulator Material: Glass-Filled Thermoplastic PBT, UL 94V-0, Black
 - Contact Material: Copper alloy
 - Contact plating: See order code
 - Shell: Steel, 100u" Tin over 50u" min copper
 - Boardlock: Brass, Tin plated
 - Screwlock: Steel, Nickel plated
- ELECTRICAL**
- Current Rating: 3AMP
 - Voltage Rating: 250V AC/rms 60Hz
 - Contact Resistance: 20mΩ max at 1 AMP DC
 - Insulation Resistance: 1000MΩ at 500 V DC
 - Withstand Voltage: 1000V AC/rms 60Hz for 1 minute
 - Operating Temperature: -55°C to +105°C

- Order Code: A-Dx xx AKG-xx * on request
- Contact style:
 F - Female
 S - Male
 No. of Contacts
 09 / 15 / 25 / 37
- Version
 T2 - with locking bolts UNC (Gold flash full gold)
 T2S - with locking bolts UNC (Gold flash selective Sn)
 T4 - without locking bolts *(Gold flash full gold)
 T4-2 - without locking bolts *(selective 15u" Au for 9& 15P)
 T4S - without locking bolts *(Gold flash selective Sn)
 Standard: Quality class III
- ③ ④ T2A - with UNC screw of 5.8mm, NON-UL (Gold flash full gold)

Dimensions

| Positions | A | B | D | E |
|-----------|-------|-------|-------|-------|
| 9 | 30.81 | 24.99 | 16.33 | 11.08 |
| 15 | 39.20 | 33.30 | 24.70 | 19.39 |
| 25 | 53.05 | 47.04 | 38.40 | 33.24 |
| 37 | 69.40 | 63.50 | 54.80 | 49.86 |

ROHS compliant



| Scale | Free | ⑧ | Update the specification of T2A | 29.03.2022 | Daniel |
|------------------|-------|---|--|------------|--------|
| TOLERANCE | | ⑦ | Update the description of plating | 17.09.2021 | Daniel |
| X. | ±0.38 | ⑥ | Add UL logo | 27.02.2020 | Winnie |
| X.X | ±0.25 | ⑤ | Add insulator thickness, update tolerance and adjust profile | 18.02.2019 | Xavier |
| X.XX | ±0.13 | ④ | Add the specification: T2A | 13.06.2017 | Winnie |
| DIM | TOL | ③ | Add the plating specification 15u" Au | 05.03.2015 | Winnie |
| X.° | ±3° | | | | |
| X.X° | ±1.0° | | | | |
| Angle | TOL | | Modification | | |

| Date | Name | Customer-No. |
|------------|--------|--------------|
| 15.08.2012 | Lucas | |
| 29.03.2022 | Daniel | |

ASSMANN WSW-No.
 A-DX xx AKG-T2/T2S/T4/T4-2/T4S/T2A

Drawing-No.
ASS 4888 CO

Replace
 rev08
 Sheet 2/2



1

2

3

4

5

6

7

1

2

3

4

5

6

7

A

A

B

B

C

C

D

D

E

E

F

F

G

G

H

H