

This document is the property of Amphenol Corporation and is delivered on the express condition that it is not to be disclosed, reproduced or used, in whole or in part, for manufacture or sale by anyone other than Amphenol Corporation without its prior consent, and that no right is granted to disclose or to use any information in this document. The marking on this product doesn't contain environmental hazardous materials per Material Specification SS-00259 for Sony GP compliant or per directive 2011/65/EU for RoHS compliant.

SYMBOL		REVISIONS		DATE		APPROVED
SYM	ECN No.	DESCRIPTION	DATE	DATE	APPROVED	
A	NE-06194	RELEASE FOR ROHS	02/25/2006	07/06/2006	Amstrong Kao	
B	NE-06227	ADDING THE CRITICAL DIMENSION MARKS	07/31/2006	07/31/2006	Amstrong Kao	
C	NE-11005	CHANGED MATE. TIN PLATED ON CONTACT	01/12/2011	01/12/2011	Edward Wu	
D	NE-11034	DRAWING UPDATE	03/15/2011	03/15/2011	Arron Lin	
E	NE-11034	REDDEFINE COLORS	03/23/2011	03/23/2011	Arron Lin	
F	NE-11040	UPDATE MATERIAL OPTION	05/26/2011	05/26/2011	Arron Lin	
A1	NE-11074	MODIFY SHELL KINK DIMENSION	09/09/2011	09/09/2011	Arron Lin	
B1	NE-11124	MODIFY DRAWING	07/11/2014	07/11/2014	Arron Lin	
C1	NE-14131	ADDED 15u" GOLD OPTIONS	04/18/2016	04/18/2016	Arron Lin	
D1	NE-15137	ADD DIM & HAL 2.00 OPTION & D/C			Arron Lin	

NOTES:

- MATERIAL:**
HOUSING: HIGH TEMPERATURE THERMAL PLASTIC HTN (HALOGEN FREE),
BOTTOM COVER: HIGH TEMPERATURE THERMAL PLASTIC HTN, U94V-0, COLOR: OPTIONS.
TERMINAL: PHOSPHOR BRONZE.
SHELL: BRASS.
- FINISH:**
TERMINAL:
CONTACT AREA: SELECTED GOLD PLATING;
SOLDERING AREA: TIN PLATING 100 U" THICKNESS MIN.;
UNDER PLATING: NICKEL PLATING 50 U" THICKNESS MIN. OVERALL.
SHELL:
NICKEL PLATING 50 U" THICKNESS MIN. OVERALL.
- PACKING IS PER AMTA PACKING SPECIFICATION PKS-0001.**
- THIS PRODUCT DOESN'T CONTAIN ENVIRONMENTAL HAZARDOUS PER DIRECTIVE 2011/65/EU FOR ROHS COMPLIANT.**
- PRODUCT SPECIFICATION REFER TO : PS-7329**

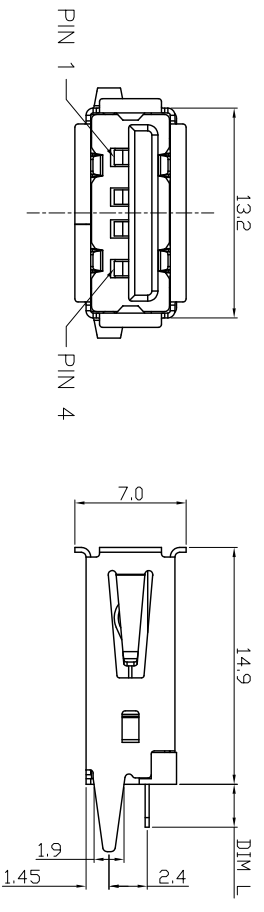
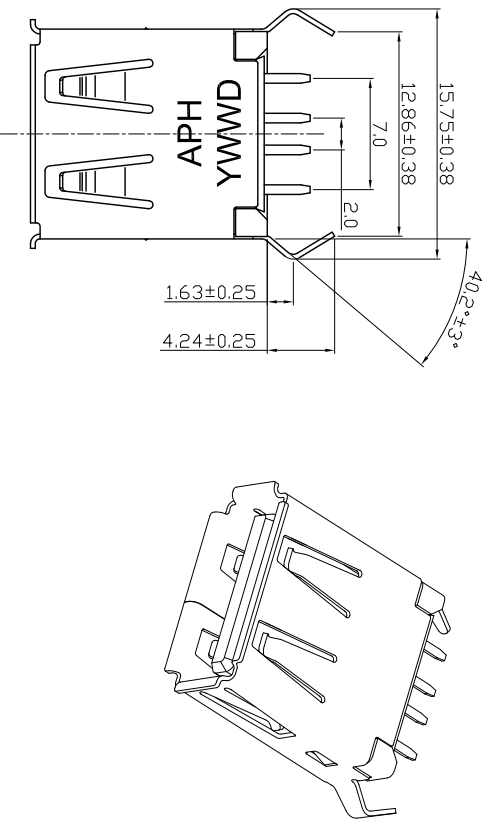

PART NO: GSB111XXKEU
CONTACT FINISH
1 : FLASH GOLD
2 : 30u" GOLD
5 : 15u" GOLD

COLOR / DIM L
0 : WORY / 2.7mm
1 : BLACK / 2.7mm
2 : WORY / 2.0mm
3 : BLACK / 2.0mm

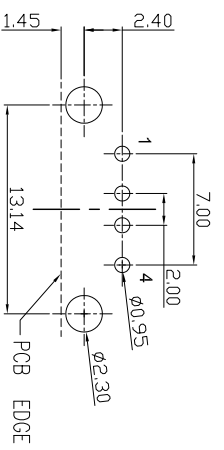

RECOMMENDED PCB LAYOUT TOP VIEW
PCB THICKNESS: 1.60±0.05mm
TOLERANCE: ±0.05mm

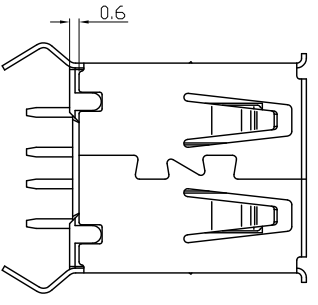

TOLERANCE	APPROVALS	DATE	TITLE	UNIT	SIZE	PART NO.
X, ±0.30 X.X, ±0.20 X.XX, ±0.10 X.XXX, ±0.10	DRAWN Debbie Hung	04/18/2016	UNIVERSAL SERIAL BUS RECEPTACLE, SERIES A STANDARD, STRAIGHT PCB MOUNT	mm	A3	GSB111XXKEU
ANGULAR ±1°	CHECKED Roger Tsai	04/18/2016		SCALE	1 OF 2	GSB111XXKEU
UNLESS OTHERWISE SPECIFIED	APPROVED Arron Lin	04/18/2016		NA		REV. D1
	CUST DWG	OTHER				

Amphenol
Amphenol Corporation
Amphenol Taiwan Corporation

This document is the property of Amphenol Corporation and is delivered on the express condition that it is not to be disclosed, reproduced or used, in whole or in part, for manufacture or sale by anyone other than Amphenol Corporation without its prior consent, and that no right is granted to disclose or to use any information in this document. The marking on this product doesn't contain environmental hazardous materials per Material Specification SS-00259 for Sony GP compliant or per directive 2011/65/EU for RoHS compliant.

29 PCS TRAY/CARTON

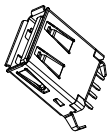
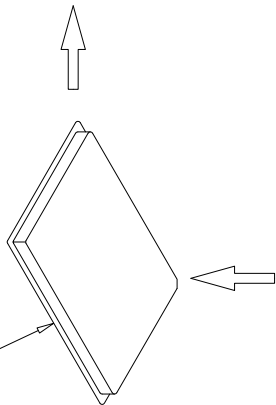
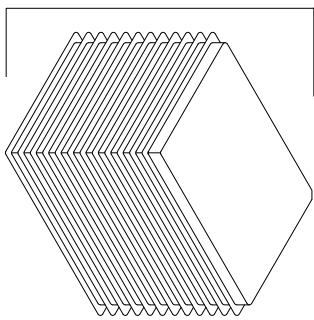

110 PCS/TRAY

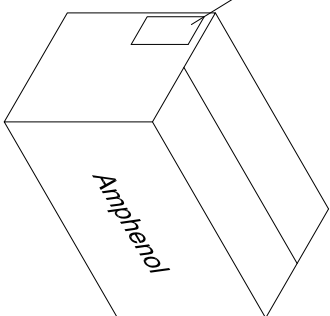
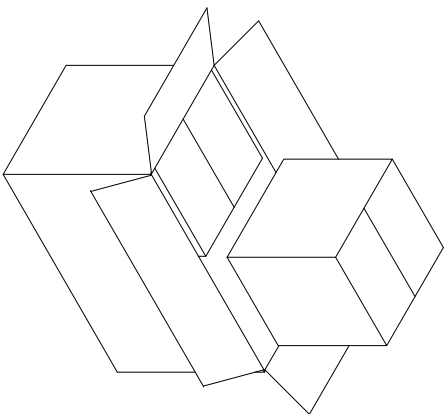
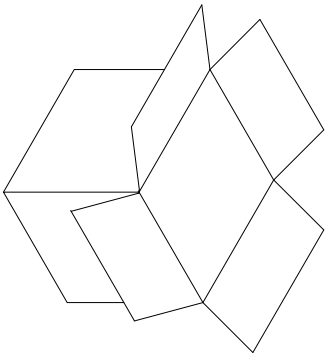

LABEL

- NOTES:
1. STAPLES SHOULD ONLY BE USED TO SET UP CARTON.
 2. ALL CARTON CLOSURES MUST BE DONE WITH TAPE.
 3. FILL PACKAGING TRAYS WITH THE QUANTITIES AS INDICATED IN THE CHART.
 4. SHIPPING CARTON DIMENSION: 520 X 273 X 310 MM.
 4. TRAY SIZE: 230mm X 220mm X 10 mm

REVISIONS				
SYM	ECN No.	DESCRIPTION	DATE	APPROVED
A	NE-06194	RELEASE FOR ROHS	02/23/2006	Amstrong Kao
B	NE-06227	ADDING THE CRITICAL DIMENSION MARKS	07/06/2006	Amstrong Kao
C	NE-11005	CHANGED MATTE TIN PLATED ON CONTACT DRAWING UPDATE	07/31/2006	Edward Wu
D	NE-11034	REDEFINE COLORS	03/15/2011	Arron Lin
E	NE-11034	REDEFINE COLORS	03/15/2011	Arron Lin
F	NE-11040	UPDATE MATERIAL OPTION	03/23/2011	Arron Lin
A1	NE-11074	MODIFY SHELL KINK DIMENSION	05/26/2011	Arron Lin
B1	NE-11124	MODIFY DRAWING	09/09/2011	Arron Lin
C1	NE-14131	ADDED 15u" GOLD OPTIONS	07/11/2014	Arron Lin
D1	NE-15137	ADD DIM & TAIL 2.00 OPTION & D/C	04/18/2016	Arron Lin

TOLERANCE

X.	±0.30	DRAWN	APPROVALS	DATE
X.X	±0.20	DEB	Deby Hung	04/18/2016
X.XX	±0.10	CHECKED	Roger Tsai	04/18/2016
X.XXX	±0.10	APPROVED	Arron Lin	04/18/2016
ANGULAR	±1°	DWG TYPE	CUST DWG	PROJECT CODE
UNLESS OTHERWISE SPECIFIED				OTHER

PACKAGING			
BY	G/W	N/W	PCS/ TRAY
TRAY	14.8	13.3	110
TRAY/CARTON			58
QUANTITY (PCS)	6380		GSB111XXKEU
PART NUMBER			GSB111XXKEU

USB , SERIES A UPRIGHT , RIGHT-ANGLE PCB MOUNT

Amphenol[®]

Amphenol Corporation
Amphenol Taiwan Corporation

UNIT	SCALE	SHEET	DWG NO.	REV.
mm	NA	2 OF 2	GSB111XXKEU	D1