

---

# 2SC4197

Silicon NPN Epitaxial

# HITACHI

---

## Application

UHF frequency converter, wide band amplifier

## Outline

MPAK

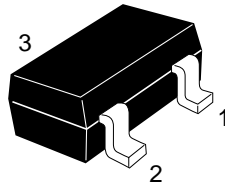

- 1. Emitter
- 2. Base
- 3. Collector

**Absolute Maximum Ratings** ( $T_a = 25^\circ\text{C}$ )

Item	Symbol	Ratings	Unit
Collector to base voltage	$V_{\text{CBO}}$	25	V
Collector to emitter voltage	$V_{\text{CEO}}$	13	V
Emitter to base voltage	$V_{\text{EBO}}$	3	V
Collector current	$I_{\text{C}}$	50	mA
Collector power dissipation	$P_{\text{C}}$	150	mW
Junction temperature	$T_{\text{j}}$	150	$^\circ\text{C}$
Storage temperature	$T_{\text{stg}}$	-55 to +150	$^\circ\text{C}$

**Electrical Characteristics** ( $T_a = 25^\circ\text{C}$ )

Item	Symbol	Min	Typ	Max	Unit	Test conditions
Collector to base breakdown voltage	$V_{(\text{BR})\text{CBO}}$	25	—	—	V	$I_{\text{C}} = 10 \mu\text{A}$ , $I_{\text{E}} = 0$
Collector cutoff current	$I_{\text{CBO}}$	—	—	0.1	$\mu\text{A}$	$V_{\text{CB}} = 15 \text{V}$ , $I_{\text{E}} = 0$
Collector cutoff current	$I_{\text{CEO}}$	—	—	10	$\mu\text{A}$	$V_{\text{CE}} = 13 \text{V}$ , $R_{\text{BE}} = \infty$
Emitter cutoff current	$I_{\text{EBO}}$	—	—	0.3	$\mu\text{A}$	$V_{\text{EB}} = 3 \text{V}$ , $I_{\text{C}} = 0$
Collector to emitter saturation voltage	$V_{\text{CE}(\text{sat})}$	—	—	0.3	V	$I_{\text{C}} = 20 \text{mA}$ , $I_{\text{B}} = 4 \text{mA}$
DC current transfer ratio	$h_{\text{FE}}$	50	—	180		$V_{\text{CE}} = 5 \text{V}$ , $I_{\text{C}} = 5 \text{mA}$
Collector output capacitance	$C_{\text{ob}}$	—	0.85	1.3	pF	$V_{\text{CB}} = 10 \text{V}$ , $I_{\text{E}} = 0$ , $f = 1\text{MHz}$
Gain bandwidth product	$f_{\text{T}}$	3.0	3.8	—	GHz	$V_{\text{CE}} = 5 \text{V}$ , $I_{\text{C}} = 20 \text{mA}$
Conversion gain	CG	—	19	—	dB	$V_{\text{CC}} = 5 \text{V}$ , $I_{\text{C}} = 0.8 \text{mA}$ , $f_{\text{in}} = 900 \text{MHz}$
Noise figure	NF	—	8	—	dB	$f_{\text{osc}} = 930 \text{MHz}$ (-5dBm), $f_{\text{out}} = 30 \text{MHz}$

Note: Marking is "TI-".

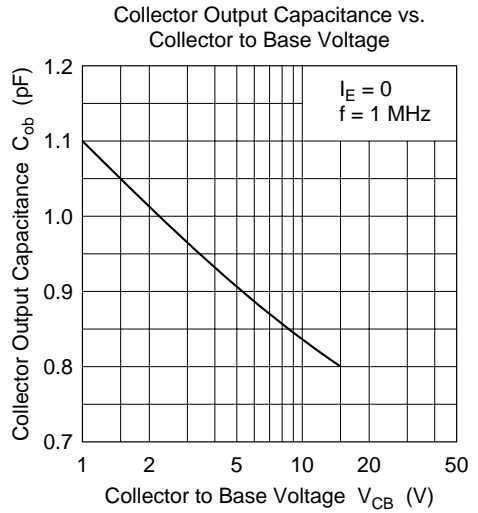
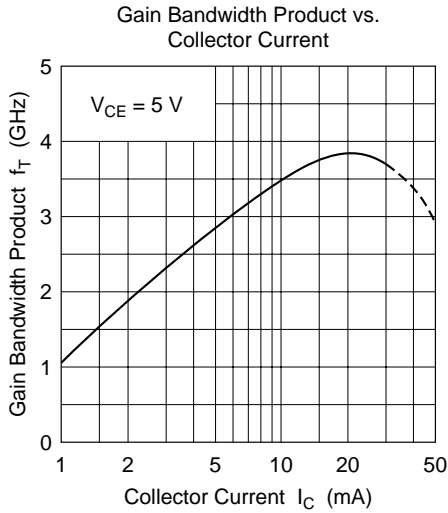
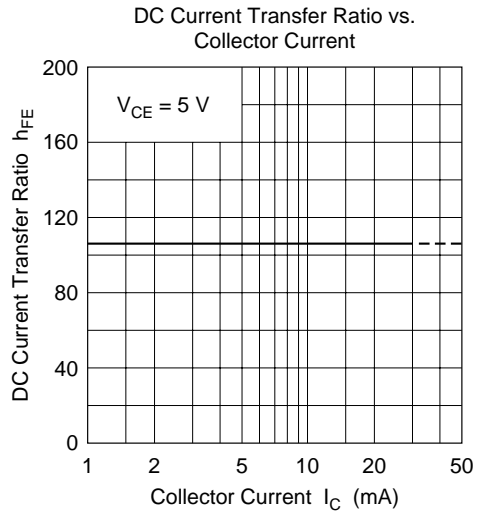
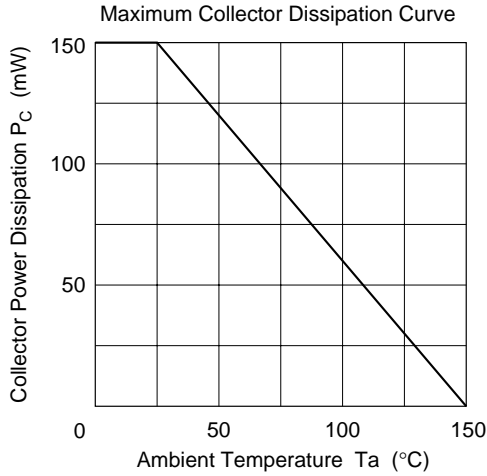

Conversion Gain, Noise Figure vs. Supply Voltage

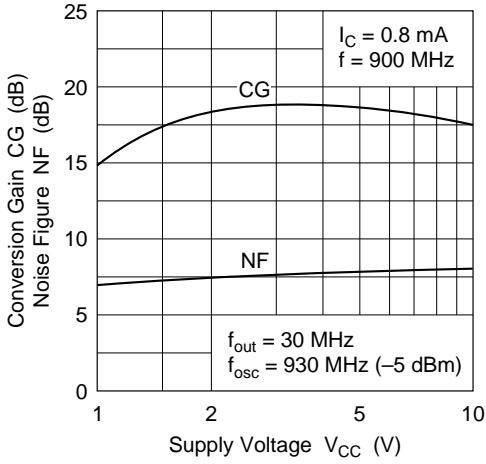

Conversion Gain, Noise Figure vs. Collector Current

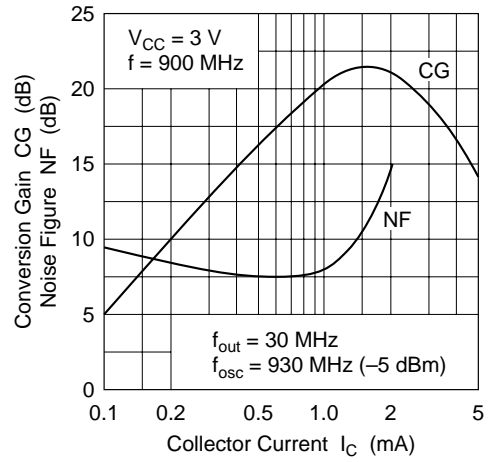

Conversion Gain, Noise Figure vs. Collector Current

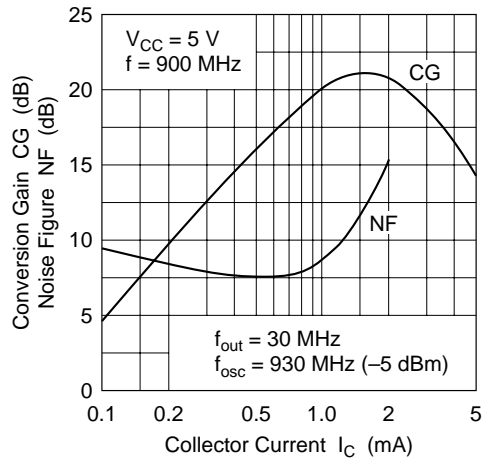

**S Parameters (Emitter Common)**

**Test Condition**  $V_{CE} = 5\text{ V}$ , 100 MHz to 1000 MHz (100 MHz Step),  $Z_0 = 50\ \Omega$

$I_C = 5\text{ mA}$  ● ——— ●

$I_C = 10\text{ mA}$  ▲ ——— ▲

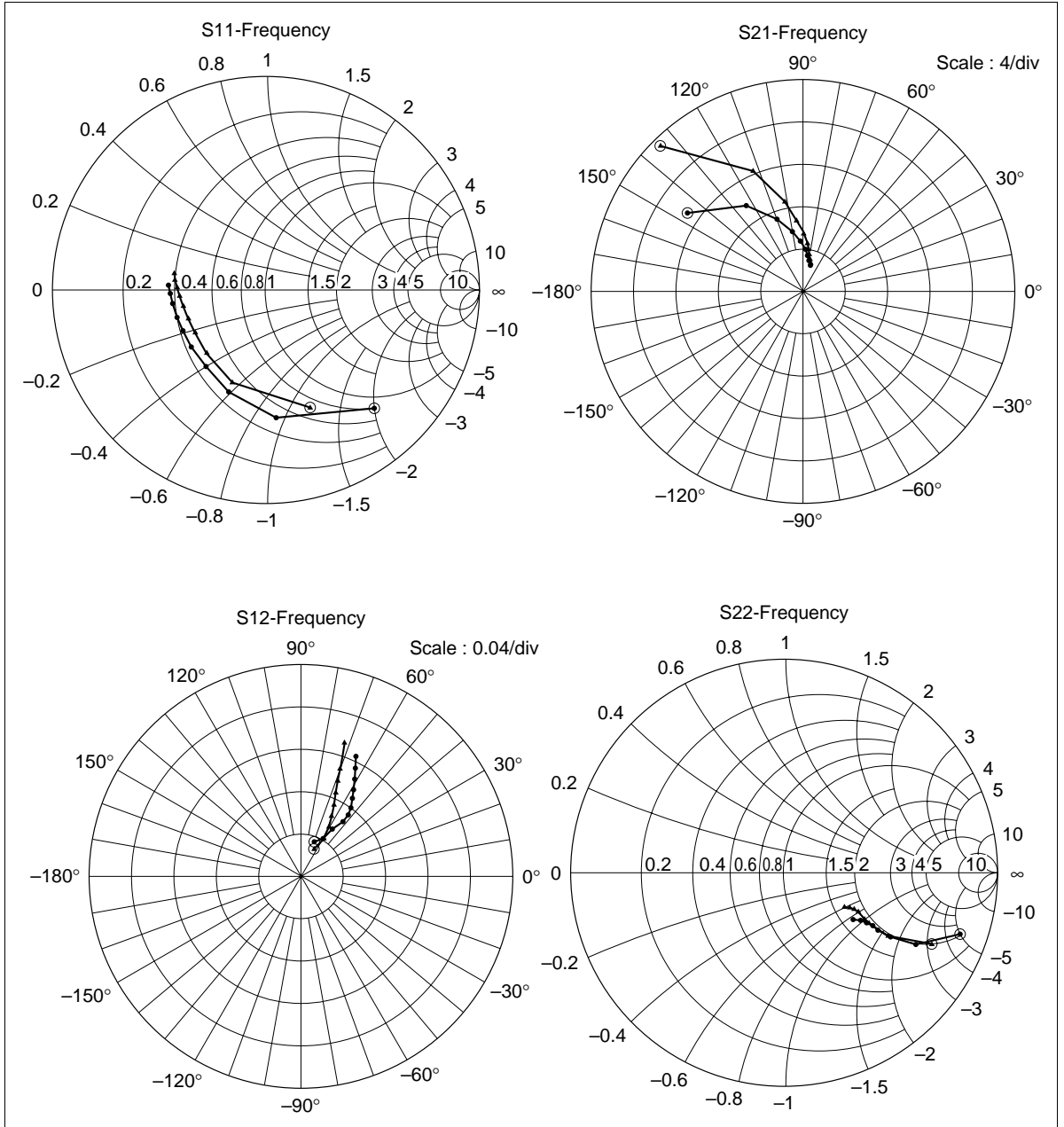

**S Parameters (Emitter Common)****Test Condition**  $V_{CE} = 5 \text{ V}$ ,  $I_C = 5 \text{ mA}$ ,  $Z_O = 50 \Omega$ 

Freq. (MHz)	S11		S21		S12		S22	
	MAG.	ANG.	MAG.	ANG.	MAG.	ANG.	MAG.	ANG.
100	0.744	-48.4	13.142	145.9	0.034	67.5	0.876	-19.1
200	0.599	-85.5	9.669	123.5	0.053	55.9	0.702	-28.2
300	0.506	-110.7	7.201	109.5	0.064	52.6	0.586	-30.9
400	0.457	-128.9	5.696	100.6	0.072	52.7	0.520	-31.2
500	0.440	-143.5	4.687	93.9	0.079	54.3	0.480	-31.2
600	0.430	-155.1	3.977	88.1	0.087	57.1	0.452	-31.5
700	0.437	-163.2	3.453	83.5	0.095	59.4	0.432	-31.7
800	0.441	-170.9	3.070	79.1	0.104	61.3	0.417	-32.4
900	0.452	-177.1	2.746	75.4	0.113	63.6	0.402	-33.4
1000	0.462	177.5	2.508	71.9	0.122	65.6	0.390	-34.5

**Test Condition**  $V_{CE} = 5 \text{ V}$ ,  $I_C = 10 \text{ mA}$ ,  $Z_O = 50 \Omega$ 

Freq. (MHz)	S11		S21		S12		S22	
	MAG.	ANG.	MAG.	ANG.	MAG.	ANG.	MAG.	ANG.
100	0.585	-69.3	19.233	134.4	0.028	63.8	0.768	-25.6
200	0.460	-110.1	12.238	112.6	0.041	58.1	0.564	-31.4
300	0.408	-133.9	8.571	101.3	0.052	60.0	0.468	-30.5
400	0.390	-149.7	6.608	94.5	0.062	62.9	0.420	-29.1
500	0.390	-160.7	5.348	88.7	0.073	65.3	0.394	-28.1
600	0.391	-169.8	4.503	84.4	0.084	67.7	0.375	-27.8
700	0.404	-176.7	3.884	80.3	0.095	69.1	0.361	-27.7
800	0.411	178.0	3.446	76.8	0.107	70.3	0.350	-28.2
900	0.426	173.1	3.069	73.4	0.119	71.5	0.339	-29.0
1000	0.436	169.8	2.803	70.7	0.131	72.2	0.330	-29.7

## Y Parameters (Emitter Common)

Test Condition  $V_{CE} = 5\text{ V}$ ,  $I_C = 5\text{ mA}$

Freq. (MHz)	Yie (mS)		Yfe (mS)		Yre (mS)		Yoe (mS)	
	REAL	IMAG.	REAL	IMAG.	REAL	IMAG.	REAL	IMAG.
100	2.663	5.357	161.804	-34.193	-0.002	-0.425	0.055	0.627
200	5.558	10.174	147.899	-63.499	-0.012	-0.880	0.025	1.270
300	9.651	13.450	125.634	-87.205	-0.041	-1.354	0.026	2.024
400	14.160	15.066	102.261	-102.289	-0.093	-1.820	0.044	2.772
500	18.753	15.624	80.041	-110.827	-0.150	-2.309	0.048	3.510
600	23.019	14.727	57.826	-114.923	-0.214	-2.798	0.124	4.301
700	26.444	13.908	40.437	-113.783	-0.263	-3.305	0.211	4.964
800	29.378	12.040	24.049	-111.316	-0.379	-3.822	0.268	5.828
900	31.931	9.960	10.602	-106.726	-0.466	-4.371	0.407	6.578
1000	33.671	7.667	-0.922	-101.485	-0.586	-4.913	0.524	7.381

Test Condition  $V_{CE} = 5\text{ V}$ ,  $I_C = 10\text{ mA}$

Freq. (MHz)	Yie (mS)		Yfe (mS)		Yre (mS)		Yoe (mS)	
	REAL	IMAG.	REAL	IMAG.	REAL	IMAG.	REAL	IMAG.
100	5.212	6.660	273.909	-97.915	-0.002	-0.430	0.029	0.527
200	10.124	10.767	208.225	-154.453	-0.015	-0.876	0.011	1.307
300	15.094	11.730	141.558	-172.198	-0.044	-1.347	0.047	2.035
400	18.933	10.991	93.174	-169.490	-0.089	-1.817	0.064	2.735
500	21.811	10.074	58.181	-158.809	-0.133	-2.299	0.096	3.501
600	23.927	8.389	32.829	-146.284	-0.195	-2.785	0.173	4.226
700	25.848	7.170	15.188	-134.592	-0.276	-3.302	0.224	5.010
800	26.851	5.955	2.733	-123.322	-0.353	-3.808	0.282	5.760
900	28.097	4.633	-7.642	-113.209	-0.443	-4.375	0.394	6.551
1000	28.686	3.829	-13.979	-104.651	-0.523	-4.908	0.466	7.215

Conversion Gain and Noise Figure Test Circuit

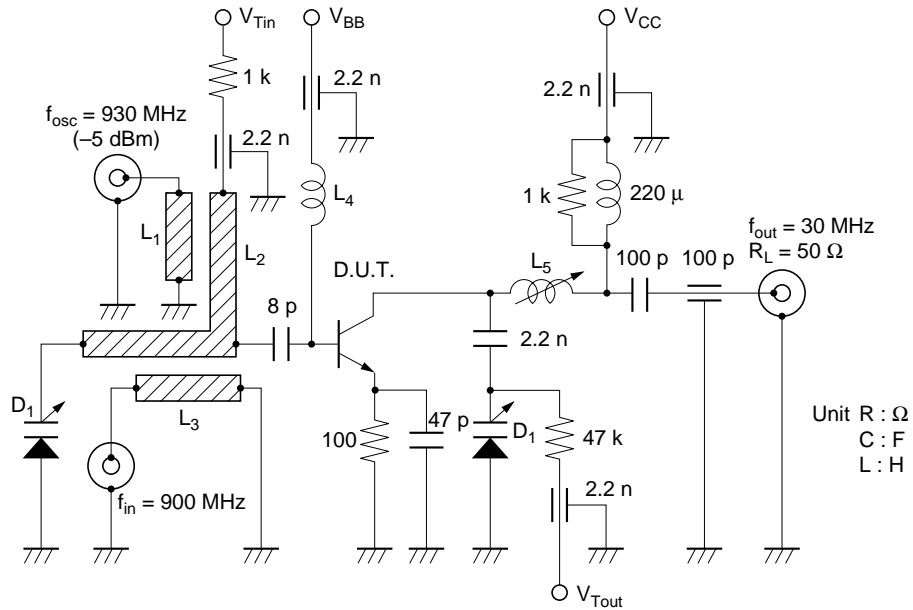

Unit R : Ω  
C : F  
L : H

D<sub>1</sub> : 1 SV 188

L<sub>1</sub> : φ 1 mm Enameled Copper Wire.

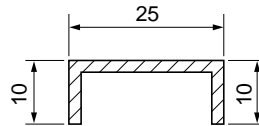

L<sub>2</sub> : φ 1 mm Enameled Copper Wire.

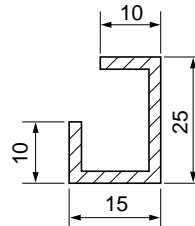

L<sub>3</sub> : φ 1 mm Enameled Copper Wire.

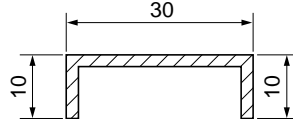

Unit : mm

L<sub>4</sub> : φ 0.5 mm Enameled Copper Wire 1 Turn Inside Dia 3 mm

L<sub>5</sub> : Inside Dia 5 mm Bobin, φ 0.2 mm Enameled Copper Wire 20 Turns with Ferrite Core.



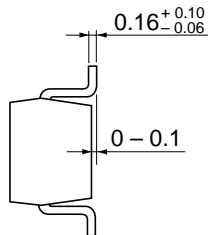
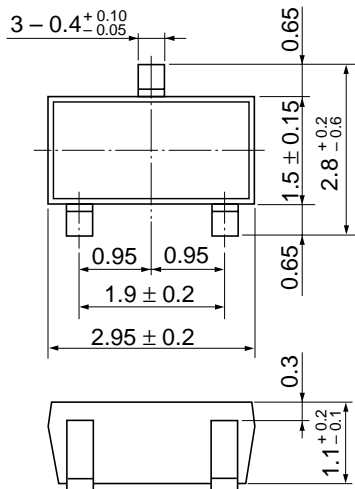

Hitachi Code	MPAK
JEDEC	—
EIAJ	Conforms
Weight (reference value)	0.011 g

## Cautions

1. Hitachi neither warrants nor grants licenses of any rights of Hitachi's or any third party's patent, copyright, trademark, or other intellectual property rights for information contained in this document. Hitachi bears no responsibility for problems that may arise with third party's rights, including intellectual property rights, in connection with use of the information contained in this document.
2. Products and product specifications may be subject to change without notice. Confirm that you have received the latest product standards or specifications before final design, purchase or use.
3. Hitachi makes every attempt to ensure that its products are of high quality and reliability. However, contact Hitachi's sales office before using the product in an application that demands especially high quality and reliability or where its failure or malfunction may directly threaten human life or cause risk of bodily injury, such as aerospace, aeronautics, nuclear power, combustion control, transportation, traffic, safety equipment or medical equipment for life support.
4. Design your application so that the product is used within the ranges guaranteed by Hitachi particularly for maximum rating, operating supply voltage range, heat radiation characteristics, installation conditions and other characteristics. Hitachi bears no responsibility for failure or damage when used beyond the guaranteed ranges. Even within the guaranteed ranges, consider normally foreseeable failure rates or failure modes in semiconductor devices and employ systemic measures such as fail-safes, so that the equipment incorporating Hitachi product does not cause bodily injury, fire or other consequential damage due to operation of the Hitachi product.
5. This product is not designed to be radiation resistant.
6. No one is permitted to reproduce or duplicate, in any form, the whole or part of this document without written approval from Hitachi.
7. Contact Hitachi's sales office for any questions regarding this document or Hitachi semiconductor products.

# HITACHI

## Hitachi, Ltd.

Semiconductor & Integrated Circuits.  
Nippon Bldg., 2-6-2, Ohte-machi, Chiyoda-ku, Tokyo 100-0004, Japan  
Tel: Tokyo (03) 3270-2111 Fax: (03) 3270-5109

URL      North America      : <http://semiconductor.hitachi.com/>  
             Europe                 : <http://www.hitachi-eu.com/hel/ecg>  
             Asia (Singapore)      : <http://www.has.hitachi.com.sg/grp3/sicd/index.htm>  
             Asia (Taiwan)            : [http://www.hitachi.com.tw/E/Product/SICD\\_Frame.htm](http://www.hitachi.com.tw/E/Product/SICD_Frame.htm)  
             Asia (HongKong)        : <http://www.hitachi.com.hk/eng/bo/grp3/index.htm>  
             Japan                        : <http://www.hitachi.co.jp/Sicd/indx.htm>

## For further information write to:

Hitachi Semiconductor  
(America) Inc.  
179 East Tasman Drive,  
San Jose, CA 95134  
Tel: <1> (408) 433-1990  
Fax: <1> (408) 433-0223

Hitachi Europe GmbH  
Electronic components Group  
Dornacher Straße 3  
D-85622 Feldkirchen, Munich  
Germany  
Tel: <49> (89) 9 9180-0  
Fax: <49> (89) 9 29 30 00

Hitachi Europe Ltd.  
Electronic Components Group.  
Whitebrook Park  
Lower Cookham Road  
Maidenhead  
Berkshire SL6 8YA, United Kingdom  
Tel: <44> (1628) 585000  
Fax: <44> (1628) 778322

Hitachi Asia Pte. Ltd.  
16 Collyer Quay #20-00  
Hitachi Tower  
Singapore 049318  
Tel: 535-2100  
Fax: 535-1533

Hitachi Asia Ltd.  
Taipei Branch Office  
3F, Hung Kuo Building, No.167,  
Tun-Hwa North Road, Taipei (105)  
Tel: <886> (2) 2718-3666  
Fax: <886> (2) 2718-8180

Hitachi Asia (Hong Kong) Ltd.  
Group III (Electronic Components)  
7/F., North Tower, World Finance Centre,  
Harbour City, Canton Road, Tsim Sha Tsui,  
Kowloon, Hong Kong  
Tel: <852> (2) 735 9218  
Fax: <852> (2) 730 0281  
Telex: 40815 HITEC HX

Copyright ' Hitachi, Ltd., 1999. All rights reserved. Printed in Japan.

**HITACHI**