

In case of consideration for using Automotive equipment / device which demand high reliability, kindly contact our sales window correspondents.

- ⚠ 【 ASSEMBLE TOOL 】
- ① Jig for soldering outer conductor: SMP-J/SO-MD1
 - ② Jig for soldering center conductor: SMP-J/SO-MD2
 - ③ Attachment for inspection of dimension for mating area: SMP-J/IN-MD
 - ④ Base for inspection of dimension for mating area: SMP/IN-MD-BASE

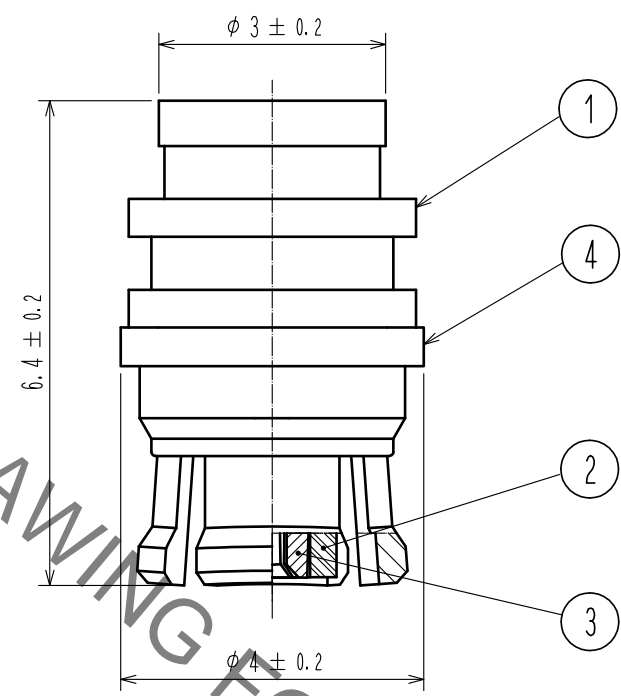

【 USAGE PRECAUTIONS 】

1. Please insert or extract a SMP jack as perpendicularly as possible to a receptacle. If aligned insertion or extraction is not performed, it could damage or deform an outer conductor part of the jack.
Recommend using an extraction jig for the jack
2. Semi-flexible cable is made solder connection with a connector. If excess load on the soldered section is applied, it could damage or deform the section.
Please handle it with care.

2	PTFE		4	BRASS	GOLD PLATING			
1	BERYLIIUM COPPER	GOLD PLATING	3	BERYLIIUM COPPER	GOLD PLATING			
NO.	MATERIAL	FINISH .	REMARKS	NO.	MATERIAL	FINISH .	REMARKS	
UNITS mm		SCALE 10 : 1	COUNT ⚠ 1	DESCRIPTION OF REVISIONS DIS-D-00005251		DESIGNED TM. YOSHIDA	CHECKED TO. KATAYAMA	DATE 20200918
HIROSE ELECTRIC CO., LTD.		APPROVED : TO. KATAYAMA 20171101		DRAWING NO. EDC-373427-00-00				
		CHECKED : KY. SHIMIZU 20171101		PART NO. SMP-J-SF085				
		DESIGNED : TM. YOSHIDA 20171101		CODE NO. CL338-1100-0-00				
		DRAWN : TM. YOSHIDA 20171101		1/1				