

# 513 Quick-Acting Miniature Fuse

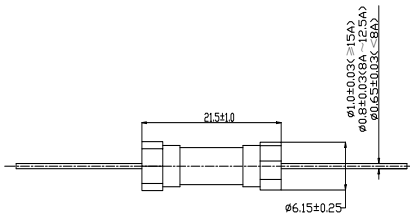

Dimensions (unit: mm)

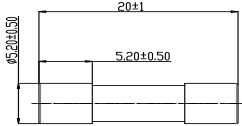

## Main Characteristics

Axial miniature fuse; Quick-Acting Standard

UL248-14

## Materials

Tube: Ceramic Tube  
End Caps: Silver plated copper

## Operating Temperature

-55°C to +125°C

## Storage Conditions

+10°C to +60°C  
Relative humidity: ≤75% yearly average  
Without dew, maximum 30 days at 95%

## Vibration Resistance

24 cycles at 15 min. each (60068-6)  
10-60Hz at 0.75mm amplitude  
60-2000Hz at 10g acceleration

## Soldering Parameters

260°C. ≤5 sec (Wave Soldering)  
350°C. ≤3 sec (Hand Soldering)  
Soldering Peak:  
260°C. 10 sec. (IEC 60068-20)

## Average Time Current(I-T Curve)

Average Current Curve(I-T Curve)

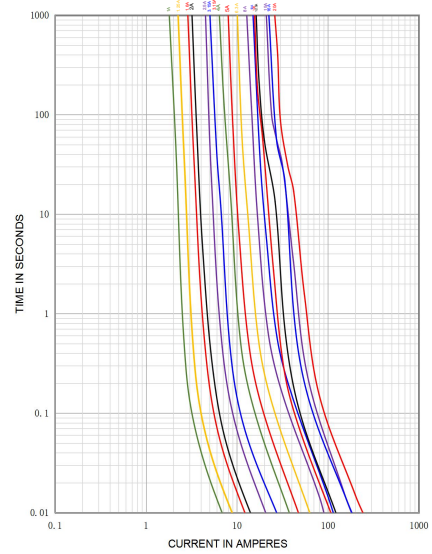

## Time vs Current Characteristics: UL 248-14

Rated Current	100%	210%	275%	400%	1000%
0.2A~20A	>1h	<30min	40ms~20s	10ms~1s	≤30ms



## Electrical Characteristics at 25°C

Amp Code	Rated Current	Max. Voltage	Nominal Melting Pt (A²sec)	Breaking Capacity	Approvals
0200	200mA	300V	/	1000A@300V DC 1500A@300V AC	•
0250	250mA		/		•
0315	315mA		/		•
0400	400mA		/		•
0500	500mA		/		•
0630	630mA		/		•
0750	750mA		/		•
0800	800mA		/		•
1100	1.00A		0.4		•
1125	1.25A		0.69		•
1160	1.60A		1.31		•
1200	2.00A		1.72		•
1250	2.50A		3.88		•
1315	3.15A		7.14		•
1400	4.00A		13.55		•
1500	5.00A		21.63		•
1630	6.30A		39.69		•
1800	8.00A		93.87		•
2100	10.00A		138		•
2120	12.00A		110.88		•
2125	12.50A		154.69		•
2150	15.00A		333		•
2160	16.00A	345.6	•		
2200	20.00A	620	750A@300V AC	•	

**Notes:** (1) Permissible continuous operating current is ≤100% at ambient temperature of 23°C (73.4°F)  
(2) Typical pre-arcing I<sub>2t</sub> are measured at 10I<sub>n</sub> current.

## Ordering Information

Series	Amp Code	Supplementary Code	Qty
513			

