

RECOMMENDED LAND PATTERN DIMENSION OF PCB

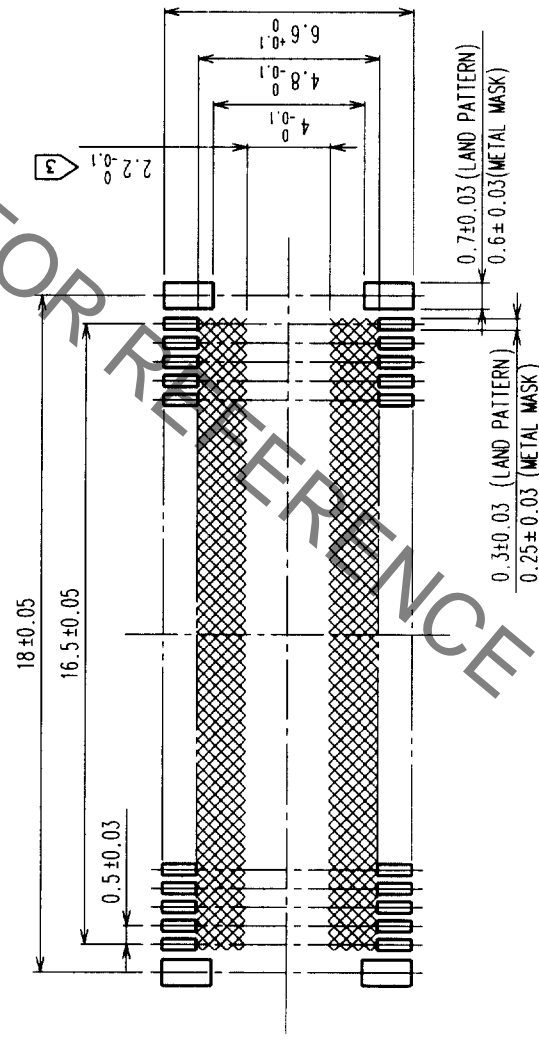

- NOTES
- 1 SMT LEAD-COPLANARITY: 0.1 MAX.
 - 2 THIS PRODUCT HAS NO POLARITY TO PATTERN FOR MOUNTING.
 - 3 MAKE SURE WIDTH OF PATTERN IS WITHIN THAT OF LAND, OR LEAD MAY TOUCH PATTERN. (THIS APPLIES TO HATCHED AREA.)
 - 4 TO BE EMBOSSED CARRIER TAPED AS SPECIFIED IN SHEET 2.

HRS DRAWING FOR REFERENCE

| COUNT | DESCRIPTION OF REVISIONS | BY | CHKD | DATE | COUNT | DESCRIPTION OF REVISIONS | BY | CHKD | DATE |
|-------|--------------------------|----|------|------|-------|--------------------------|----|------|------|
| △ | | | | | △ | | | | |
| △ | | | | | △ | | | | |
| △ | | | | | △ | | | | |

| | | | | |
|----------------|--|--------------------|--|---------|
| 2 | | PHOSPHOR BRONZE | CONTACT AREA: GOLD (0.1μm) OVER NICKEL | |
| 1 | | LCP | LEAD: GOLD FLASH OVER NICKEL | |
| NO. 1 | | MATERIAL | BEIGE | UL94V-0 |
| CODE NO. (OLD) | | FINISH, REMARKS | DRAWN | |
| CL | | | DESIGNED | |
| | | | CHECKED | |
| | | | MATERIAL | |
| | | | NO. | |
| | | | 3 | |
| | | | PHOSPHOR BRONZE | |
| | | | TIN PLATED | |
| | | | FINISH, REMARKS | |
| | | | APPROVED | |
| | | | RELEASED | |
| | | | 99.10.25 | |
| | | | 99.10.26 | |
| | | | 99.10.26 | |
| | | | 99.10.26 | |
| DRAWING NO. | | PART NO. | | |
| EDC3-152120-01 | | FX11LB-68S-SV (21) | | |
| SCALE | | CODE NO. | | |
| 5 : 1 | | CL573-0152-0-21 | | |
| UNITS | | mm | | |

| | |
|-----|--|
| TO | |
| PCK | |

REELED DIMENSION (Free)

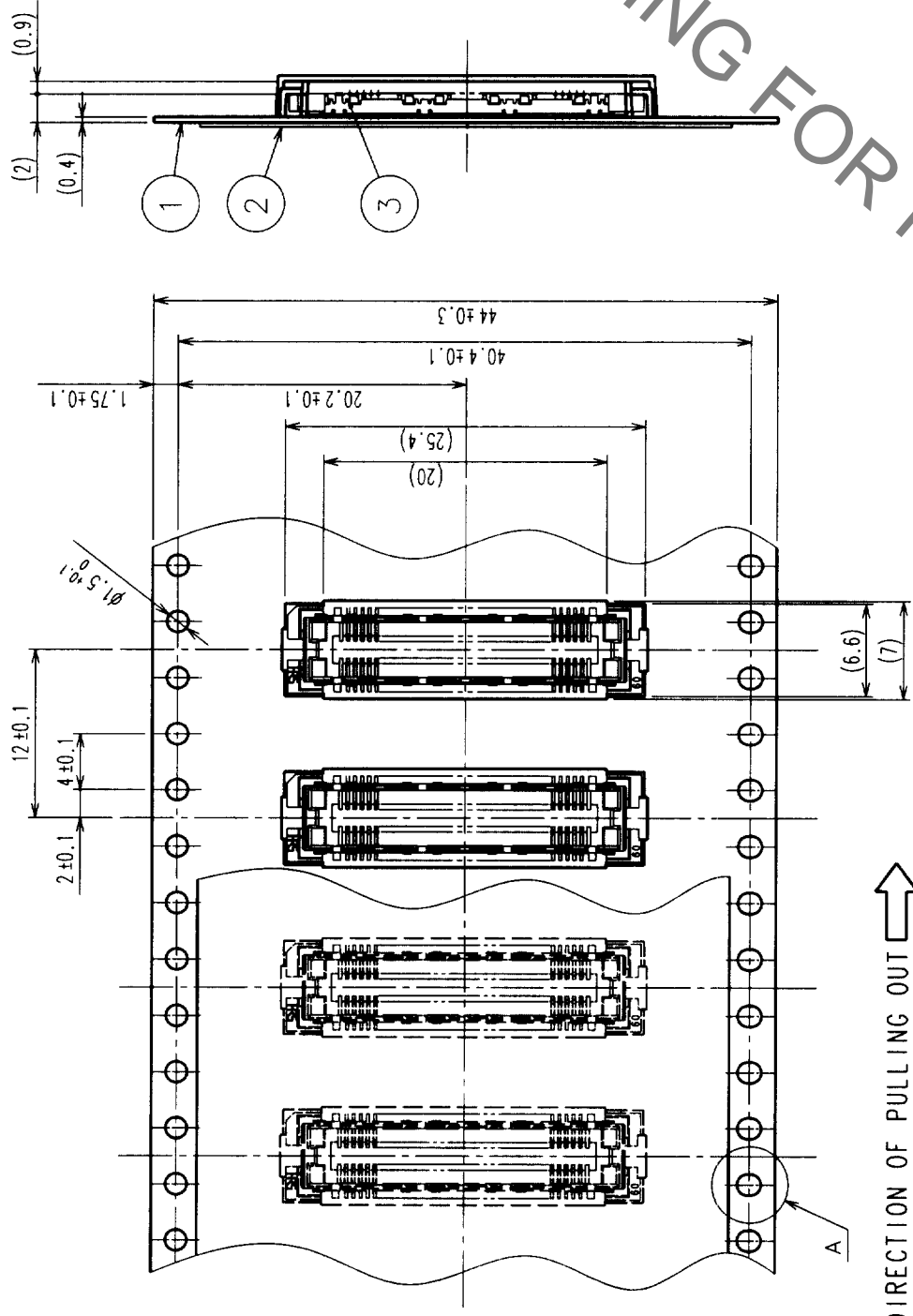

THE DIRECTION OF PULLING OUT →

A (5:1)

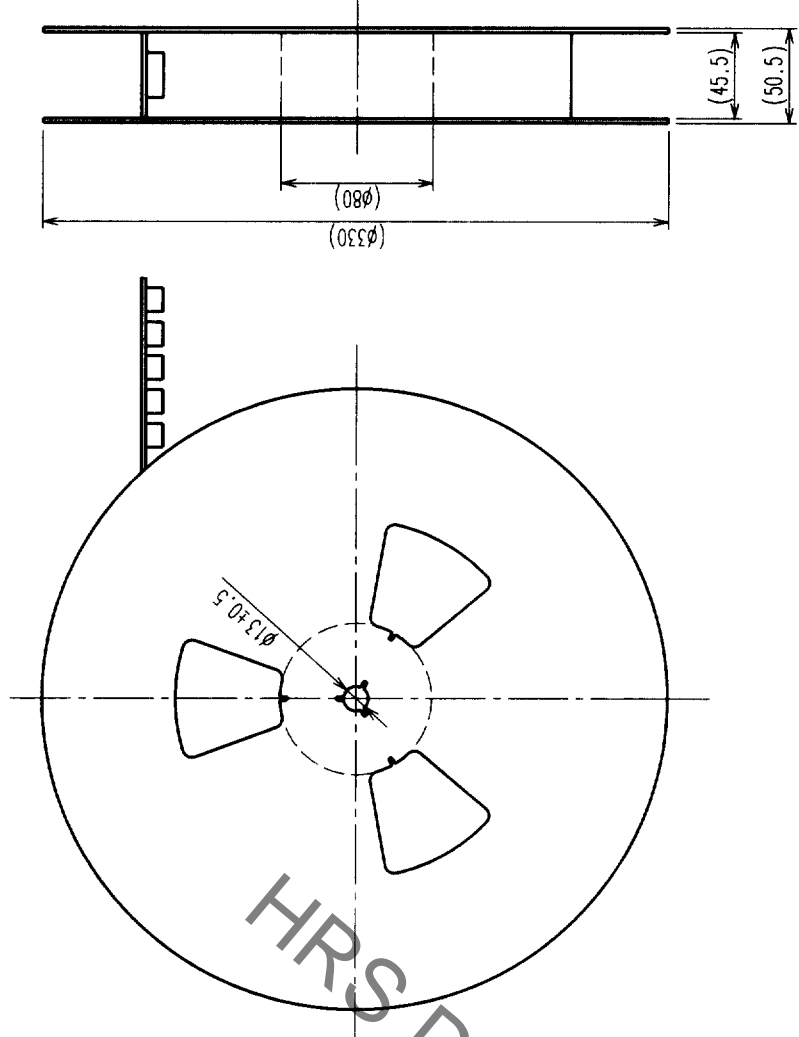
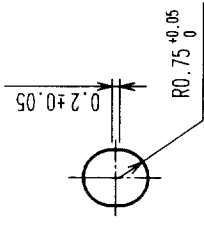

- NOTES
- 1 REEL: 1000 CONNECTORS.
 - 2 MINIMUM 10 COMPARTMENTS FROM BOTH REEL ENDS REMAIN EMPTY.
 - 3 THIS PRODUCT HAS NO POLARITY TO TAPE AND REEL PACKAGING.

| COUNT | DESCRIPTION OF REVISIONS | BY | CHKD | DATE | COUNT | DESCRIPTION OF REVISIONS | BY | CHKD | DATE |
|-------|--------------------------|----|------|------|-------|--------------------------|----|------|------|
| △ | | | | | △ | | | | |
| △ | | | | | △ | | | | |
| △ | | | | | △ | | | | |

| 2 | PET | TOP COVER TAPE | 3 | (CONNECTOR) | FINISH, REMARKS | FINISH, REMARKS | APPROVED | RELEASED |
|---------------------|----------|--------------------------|-----|-------------------|-----------------|-----------------|----------|----------|
| 1 | PS | EMBOSSED CARRIER TAPE | 3 | | | | | |
| NO. | MATERIAL | FINISH, REMARKS | NO. | MATERIAL | DESIGNED | CHECKED | APPROVED | RELEASED |
| CODE NO. (OLD) | CL | | | | | | | |
| DRAWING FOR PACKING | | DRAWING NO. | | PART NO. | | | | |
| | | EDC3-152120-01 | | FX11LB-68S-SV(21) | | | | |
| SCALE | 2 : 1 | | | | | | | |
| UNITS | mm | | | | | | | |
| | | HIROSE ELECTRIC CO., LTD | | CODE NO. | | CL573-0152-0-21 | | |

| | |
|-----|--|
| TO | |
| PCK | |