

Rev	AWO #	Description	Date	Appr
-		RELEASED	11/25/10	

APPROVED: \_\_\_\_\_  
 DATE: \_\_\_\_\_ TITLE: \_\_\_\_\_

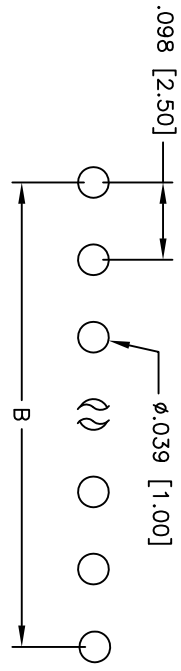

RECOMMENDED PCB LAYOUT

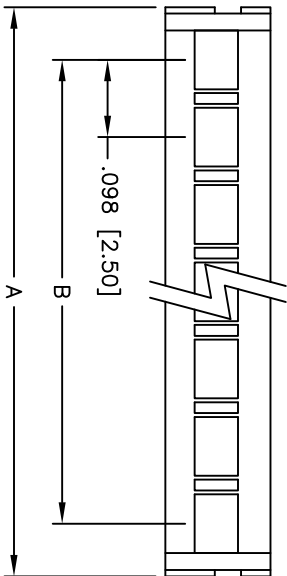
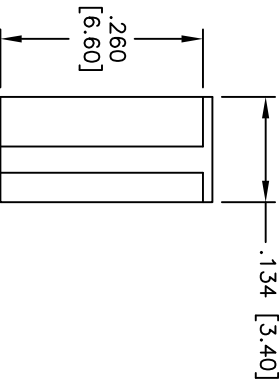
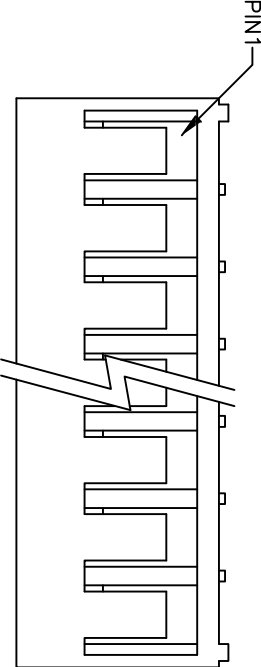

Positions: 2 thru 16  
 A = .098 [2.50] x No. of Spaces + .134 [3.40]  
 B = .098 [2.50] x No. of Spaces

**SPECIFICATIONS:**

- Material: Nylon 66, rated UL 94V-0
- Insulator color: White
- Contacts: Brass
- Plating: Tin over Copper underplate overall
- Electrical: Operating voltage: 250V AC, DC; Current rating: 3A AC, DC; Insulation resistance: 1,000 Mohms min; Dielectric withstanding voltage: 800 VAC for 1 minute
- Temperature Rating: Operating temperature: -25°C to +85°C
- Environmental: Lead free, RoHS compliant
- Recommended soldering temp: 235°C for 5 seconds



**ADAM TECH**

909 Railway Avenue, Union, NJ 07083  
 Phone: 908-687-5000 Fax: 908-687-5710

TITLE: .098 [2.50] SHROUDED CRIMP TERMINAL HOUSING

UNLESS OTHERWISE SPECIFIED ALL DIMENSIONS ARE INCHES [MM]	
TOLERANCES: EXCEPT AS NOTED	
INCHES	HOLDS
.X ± .10	ØXX ± .10
.XX ± .020	ØXXX ± .015
.XXX ± .015	ØXXX ± .010
APPROVALS	DATE
DRAWN DY	11/25/10
CHECKED	
APPROVED	

SIZE X	PART NO. 25CH-G-XX	REV. -
REF: S00123T	SCALE: NTS	SHEET 1 OF 1