

VOLTAGE RANGE: 20 KV
CURRENT: 3.0 A

Features

- Diffused Junction
- High Voltage Capability
- High Case Dielectric Strength
- High frequency
- Plastic Material has Underwriters Laboratory
- Flammability Classification 94V-0

Mechanical Data

- Case: Molded Plastic
- Polarity: Marked on Body
- Weight: 83 grams (approx.)
- Mounting Position: Through Hole for #5 Screw
- Marking: Type Number



Outline Drawings

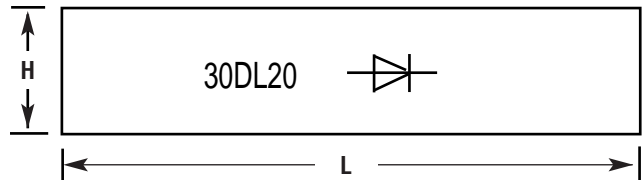
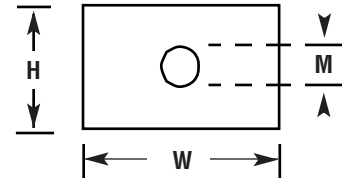

Shape Size(Unit: mm)			
L	W	H	M
120	25	19	5

Maximum Ratings and Electrical Characteristics T_A = 25°C unless otherwise specified

Characteristic	Symbols	30DL20	Units
Repetitive Peak Reverse Voltage	V _{RRM}	20	kV
Average Output Current Ta=30°C, Resistive Load	I _O	3.0	A
Suege Current	I _{FSM}	90	A
Maximum Forward Voltage Drop at 25°C, I _F = I _{F(AV)}	V _F	25	V
Maximum Reverse Current at 25°C	V _{RRM}	10	uA
at 100°C		100	uA
Maximum Reverse Recovery Time at 25°C I _F =100mA I _{RM} =200mA	T _{rr}	100	nS
Junction Capacitance at 25°C, V _R =0V, f=1MHz	C _j	--	pF
Junction Temperature	T _j	125	°C
Allowable Operation Case Temperature	T _C	125	°C
Storage Temperature	T _{stg}	-40 to +125	°C