

FRD Type : KCF60A40E

OUTLINE DRAWING

FEATURES

- * Similar to TO-247AC (TO-3P) x 2 Case
- * Dual Diodes – Cathode Common
- * Ultra – Fast Recovery
- * Low Forward Voltage Drop
- * High Surge Capability
- * 200 Volts thru 600 Volts Types Available

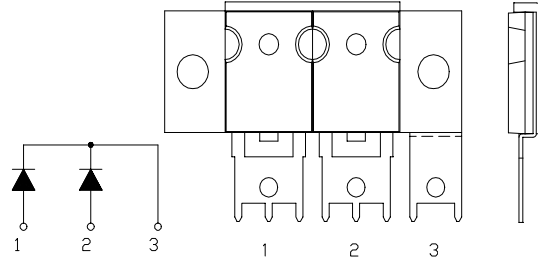

Maximum Ratings

Approx Net Weight:30g

Rating		Symbol	KCF60A40E		Unit
Repetitive Peak Reverse Voltage		V_{RRM}	400		V
Average Rectified Output Current		I_O	60	$T_C=77^\circ\text{C}$ 50 Hz, Full Sine Wave Resistive Load	A
RMS Forward Current		$I_{F(RMS)}$	66.6		A
Surge Forward Current		I_{FSM}	400	50 Hz Full Sine Wave, 1 cycle Non-repetitive	A
Operating Junction Temperature Range		T_{jw}	- 40 to + 150		$^\circ\text{C}$
Storage Temperature Range		T_{stg}	- 40 to + 150		$^\circ\text{C}$
Mounting torque	Anode Cathode Terminal	F_{tor}	0.5	Recommended value	N·m
	Cathode Base		2.4		

Electrical • Thermal Characteristics

Characteristics	Symbol	Conditions	Min.	Typ.	Max.	Unit
Peak Reverse Current	I_{RM}	$T_j=25^\circ\text{C}, V_{RM}=V_{RRM}$ per Arm	-	-	50	μA
Peak Forward Voltage	V_{FM}	$T_j=25^\circ\text{C}, I_{FM}=30\text{A}$ per Arm	-	-	1.25	V
Reverse Recovery Time	t_{rr}	$I_{FM}=10\text{A}$, $-di/dt=50\text{A}/\mu\text{s}$, $T_a=25^\circ\text{C}$	-	-	60	ns
Thermal Resistance	$R_{th(j-c)}$	Junction to Case	-	-	0.85	$^\circ\text{C}/\text{W}$

KCF60A40E OUTLINE DRAWING (Dimensions in mm)

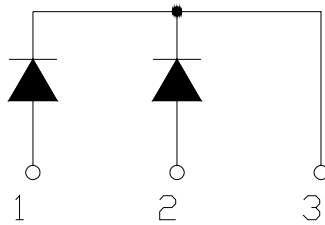
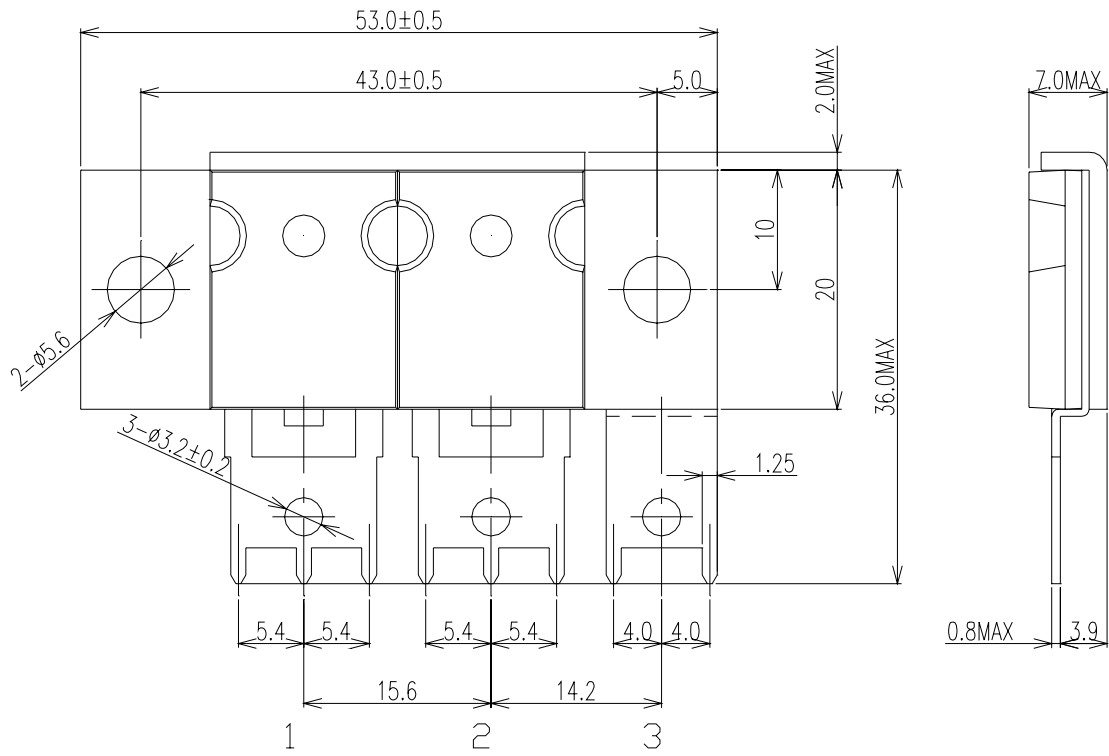

FORWARD CURRENT VS. VOLTAGE

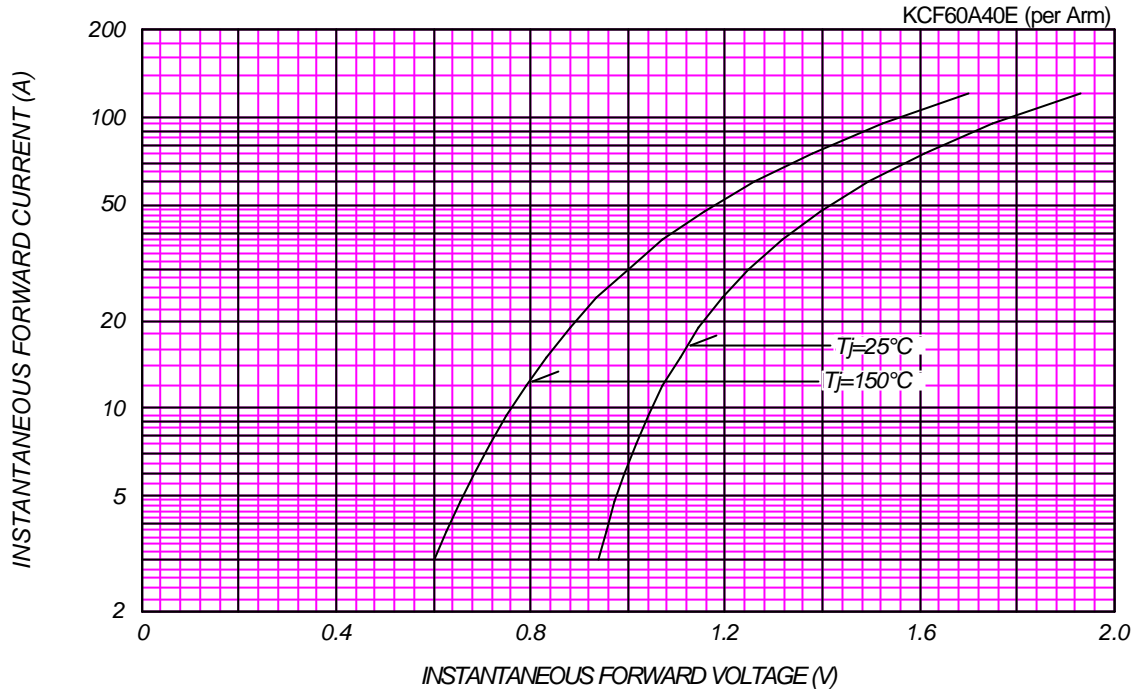

AVERAGE FORWARD POWER DISSIPATION

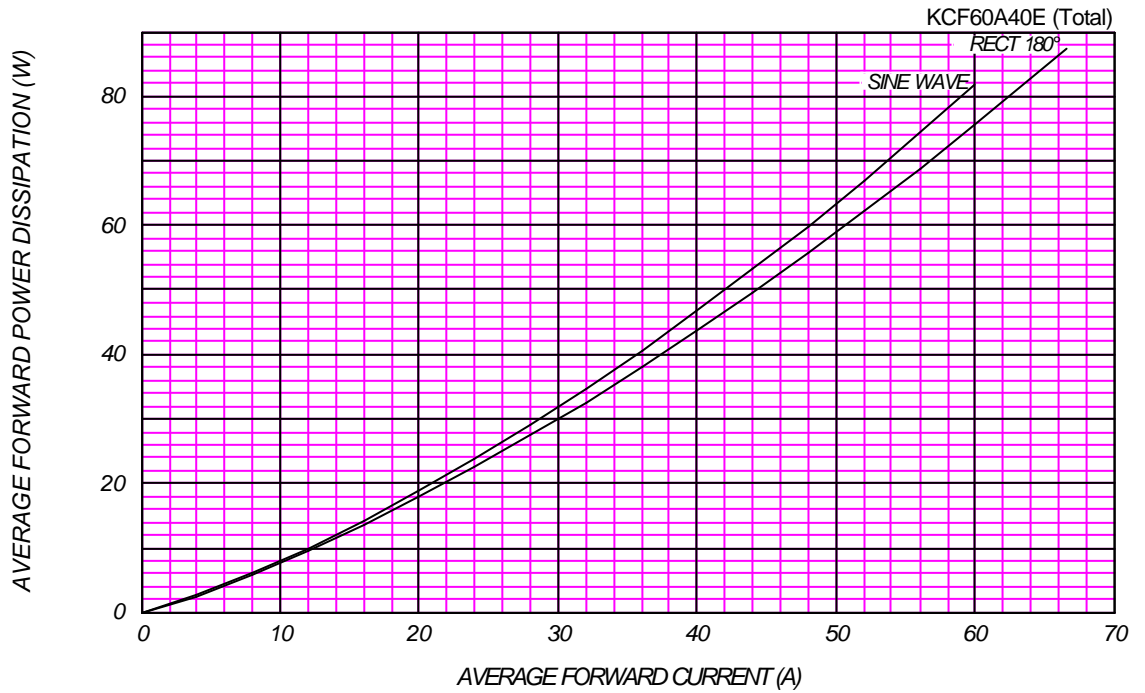



AVERAGE FORWARD CURRENT VS. CASE TEMPERATURE

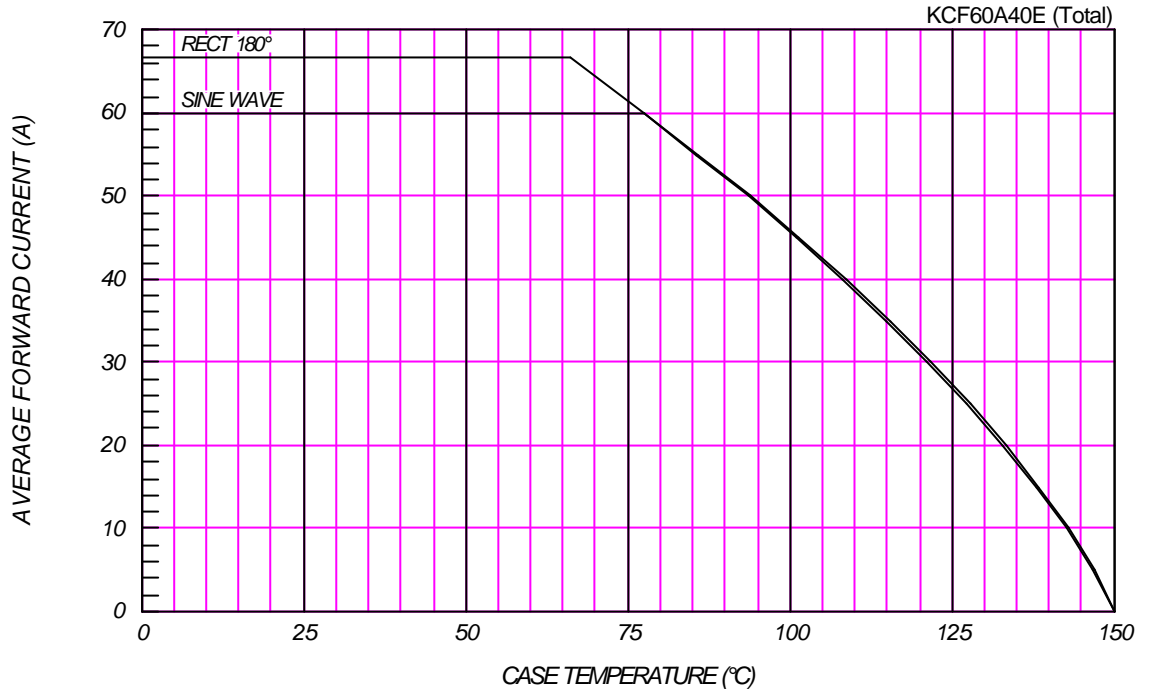

SURGE CURRENT RATINGS

f=50Hz, Sine Wave, Non-Repetitive, No Load

