

双面金属化聚丙烯膜IGBT吸收电容器 - SCD -LT

Double -side Metallized Polypropylene Film snubber Capacitor for IGBT application - SCD -LT

特点：

适用于高频10K~200KHZ,高压3000VDC以下电路中；
 损耗小，温升低，环温 85 温升 8 ；
 环温105 温升 6 ；
 高可靠性：Undc,85 ,1000H, C ±5%；
 105 ,1000H, C ±10%；
 低ESL,ESR,高dv/dt.

结构：

内部串联卷绕结构
 介质：聚丙烯膜
 电极：双面金属化膜。
 引出端：铜片端
 封装：UL94V0阻燃性壳体和环氧树脂封装。

主要用途：

IGBT吸收电容器

FEATURE：

It can use in high frequency of 10K~200KHZ,and high voltage which is below 3000VDC on the circuit ;
 Small loss and low temperature ,
 Circumstance temperature 85 temperature rising 8 ;
 Circumstance temperature 105 temperature rising 8 ;
 High reliability : Undc,85 ,1000H, C ±5%;
 105 ,1000H, C ±10%;
 Low ESL,ESR;High dv/dt.

STRUETURE:

Wound capacitor with internal series connection.
 Dielectric : PT film .
 Capacitor electrode : Double side matellized PE film .
 Strap terminals : Cu lug terminals (LT) .
 Encapsulatin : flame -retardent plastic case with epoxy resion seal,UL94V0.

MAIN APPLICATION:

IGBT snubbering .

5. Electrical specifications- 电气特性

Item	Specification					
Reference standard 引用标准	IEC61071,GBT17702.1:2013					
climatic category 气候类别	40/105/21					
Operating Temperature 工作温度	-40 ~+105 (+85 ~+105 :derating factor2.5% per for Un(DC)and AC current Irms, 85 ~ 105 时Dc电压和AC电流Irms衰减系数 2.5%/度)					
Rated Voltage Undc 额定电压(VDC at 85)	850	1000	1200	1600	2000	3000
Urms AC Voltage Vac AC电压有效值(at f<1Khz)	450	500	550	600	650	700
Capacitance Range 容量范围 (μ F)	1.2~6.5	0.56~4.7	0.15~2.7	0.15~1.8	0.1~1.4	0.068~0.65
Capacitance Tolerance 容量偏差	± 5%(J), ± 10%(K)					
Dissipation Factor 散逸因素	0.002 (1Khz,25) ;					
Insulation Resistance 绝缘电阻	IR ≥30,000s, C>0.33 μ F IR ≥100,000 M , C 0.33 μ F (100VDC charged 1min , 60s, 20)					
Withstand Voltage between T/T 端子间耐电压	1.5*Undc , 10s					
Withstand Voltage between T/C 端子对外壳耐电压	3000Vac / 50HZ, 60S					

FILM CAPACITORS

IGBT Snubber capacitor - SCD-LT

U _R VDC	Vrms for f<1kHz VAC	容量 (uF)	宽度 W (±1mm)	高度 H (±1mm)	厚度 T (±1mm)	P	Pin type	d /LT	dV/dT (V/μs)	I _{rms} 100kHz (A)	ESR 100kHz m	C.C
850	450	1.2	47.5	31	20	LT	L or N	0.8	400	12	6.5	TP4B
		1.5	47.5	37	24	LT	L or N	0.8	400	13	6	TP4E
		1.8	47.5	40	28	LT	L or N	0.8	400	14	5.5	TP4M
		2	47.5	40	28	LT	L or N	0.8	400	15	5	TP4M
		2.2	47.5	45	30	LT	L or N	0.8	400	16	5	P470
		2.5	47.5	45	30	LT	L or N	0.8	400	18	4.5	P470
		3	47.5	48	33	LT	L or N	0.8	400	20	4	P471
		3.3	47.5	48	33	LT	L or N	0.8	400	21	3.8	P471
		3.5	47.5	49.5	40	LT	L or N	0.8	400	23	3.5	TP4X
		4	47.5	49.5	40	LT	L or N	0.8	400	23	3.3	TP4X
		1.5	57.5	38	23	LT	L or N	0.8	275	12	7	TP57
		2	57.5	38	23	LT	L or N	0.8	275	14	6	TP57
		3	57.5	40	30	LT	L or N	0.8	275	19	5	TP59
		3.3	57.5	40	30	LT	L or N	0.8	275	19	5	TP59
		4	57.5	50	35	LT	L or N	0.8	275	21	3.5	TP5E
		4.7	57.5	50	35	LT	L or N	0.8	275	23	3.5	TP5E
		5	57.5	50	35	LT	L or N	0.8	275	23	3.5	TP5E
		5.6	57.5	57.5	38	LT	L or N	0.8	275	27	3	P571
		6	57.5	57.5	38	LT	L or N	0.8	275	27.5	2.8	P571
		6.5	57.5	57.5	38	LT	L or N	0.8	275	29	2.5	P571
1000	500	0.56	47.5	31	17	LT	L or N	0.8	450	10	10	TP4A
		0.68	47.5	31	20	LT	L or N	0.8	450	11	9	TP4B
		0.82	47.5	33	20	LT	L or N	0.8	450	11.5	7	TP4C
		1	47.5	35	23	LT	L or N	0.8	450	13	6	TP4D
		1.5	47.5	40	28	LT	L or N	0.8	450	16.5	5	TP4M
		1.8	47.5	45	30	LT	L or N	0.8	450	17	4	P470
		2.2	47.5	48	33	LT	L or N	0.8	450	19	4	P470
		2.7	47.5	49.5	40	LT	L or N	0.8	450	22	3.3	TP4X
		3	47.5	49.5	40	LT	L or N	0.8	450	9	7.8	TP4X
		1.5	57.5	38	23	LT	L or N	0.8	300	13.5	6.5	TP57
		2.2	57.5	40	30	LT	L or N	0.8	300	17	5	TP59
		2.2	57.5	45	25	LT	L or N	0.8	300	17	5	TP56
		2.7	57.5	43	32	LT	L or N	0.8	300	20	4.5	TP5A
		3.3	57.5	50	35	LT	L or N	0.8	300	22	4	TP5E
		4	57.5	57	38	LT	L or N	0.8	300	24	3.5	TP5E
		4.7	57.5	57	38	LT	L or N	0.8	300	24	3.5	TP5E

IGBT Snubber capacitor - SCD-LT

U _R VDC	Vrms for f<1kHz VAC	容量 (uF)	宽度 W (mm)	高度 H (mm)	厚度 T mm)	P	Pin type	d /LT	dV/dT (V/μs)	I _{rms} 100kHz (A)	ESR 100kHz m	C.C
1200	550	0.15	47.5	31	17	LT	L or N	0.8	500	5.5	13	TP4A
		0.22	47.5	31	17	LT	L or N	0.8	500	6	12	TP4B
		0.33	47.5	31	17	LT	L or N	0.8	500	6.5	11	TP4B
		0.39	47.5	31	20	LT	L or N	0.8	500	8.5	9.5	TP4B
		0.47	47.5	33	20	LT	L or N	0.8	500	9	8.5	TP4C
		0.68	47.5	37	24	LT	L or N	0.8	500	13	6	TP4E
		0.82	47.5	40	28	LT	L or N	0.8	500	14	5.5	TP4M
		1	47.5	45	30	LT	L or N	0.8	500	15	5	P470
		1.2	47.5	45	30	LT	L or N	0.8	500	16.5	4.5	P470
		1.5	47.5	48	33	LT	L or N	0.8	500	18	4.5	P471
		1.8	47.5	49.5	40	LT	L or N	0.8	500	20	4	TP4X
		2	47.5	49.5	40	LT	L or N	0.8	500	20	4	TP4X
		0.82	57.5	38	23	LT	L or N	0.8	350	11.5	7.5	TP57
		1	57.5	38	23	LT	L or N	0.8	350	12.5	7	TP57
		1.5	57.5	45	30	LT	L or N	0.8	350	15	6.5	P570
		2.2	57.5	50	35	LT	L or N	0.8	350	19	4.7	TP5E
2.7	57.5	57.5	38	LT	L or N	0.8	350	22	4	P571		
1600	600	0.15	47.5	31	17	LT	L or N	0.8	600	6.5	13	TP4A
		0.22	47.5	31	17	LT	L or N	0.8	600	8	11	TP4A
		0.27	47.5	31	20	LT	L or N	0.8	600	9	9	TP4B
		0.33	47.5	33	20	LT	L or N	0.8	600	11	8	TP4C
		0.47	47.5	37	24	LT	L or N	0.8	600	13	7	TP4E
		0.68	47.5	45	30	LT	L or N	0.8	600	14.5	6	P470
		0.82	47.5	45	30	LT	L or N	0.8	600	15	5	P470
		1	47.5	48	33	LT	L or N	0.8	600	16	4.5	P471
		1.2	47.5	49.5	40	LT	L or N	0.8	600	18	4	TP4X
		0.68	57.5	38	26	LT	L or N	0.8	400	14.5	7.5	TP58
		0.82	57.5	45	25	LT	L or N	0.8	400	15.5	7	TP56
		1	57.5	45	30	LT	L or N	0.8	400	16.5	6.7	P570
		1.2	57.5	50	35	LT	L or N	0.8	400	18.5	6.2	TP5E
		1.5	57.5	50	35	LT	L or N	0.8	400	20	5.5	TP5E
		1.8	57.5	57.5	38	LT	L or N	0.8	400	11.5	5	P571

FILM CAPACITORS

IGBT Snubber capacitor - SCD-LT

U _R VDC	Vrms for f<1kHz VAC	容量 (uF)	宽度 W (mm)	高度 H (mm)	厚度 T mm)	P	Pin type	d /LT	dV/dT (V/μs)	Irms 100kHz (A)	ESR 100kHz m	C.C
2000	650	0.1	47.5	31	17	LT	L or N	0.8	700	6	15	TP4A
		0.15	47.5	31	17	LT	L or N	0.8	700	8	13	TP4A
		0.18	47.5	31	17	LT	L or N	0.8	700	9	11	TP4A
		0.22	47.5	33	20	LT	L or N	0.8	700	9.5	9	TP4C
		0.27	47.5	35	23	LT	L or N	0.8	700	11	8	TP4D
		0.33	47.5	37	24	LT	L or N	0.8	700	11.5	6.5	TP4E
		0.47	47.5	45	30	LT	L or N	0.8	700	14	5.5	P470
		0.68	47.5	48	33	LT	L or N	0.8	700	14.5	13	P471
		0.82	47.5	49.5	40	LT	L or N	0.8	700	15	13	TP4X
		0.47	57.5	38	23	LT	L or N	0.8	500	11	7	TP57
		0.68	57.5	40	30	LT	L or N	0.8	500	13	7	TP59
		0.82	57.5	43	32	LT	L or N	0.8	500	14	6.5	TP5A
		1	57.5	50	35	LT	L or N	0.8	500	16	6	TP5E
		1.2	57.5	57.5	38	LT	L or N	0.8	500	17.5	6	P571
		1.4	57.5	57.5	38	LT	L or N	0.8	500	18	5.5	P571
3000	700	0.068	47.5	31	17	LT	L or N	0.8	1200	5.5	15	TP4A
		0.082	47.5	31	17	LT	L or N	0.8	1200	6.4	14	TP4A
		0.1	47.5	31	20	LT	L or N	0.8	1200	7	13	TP4B
		0.15	47.5	37	24	LT	L or N	0.8	1200	8.5	11	TP4E
		0.18	47.5	45	30	LT	L or N	0.8	1200	10	10	P470
		0.22	47.5	45	30	LT	L or N	0.8	1200	12	9	P470
		0.33	47.5	48	33	LT	L or N	0.8	1200	14	8.5	P471
		0.39	47.5	49.5	40	LT	L or N	0.8	1200	15	8	TP4X
		0.22	57.5	38	26	LT	L or N	0.8	800	10	10	TP58
		0.33	57.5	45	30	LT	L or N	0.8	800	12.5	9	P570
		0.39	57.5	45	30	LT	L or N	0.8	800	14	8	P570
		0.47	57.5	50	35	LT	L or N	0.8	800	15	7	TP5E
		0.56	57.5	57.5	38	LT	L or N	0.8	800	17	6	P571
		0.65	57.5	57.5	38	LT	L or N	0.8	800	18	5	P571

Outline drawings 尺寸圖

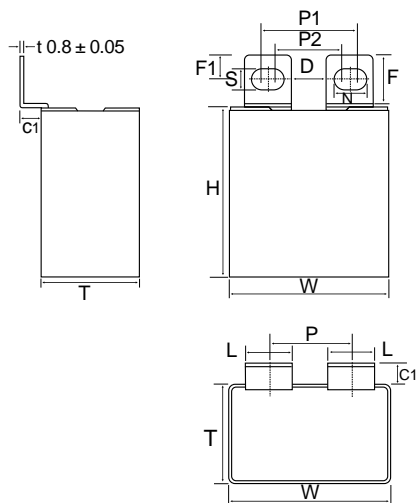

type N1

W	P1 ±0.5	P2 ±0.5	D min	F ±1	F1 ±1	S ±0.2	L ±1	C1 ±1
47.5	28	23	10.2	15	6.8	6.2	14.0	6
57.5	43	38	25.2	15	6.8	6.2	14.0	6

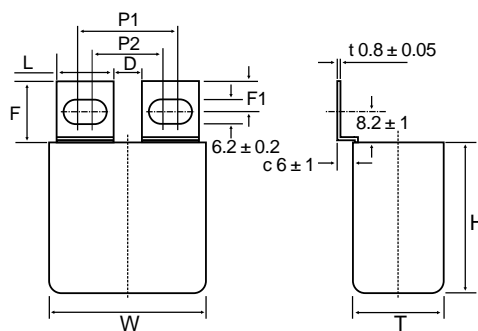

type N2

W	P1 ±0.5	P2 ±0.5	D min	F ±1	F1 ±1	S ±0.2	L ±1	C ±1
47.5	32.3	22.7	11	15	6.8	6.2	16	6
57.5	47.3	37.7	26	15	6.8	6.2	16	6

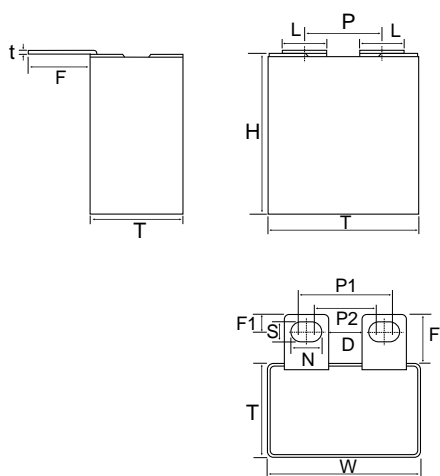

type L1

W	P1 ±0.5	P2 ±0.5	D min	L ±1	F ±1	S ±0.2	C1 ±1	t ±0.05
47.5	32.3	22.7	11	16	16	6.2	0-3.5	0.8
57.5	47.3	37.7	20	16	16	6.2	0-3.5	0.8

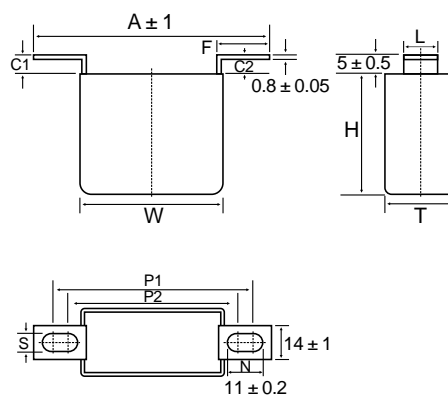

type L2

W	P1 ±0.5	P2 ±0.5	N ±0.2	L ±0.3	F ±1	S ±0.2	C1 ±0.5	C2 ±0.5
47.5	72.5	62.5	11	14	22	6.2	5	5
57.5	82.5	72.5	11	14	22	6.2	5	5