

Damper Diodes (For TV)

Parameter Type No.	Absolute Maximum Ratings					Electrical Characteristics (Ta=25°C)							Others		
	VRM (V)	IF(AV) (A)	IFSM (A)	TJ (°C)	Tstg (°C)	VF (V)		IR (μA)	IR (H) (μA)	ttr① (μs)	ttr② (μs)	Rth (j-ℓ)	Mass (g)	Fig.	
			50Hz Half-cycle Sinewave Single Shot			max	IF (A)	VR=VRM max	VR=VRM Ta=100°C max	IF/IRP (mA)	IF/IRP (mA)	(°C/W)			
FMV-G5FS	1500	10.0	50	-40 to +150		1.5	10.0	50	700	2.0	500/500	0.8	2.0	6.5	Ⓐ
FMR-G5HS	1800					1.6		20	200	1.8		0.7			

FMV-G5FS

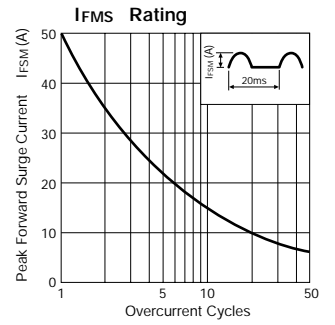
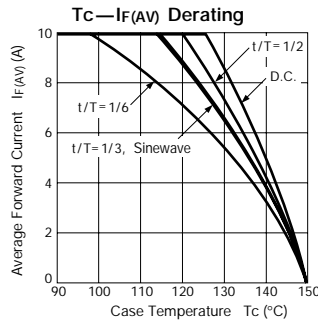
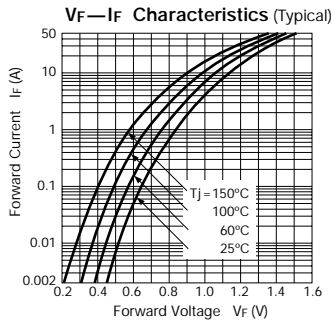
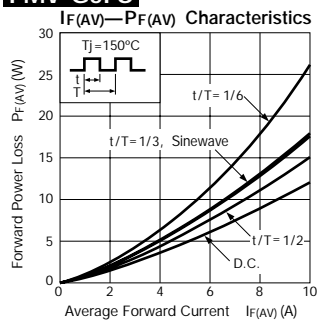

FMR-G5HS

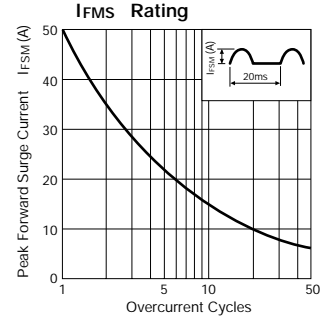
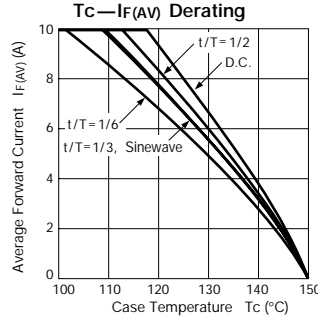
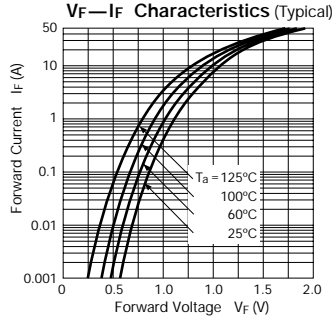
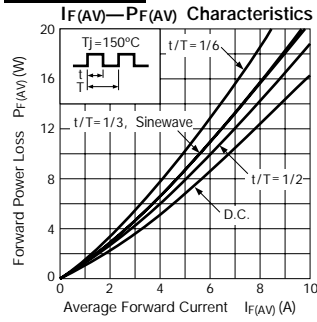

External Dimensions

(Unit: mm) (Full-mold)

Flammability:
UL94V-0 or Equivalent

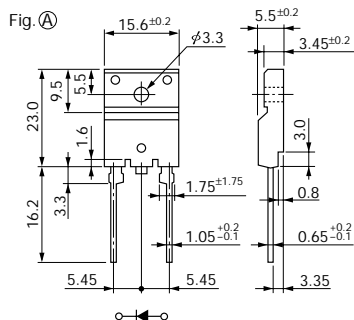

This datasheet has been downloaded from:

www.DatasheetCatalog.com

Datasheets for electronic components.