

SMD Power Inductor

CDH30D14/H125



特点

- Ferrite drum core construction
- Magnetically unshielded
- L×W×H: 3.2×3.2×1.5 mm Max.
- Product weight: 48mg(Ref.)
- Moisture Sensitivity Level: 1
- Qualification to AEC-Q200



环境规格

- Operating Temperature: -40°C to +125°C (including self-heating)
- Storage temperature range: -40°C~+125°C

包装

- Carrier tape and reel packaging

用途

- High temp and high reliability automotive applications

外形尺寸 - [mm]

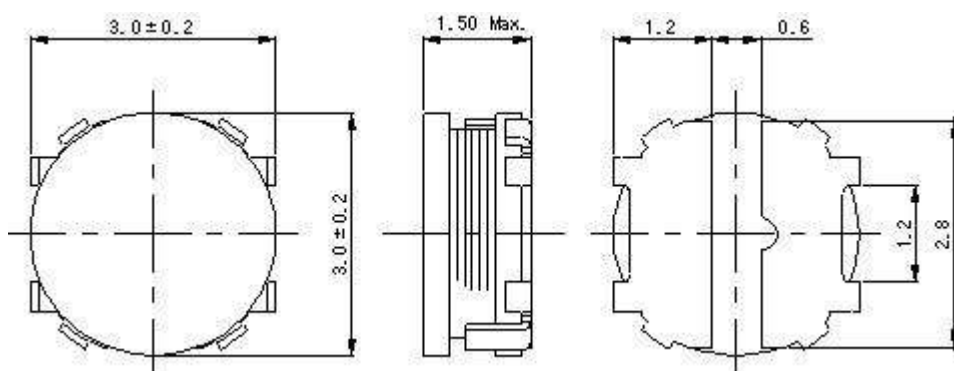

推荐焊盘尺寸 - [mm]

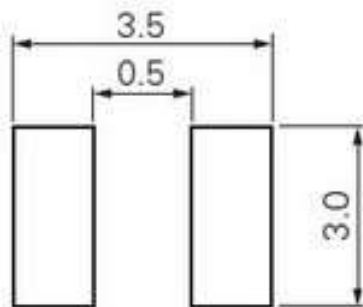

接线图 (底面)

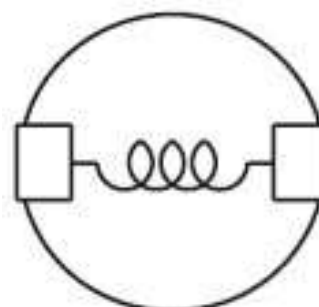

SMD Power Inductor

CDH30D14/H125



电气特性规格

品名	电感值 [within] (μ H) ※1	直流电阻 (20℃) Max. (Typ.) (m Ω)	饱和电流 (A) Max. (Typ.) ※2		温度上升电流 (A) Max. (Typ.) ※3
			20℃	125℃	
CDH30D14H125NP-1R0MC	1.00 \pm 20%	68.80 (55.00)	2.70 (3.65)	2.20 (2.85)	1.97 (2.30)
CDH30D14H125NP-2R2MC	2.20 \pm 20%	131 (105)	1.90 (2.46)	1.50 (1.93)	1.40 (1.60)
CDH30D14H125NP-3R3MC	3.30 \pm 20%	194 (155)	1.50 (1.86)	1.30 (1.52)	1.12 (1.30)
CDH30D14H125NP-4R7MC	4.70 \pm 20%	250 (200)	1.30 (1.64)	1.10 (1.34)	1.05 (1.20)
CDH30D14H125NP-5R6MC	5.60 \pm 20%	313 (250)	1.10 (1.43)	0.95 (1.15)	0.77 (0.90)
CDH30D14H125NP-6R8MC	6.80 \pm 20%	438 (350)	1.00 (1.33)	0.80 (1.07)	0.68 (0.78)
CDH30D14H125NP-100MC	10.00 \pm 20%	650 (520)	0.95 (1.12)	0.70 (0.85)	0.57 (0.64)

※1 Measuring frequency inductance at 100kHz, 1V.

※2 Allowable D.C. bias current: the value of D.C. current when inductance is above 70% of its initial value.

※3 Temperature rise current: the actual value of D.C. current when temperature of coil increased

$\Delta T=40^{\circ}\text{C}$ ($T_a=20^{\circ}\text{C}$).

回流焊耐热与推荐温度曲线图

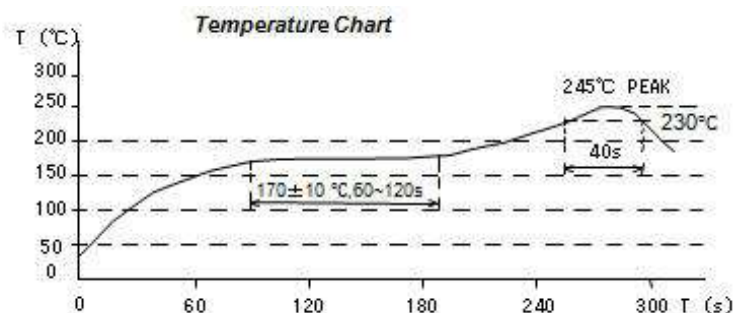
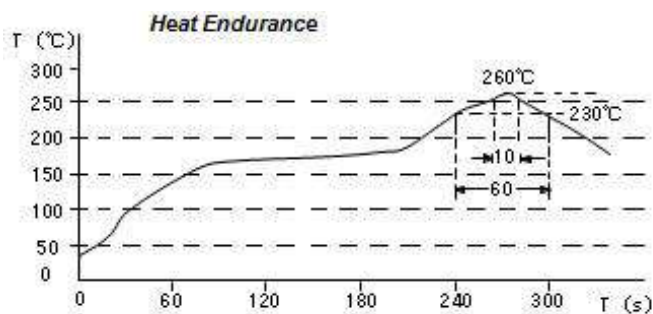

SMD Power Inductor

CDH30D14/H125



直流饱和电流&温度上升曲线图

— L (20°C) — L (125°C) — ΔT

1. CDH30D14H125NP-1R0MC

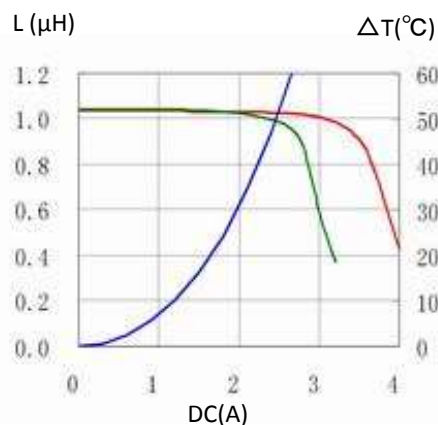

2. CDH30D14H125NP-2R2MC

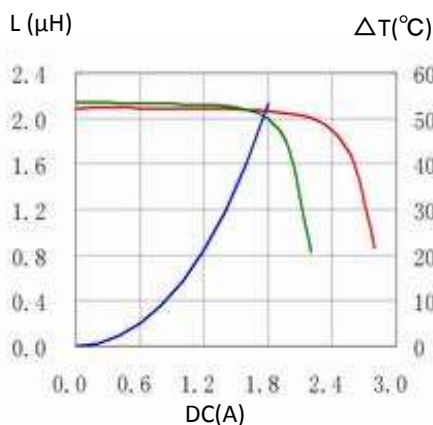

3. CDH30D14H125NP-3R3MC

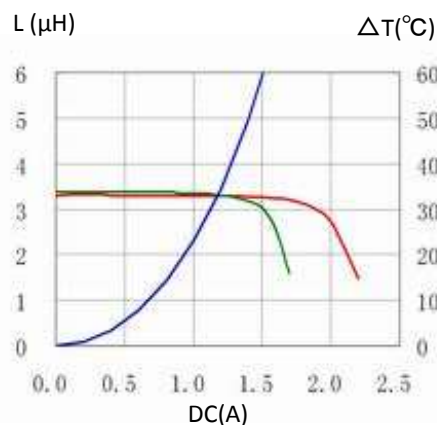

4. CDH30D14H125NP-4R7MC

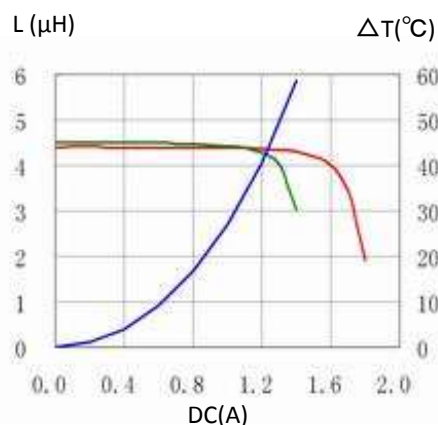

5. CDH30D14H125NP-5R6MC

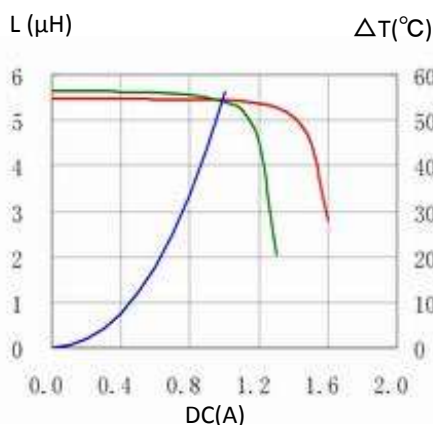

6. CDH30D14H125NP-6R8MC

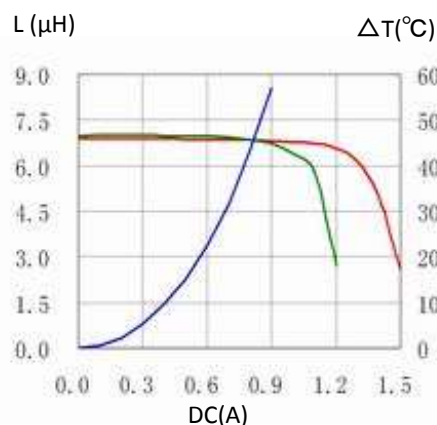

7. CDH30D14H125NP-100MC

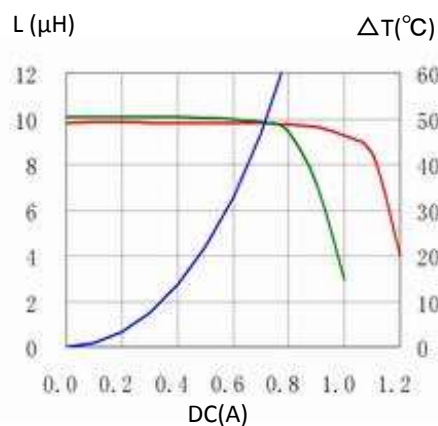

有关销售办事处的信息，请 [点击这里](#)。