



### DESCRIPTION:

T30xxH series triacs, with high ability to withstand the shock loading of large current, provide high dv/dt rate with strong resistance to electromagnetic interface. With high commutation performances, 3 quadrants products especially recommended for use on inductive load. From all three terminals to external heatsink, T30xxH-xxA provides a rated insulation voltage of 2500 V<sub>RMS</sub>, and T30xxH-xxF provides a rated insulation voltage of 2000 V<sub>RMS</sub>, complying with UL standards. (File ref: E252906).

### MAIN FEATURES

Symbol	Value	Unit
T <sub>j</sub>	150	°C
I <sub>T(RMS)</sub>	30	A
V <sub>DRM</sub> / V <sub>RPM</sub>	600/800	V

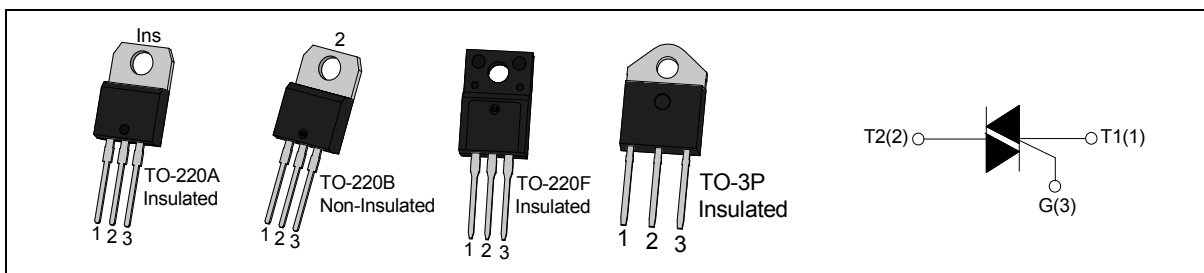

### ABSOLUTE MAXIMUM RATINGS

Parameter	Symbol	Value	Unit	
Storage junction temperature range	T <sub>stg</sub>	-40-150	°C	
Operating junction temperature range	T <sub>j</sub>	-40-150	°C	
Repetitive peak off-state voltage (T <sub>j</sub> =25°C)	V <sub>DRM</sub>	600/800	V	
Repetitive peak reverse voltage (T <sub>j</sub> =25°C)	V <sub>RPM</sub>	600/800	V	
RMS on-state current	I <sub>T(RMS)</sub>	TO-220A(Ins)/ TO-220F(Ins) (T <sub>c</sub> =75°C)	30	A
		TO-220B(Non-Ins) (T <sub>c</sub> =90°C)		
		TO-3P (T <sub>c</sub> =100°C)		

Non repetitive surge peak on-state current (full cycle, F=50Hz)	$I_{TSM}$	270	A
$I^2t$ value for fusing ( $t_p=10ms$ )	$I^2t$	340	$A^2s$
Critical rate of rise of on-state current ( $I_G=2 \times I_{GT}$ )	$di/dt$	50	$A/\mu s$
Peak gate current	$I_{GM}$	4	A
Average gate power dissipation	$P_{G(AV)}$	1	W
Peak gate power	$P_{GM}$	10	W

**ELECTRICAL CHARACTERISTICS** ( $T_j=25^\circ C$  unless otherwise specified)

Symbol	Test Condition	Quadrant		Value		Unit
				T3035H	T3050H	
$I_{GT}$	$V_D=12V R_L=33\Omega$	I - II -III	MAX	35	50	mA
$V_{GT}$		I - II -III	MAX	1.3		V
$V_{GD}$	$V_D=V_{DRM} T_j=150^\circ C$ $R_L=3.3K\Omega$	I - II -III	MIN	0.2		V
$I_L$	$I_G=1.2I_{GT}$	I -III	MAX	50	70	mA
		II		60	80	
$I_H$	$I_T=100mA$		MAX	40	50	mA
$dV/dt$	$V_D=2/3V_{DRM}$ Gate Open $T_j=150^\circ C$		MIN	500	1000	$V/\mu s$

**STATIC CHARACTERISTICS**

Symbol	Parameter		Value(MAX)	Unit
$V_{TM}$	$I_{TM}=35A t_p=380\mu s$	$T_j=25^\circ C$	1.5	V
$I_{DRM}$	$V_D=V_{DRM} V_R=V_{RRM}$	$T_j=25^\circ C$	5	$\mu A$
$I_{RRM}$		$T_j=150^\circ C$	3	mA

**THERMAL RESISTANCES**

Symbol	Parameter		Value	Unit
$R_{th(j-c)}$	junction to case(AC)	TO-220A(Ins)	1.5	$^\circ C/W$
		TO-220F(Ins)	1.7	
		TO-220B (Non-Ins)	1.3	
		TO-3P(Ins)	0.9	

ORDERING INFORMATION

<p><b>T</b></p> <p>Triacs</p> <p>30:IT(RMS):30A</p> <p>35:IGT1-3 ≤ 35mA</p> <p>50:IGT1-3 ≤ 50mA</p>	<p><b>30</b></p>	<p><b>35</b></p>	<p><b>H</b></p> <p>H:T<sub>j</sub>=150°C</p>	<p><b>-6</b></p> <p>6:V<sub>DRM</sub>/V<sub>RRM</sub> ≥ 600V</p> <p>8:V<sub>DRM</sub>/V<sub>RRM</sub> ≥ 800V</p>	<p><b>A</b></p> <p>Z:TO-3P(Ins)</p> <p>A:TO-220A(Ins)</p> <p>F:TO-220F(Ins)</p> <p>B:TO-220B(Non-Ins)</p>
---	------------------	------------------	--	--	---

PACKAGE MECHANICAL DATA

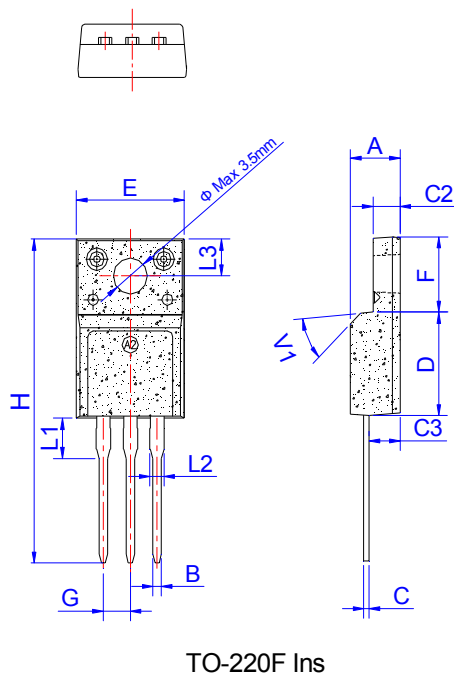

Ref.	Dimensions					
	Millimeters			Inches		
	Min.	Typ.	Max.	Min.	Typ.	Max.
A	4.50		4.90	0.177		0.193
B	0.74	0.80	0.83	0.029	0.031	0.033
C	0.47		0.65	0.019		0.026
C2	2.45		2.75	0.096		0.108
C3	2.60		3.00	0.102		0.118
D	8.80		9.30	0.346		0.366
E	9.80		10.4	0.386		0.410
F	6.40		6.80	0.252		0.268
G		2.54			0.1	
H	28.0		29.8	1.102		1.173
L1		3.63			0.143	
L2	1.14		1.70	0.045		0.067
L3		3.30			0.130	
V1		45°			45°	

## PACKAGE MECHANICAL DATA

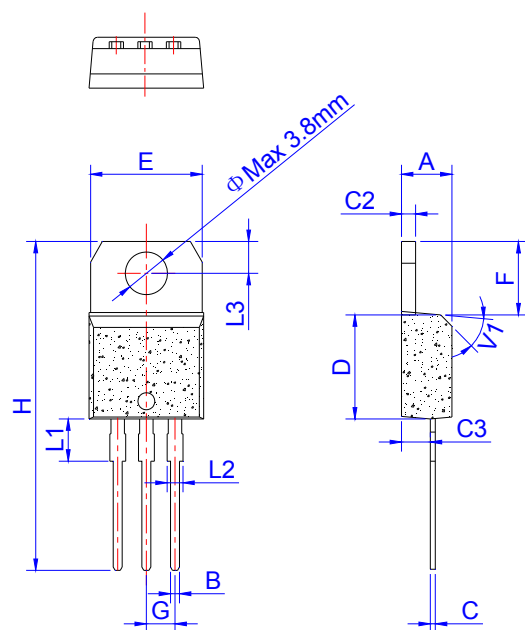

TO-220A Ins

Ref.	Dimensions					
	Millimeters			Inches		
	Min.	Typ.	Max.	Min.	Typ.	Max.
A	4.40		4.60	0.173		0.181
B	0.61		0.88	0.024		0.035
C	0.46		0.70	0.018		0.028
C2	1.21		1.32	0.048		0.052
C3	2.40		2.72	0.094		0.107
D	8.60		9.70	0.339		0.382
E	9.80		10.4	0.386		0.409
F	6.55		6.95	0.258		0.274
G		2.54			0.1	
H	28.0		29.8	1.102		1.173
L1		3.75			0.148	
L2	1.14		1.70	0.045		0.067
L3	2.65		2.95	0.104		0.116
V1		45°			45°	

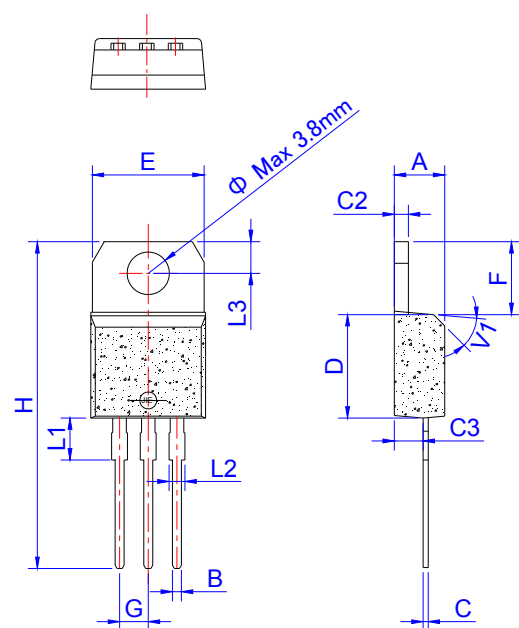

TO-220B Non-Ins

Ref.	Dimensions					
	Millimeters			Inches		
	Min.	Typ.	Max.	Min.	Typ.	Max.
A	4.40		4.60	0.173		0.181
B	0.61		0.88	0.024		0.035
C	0.46		0.70	0.018		0.028
C2	1.21		1.32	0.048		0.052
C3	2.40		2.72	0.094		0.107
D	8.60		9.70	0.339		0.382
E	9.60		10.4	0.378		0.409
F	6.20		6.60	0.244		0.260
G		2.54			0.1	
H	28.0		29.8	1.102		1.173
L1		3.75			0.148	
L2	1.14		1.70	0.045		0.067
L3	2.65		2.95	0.104		0.116
V1		45°			45°	

## PACKAGE MECHANICAL DATA

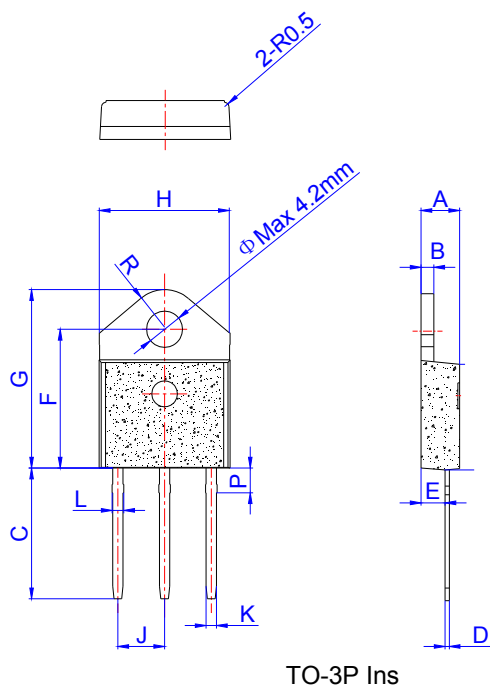

Ref.	Dimensions					
	Millimeters			Inches		
	Min.	Typ.	Max.	Min.	Typ.	Max.
A	4.40		4.60	0.173		0.181
B	1.45		1.55	0.057		0.061
C	14.35		15.60	0.565		0.614
D	0.50		0.70	0.020		0.028
E	2.70		2.90	0.106		0.114
F	15.80		16.50	0.622		0.650
G	20.40		21.10	0.803		0.831
H	15.10		15.50	0.594		0.610
J	5.40		5.65	0.213		0.222
K	1.10		1.40	0.043		0.055
L	1.35		1.50	0.053		0.059
P	2.80		3.00	0.110		0.118
R		4.35			0.171	

## MARKING

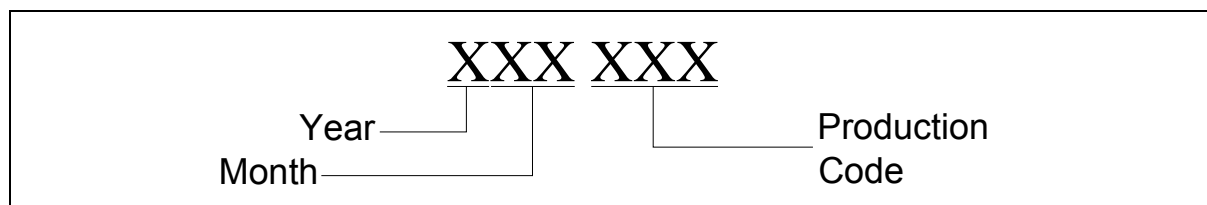
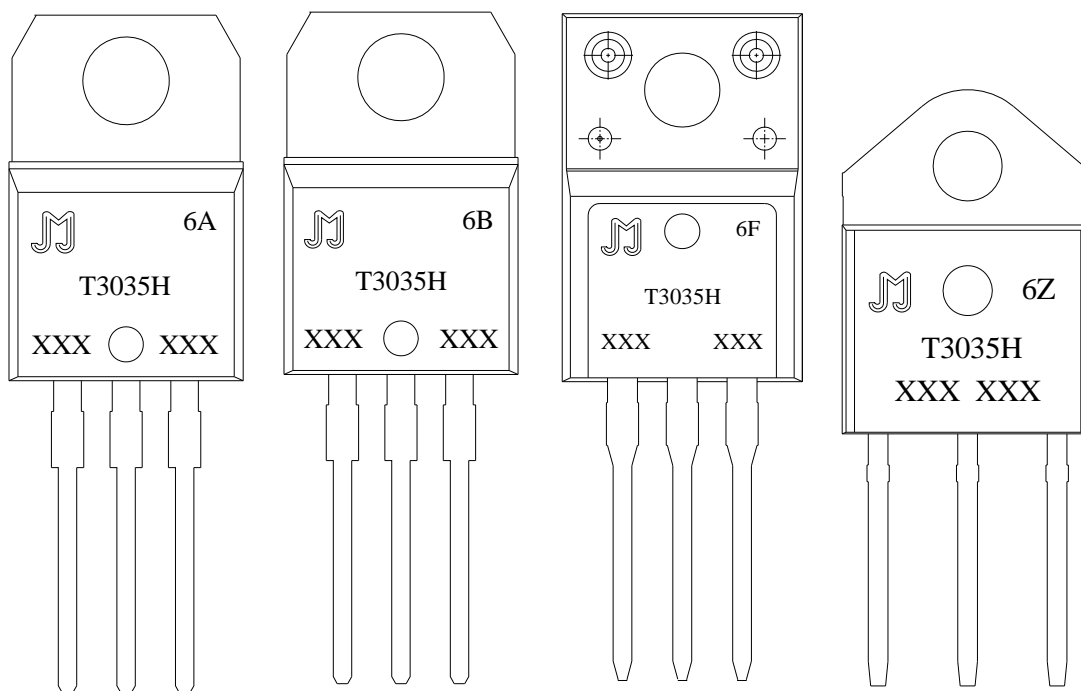

PACKAGE INFORMATION

PACKAGE	WEIGHT (PER PCS)	OUTLINE	TUBE (PCS)	INNER BOX (PCS)	PER CARTON
TO-220A	2.308g	TUBE	50	1,000	8,000
TO-220B	1.935g	TUBE	50	1,000	8,000
TO-220F	2.093g	TUBE	50	1,000	8,000
TO-3P	4.63g	TUBE	30	450	3,600

FIG.1: Maximum power dissipation versus RMS on-state current

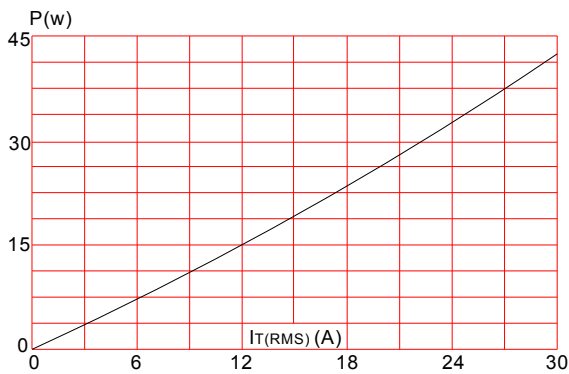

FIG.2: RMS on-state current versus case temperature

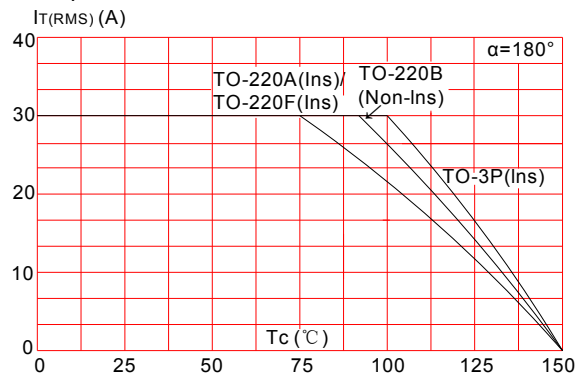

FIG.3: Surge peak on-state current versus number of cycles

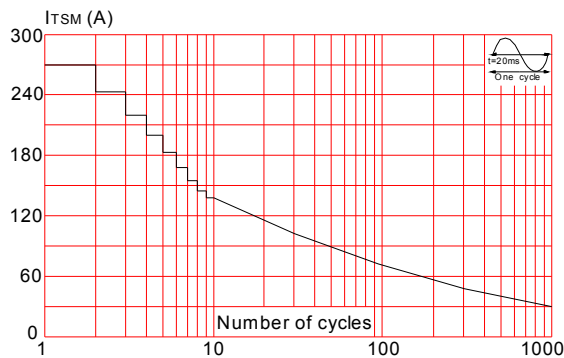

FIG.4: On-state characteristics (maximum values)

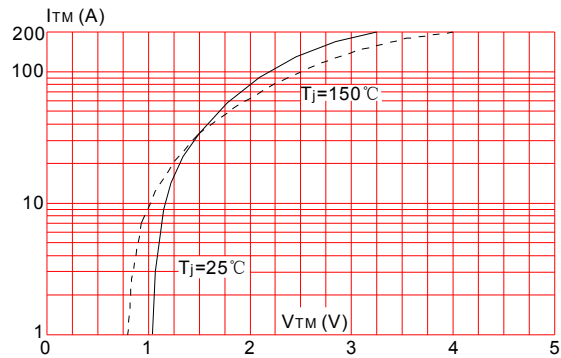

FIG.5: Non-repetitive surge peak on-state current for a sinusoidal pulse with width  $t_p < 20\text{ms}$ , and corresponding value of  $\int t (dI/dt < 50\text{A}/\mu\text{s})$

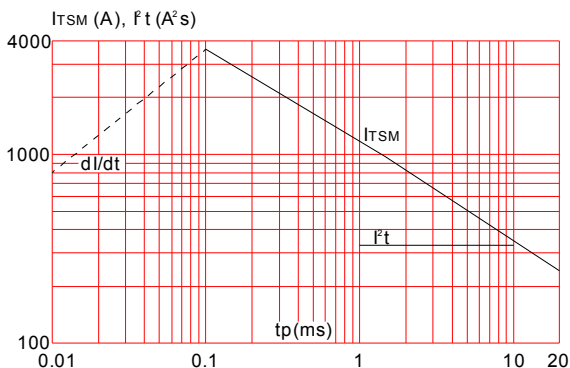
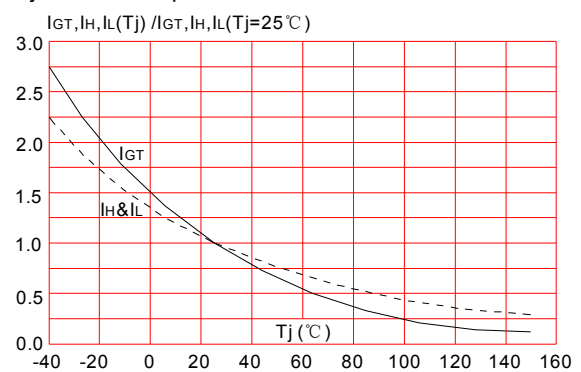



FIG.6: Relative variations of gate trigger current, holding current and latching current versus junction temperature



Information furnished in this document is believed to be accurate and reliable. However, Jiangsu JieJie Microelectronics Co.,Ltd assumes no responsibility for the consequences of use without consideration for such information nor use beyond it. Information mentioned in this document is subject to change without notice, apart from that when an agreement is signed, Jiangsu JieJie complies with the agreement. Products and information provided in this document have no infringement of patents. Jiangsu JieJie assumes no responsibility for any infringement of other rights of third parties which may result from the use of such products and information. This document is the sixth version which is made in 16-Mar.-2019. This document supersedes and replaces all information previously supplied.

 is a registered trademark of Jiangsu JieJie Microelectronics Co.,Ltd.

Copyright ©2019 Jiangsu JieJie Microelectronics Co.,Ltd. Printed All rights reserved.