

MP2505WG THRU MP2510WG

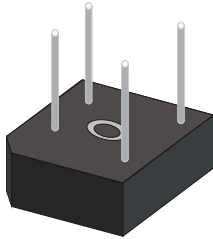

GLASS PASSIVATED 25 AMP BRIDGE RECTIFIERS



FEATURES

- * Superior thermal design
- * 300 amperes surge capability
- * Mounting: Hole thru for #8 screw

VOLTAGE RANGE

50 to 1000 Volts

CURRENT

25.0 Amperes

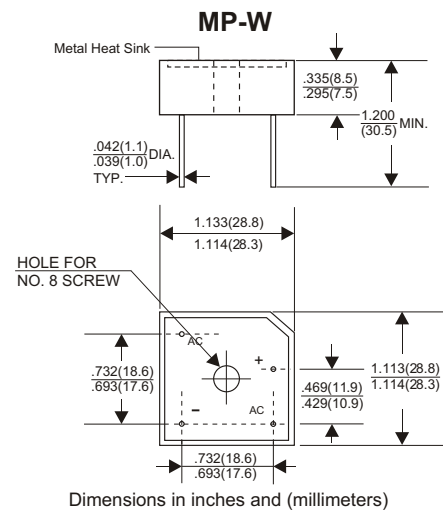

MAXIMUM RATINGS AND ELECTRICAL CHARACTERISTICS

Rating 25°C ambient temperature unless otherwise specified.
Single phase half wave, 60Hz, resistive or inductive load.
For capacitive load, derate current by 20%.

TYPE NUMBER	MP2505WG	MP251WG	MP252WG	MP254WG	MP256WG	MP258WG	MP2510WG	UNITS	
Maximum Recurrent Peak Reverse Voltage	50	100	200	400	600	800	1000	V	
Maximum RMS Voltage	35	70	140	280	420	560	700	V	
Maximum DC Blocking Voltage	50	100	200	400	600	800	1000	V	
Maximum Average Forward Rectified Current .375"(9.5mm) Lead Length at Tc=55°C								25	A
Peak Forward Surge Current, 8.3 ms single half sine-wave superimposed on rated load (JEDEC method)								300	A
Maximum Forward Voltage Drop per Bridge Element at 12.5AD.C.								1.1	V
Maximum DC Reverse Current T _J =25°C								10	μA
at Rated DC Blocking Voltage T _J =125°C								500	μA
Operating Temperature Range, T _J								-55 — +150	°C
Storage Temperature Range, T _{stg}								-55 — +150	°C

RATING AND CHARACTERISTIC CURVES (MP2505WG THRU MP2510WG)

FIG.1-TYPICAL FORWARD CURRENT DERATING CURVE

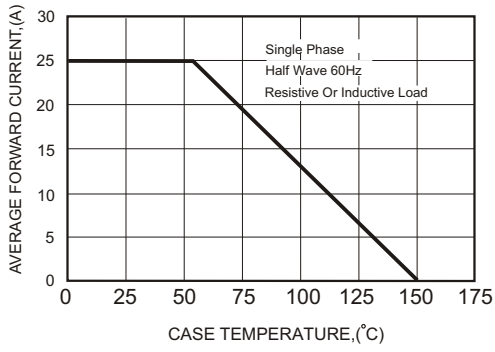

FIG.2-MAXIMUM NON-REPETITIVE FORWARD SURGE CURRENT

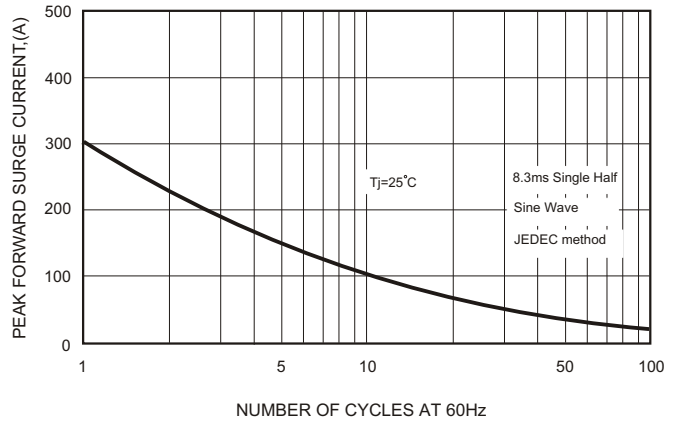

FIG.3-TYPICAL FORWARD CHARACTERISTICS

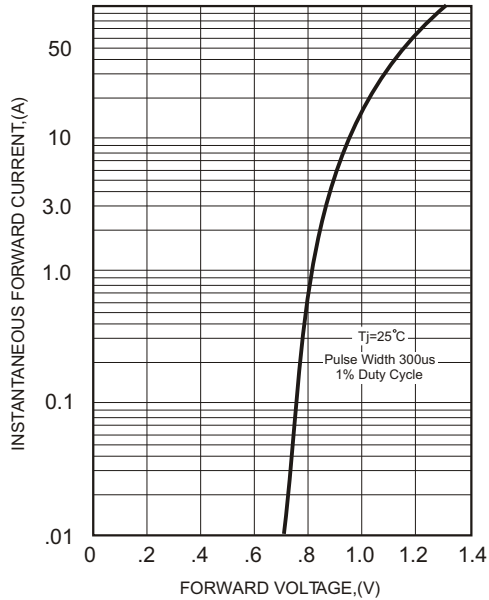

FIG.4-TYPICAL REVERSE CHARACTERISTICS

