

**CRSH5-2 SERIES  
CRSH5-2G\* SERIES**

**SCHOTTKY BARRIER RECTIFIERS  
5.0 AMP, 20 THRU 80 VOLTS**

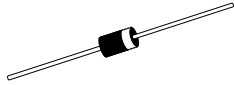

**CASE DO-201AD**

**Central™  
Semiconductor Corp.**

**DESCRIPTION:**

The CENTRAL SEMICONDUCTOR CRSH5-2 Series types are 5.0 Amp, Glass Passivated Schottky Barrier Rectifiers mounted in axial lead epoxy cases using metal-to-silicon junctions to yield low forward voltage drops.

**MARKING: FULL PART NUMBER**

\* Device is *Halogen Free* by design

**MAXIMUM RATINGS:** ( $T_A=25^\circ\text{C}$  unless otherwise noted)

	SYMBOL	CRSH5						UNITS
		-2	-3	-4	-5	-6	-8	
		<u>-2G</u>	<u>-3G</u>	<u>-4G</u>	<u>-5G</u>	<u>-6G</u>	<u>-8G</u>	
Peak Repetitive Reverse Voltage	$V_{RRM}$	20	30	40	50	60	80	V
DC Blocking Voltage	$V_R$	20	30	40	50	60	80	V
RMS Reverse Voltage	$V_{R(RMS)}$	14	21	28	35	42	56	V
Average Forward Current ( $T_L=100^\circ\text{C}$ )	$I_O$				5.0			A
Peak Forward Surge Current	$I_{FSM}$				250			A
Operating and Storage								
Junction Temperature	$T_J, T_{stg}$			-65 to +150				$^\circ\text{C}$

**ELECTRICAL CHARACTERISTICS:** ( $T_A=25^\circ\text{C}$  unless otherwise noted)

SYMBOL	TEST CONDITIONS	MIN	MAX	UNITS
$I_R$	$V_R=\text{Rated } V_{RRM}$		10	mA
$I_R$	$V_R=\text{Rated } V_{RRM}, T_A=100^\circ\text{C}$		100	mA
$V_F$	$I_F=5.0\text{A (20V, 30V, 40V)}$		0.57	V
$V_F$	$I_F=5.0\text{A (50V, 60V, 80V)}$		0.70	V

CASE DO-201AD - MECHANICAL OUTLINE

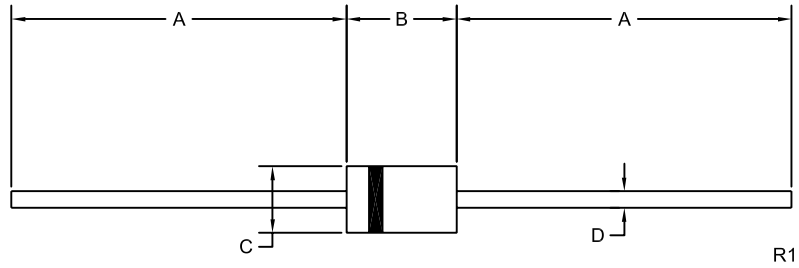

DIMENSIONS				
SYMBOL	INCHES		MILLIMETERS	
	MIN	MAX	MIN	MAX
A	1.000	-	25.40	-
B	0.283	0.375	7.20	9.53
C	0.189	0.210	4.80	5.33
D	0.047	0.052	1.20	1.32

DO-201AD (REV: R1)

MARKING: FULL PART NUMBER

## OUTSTANDING SUPPORT AND SUPERIOR SERVICES



---

### PRODUCT SUPPORT

Central's operations team provides the highest level of support to insure product is delivered on-time.

- Supply management (Customer portals)
- Inventory bonding
- Consolidated shipping options
- Custom bar coding for shipments
- Custom product packing

---

### DESIGNER SUPPORT/SERVICES

Central's applications engineering team is ready to discuss your design challenges. Just ask.

- Free quick ship samples (2<sup>nd</sup> day air)
- Online technical data and parametric search
- SPICE models
- Custom electrical curves
- Environmental regulation compliance
- Customer specific screening
- Up-screening capabilities
- Special wafer diffusions
- PbSn plating options
- Package details
- Application notes
- Application and design sample kits
- Custom product and package development

---

### REQUESTING PRODUCT PLATING

1. If requesting Tin/Lead plated devices, add the suffix " TIN/LEAD" to the part number when ordering (example: 2N2222A TIN/LEAD).
2. If requesting Lead (Pb) Free plated devices, add the suffix " PBFREE" to the part number when ordering (example: 2N2222A PBFREE).

---

### CONTACT US

#### Corporate Headquarters & Customer Support Team

Central Semiconductor Corp.  
145 Adams Avenue  
Hauppauge, NY 11788 USA  
Main Tel: (631) 435-1110  
Main Fax: (631) 435-1824  
Support Team Fax: (631) 435-3388  
[www.centrasemi.com](http://www.centrasemi.com)

**Worldwide Field Representatives:**  
[www.centrasemi.com/wwreps](http://www.centrasemi.com/wwreps)

**Worldwide Distributors:**  
[www.centrasemi.com/wwdistributors](http://www.centrasemi.com/wwdistributors)

---

For the latest version of Central Semiconductor's **LIMITATIONS AND DAMAGES DISCLAIMER**, which is part of Central's Standard Terms and Conditions of sale, visit: [www.centrasemi.com/terms](http://www.centrasemi.com/terms)