

### 1. Mechanical Dimensions:

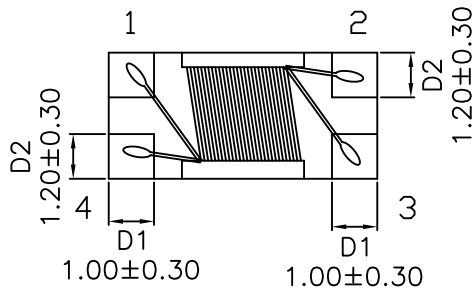

Bottom view

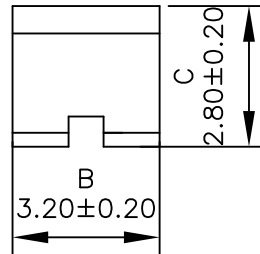
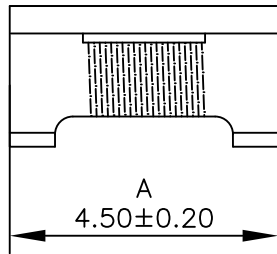
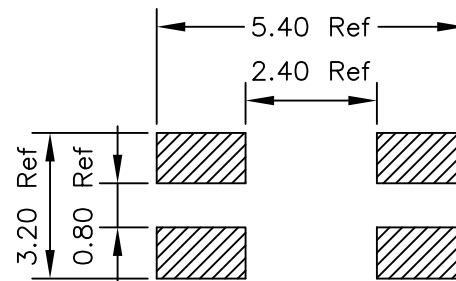

Pad layout

### 2. Schematic:

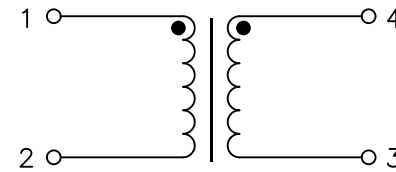

### 3. Electrical Specifications: @25C

- OCL: 100uH+50%/-30% @100KHz 0.1V Each Wdg
- Q: tbd Min @100KHz 0.1V Each Wdg
- Rated Current: 200mA Max
- Rated Voltage: 50Vdc
- DCR: 1.50 Ohms Max Each Wdg
- Insulation Resistance: 10M0hms Min 1 Minute
- Impedance: 2200 Ohms Min (5100 Ohms Typ) AT 10MHz
- Turn Ratio: (1-2):(4-3)=1:1±2%
- SRF: Pins 1-2 tbd Min

Notes:

1. Solderability: Leads shall meet MIL-STD-202G, Method 208H for solderability.
2. Flammability: UL94V-0
3. ASTM oxygen index: > 28%
4. Insulation System: Class F 155°C. UL file E151556
5. Operating Temperature: -40°C to +125°C
6. Storage Temperature Range: -40°C to +125°C
7. Aqueous wash compatible
8. SMD Lead Coplanarity: 0.004"(0.102mm) Max
9. Electrical and mechanical specifications 100% tested
10. RoHS Compliant Component
11. Outsourced item processed & controlled under XFMRs QA system
12. Recommended IR Reflow peak temp of 260°C Max.

DOC. REV: A/-

**PRELIMINARY**

<b>XFMRs Inc</b> www.XFMRs.com	Title: <b>Common Mode</b>		
	UNLESS OTHERWISE SPECIFIED TOLERANCES: .xx ±0.25 Dimensions in MM	P/N: XFWACT453228R-101	REV A
	DWN.	Huo	Jan-16-19
	CHK.	YK Liao	Jan-16-19
SHEET 1 OF 2	APP.	DDC	Jan-16-19

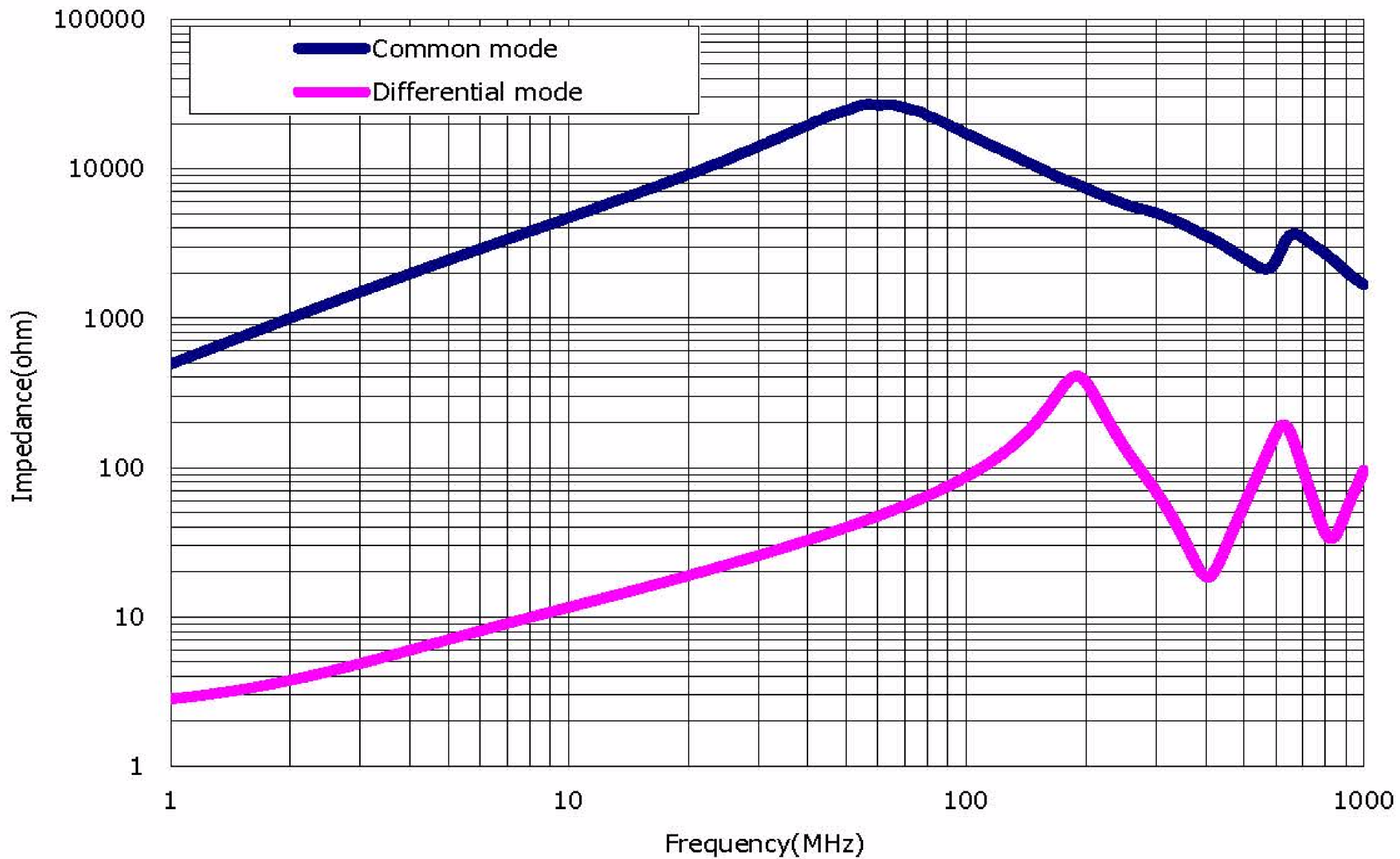

DOC. REV: A/-

<b>XFMRs Inc</b> www.XFMRS.com	Title: <b>Common Mode Choke</b>		
	P/N: XFWACT453228R-101		REV A
UNLESS OTHERWISE SPECIFIED TOLERANCES: .xx ±0.25 Dimensions in MM	DWN.	Huo	Jan-16-19
	CHK.	YK Liao	Jan-16-19
SHEET 2 OF 2	APP.	DDC	Jan-16-19

**PROPRIETARY**

Document is the property of XFMRs Group & is not allowed to be duplicated without authorization.

# TAPE AND REEL SPECIFICATION:

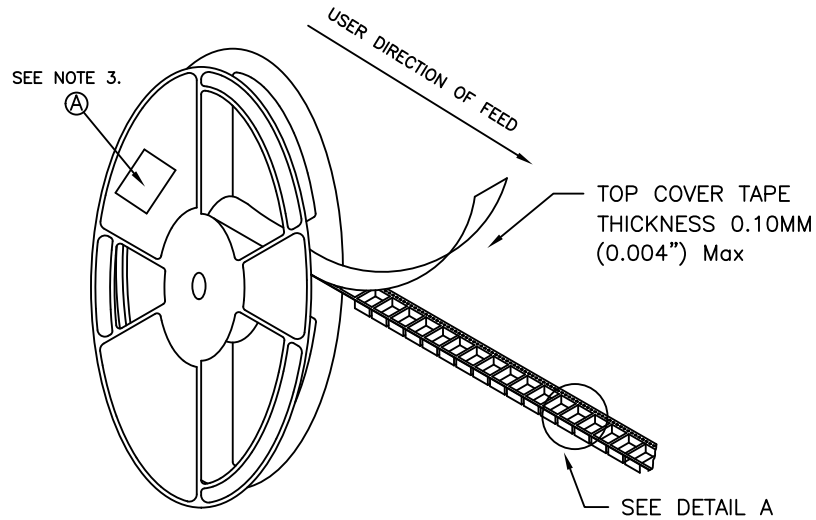

REEL AND TAPE ORIENTATION

**7" REEL DIAMETER**

## NOTES:

- 1) PROCESS IN ACCORDANCE WITH EIA-481-2 STANDARDS
  - \* TAPE LEADER DIMENSION 15.30" MIN.
  - \* TAPE TRAILER DIMENSION 6.30" MIN.
- 2) PARTS SHOULD BE PACKAGED IN ACCORDANCE WITH ESD GUIDELINES IN EIA-541.
- 3) REEL LABEL: 'A' \* CUSTOMER PART NUMBER
  - \* QUANTITY
  - \* DATE CODE
- 4) 500PCS PER 7"REEL

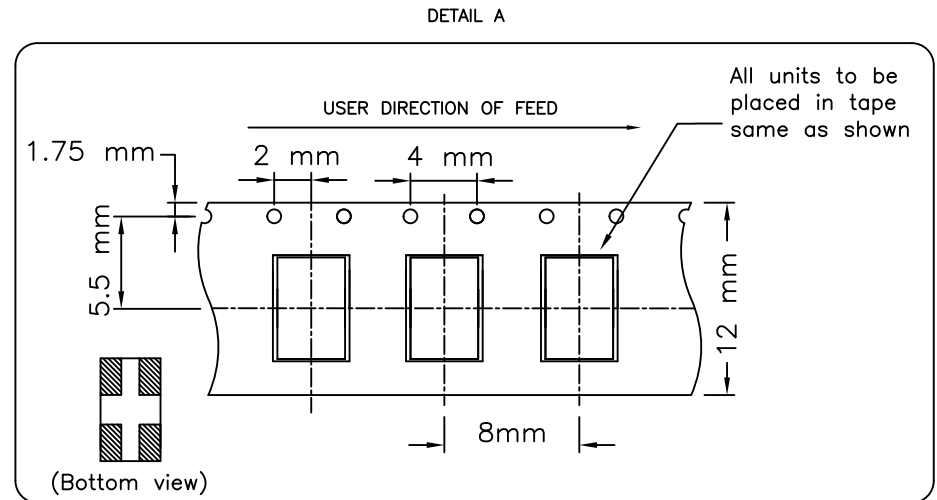

DOC.REV.A/1

<b>XFMRs Inc</b>	Title: <b>T&amp;R SPEC</b>			
	UNLESS OTHERWISE SPECIFIED TOLERANCES: .xxs ±xxxx Dimensions in mm	P/N: XFWACT453228R Series		REV. A
		DWN.	Kong	Jan-16-19
		CHK.	YK Liao	Jan-16-19
SHT 1 OF 1	APP.	DDC	Jan-16-19	

**PROPRIETARY**

Document is the property of XFMRs Group & is not allowed to be duplicated without authorization.

# XFMRs

## Recommended Infrared Reflow Temperature Profile for RoHS Compliant Parts

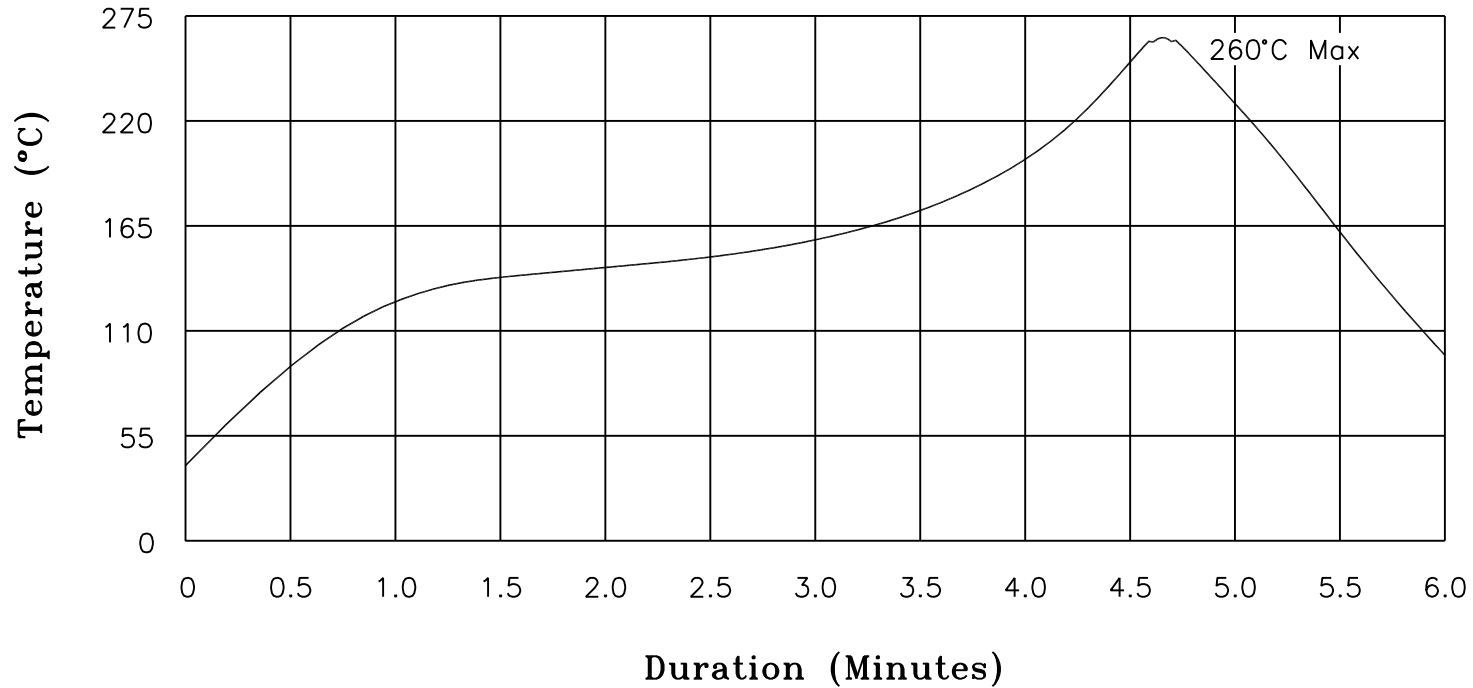

NOTES: Maximum duration at 260°+0/-5° shall be 10-20 seconds.  
 Maximum duration above 217° shall be 60-150 seconds.  
 ALL Temperatures refer to topside of the package, measured on the package body surface.

<b>XFMRs Inc</b> www.XFMRS.com	Title: <b>IR REFLOW CHART</b> <b>(RoHS Compliant parts)</b>			
	UNLESS OTHERWISE SPECIFIED TOLERANCES: N/A	P/N: N/A	REV. A	
	DWN.	Juan Mao	Jan-16-05	
	CHK.	YK Liao	Jan-16-05	
SHEET 1 OF 1	APP.	MS	Jan-16-05	

**PROPRIETARY** Document is the property of XFMRs Group & is not allowed to be duplicated without authorization.