

Aug. 1. 2022 Copyright 2022 HIROSE ELECTRIC CO., LTD. All Rights Reserved.
 In case of consideration for using Automotive equipment / device which demand high reliability, kindly contact our sales window correspondents.

ASSEMBLY TOOL: APPLICABLE OUTER CONDUCTOR CRIMPING TOOL HT303/HRM-T-4(58A/U HOLE)

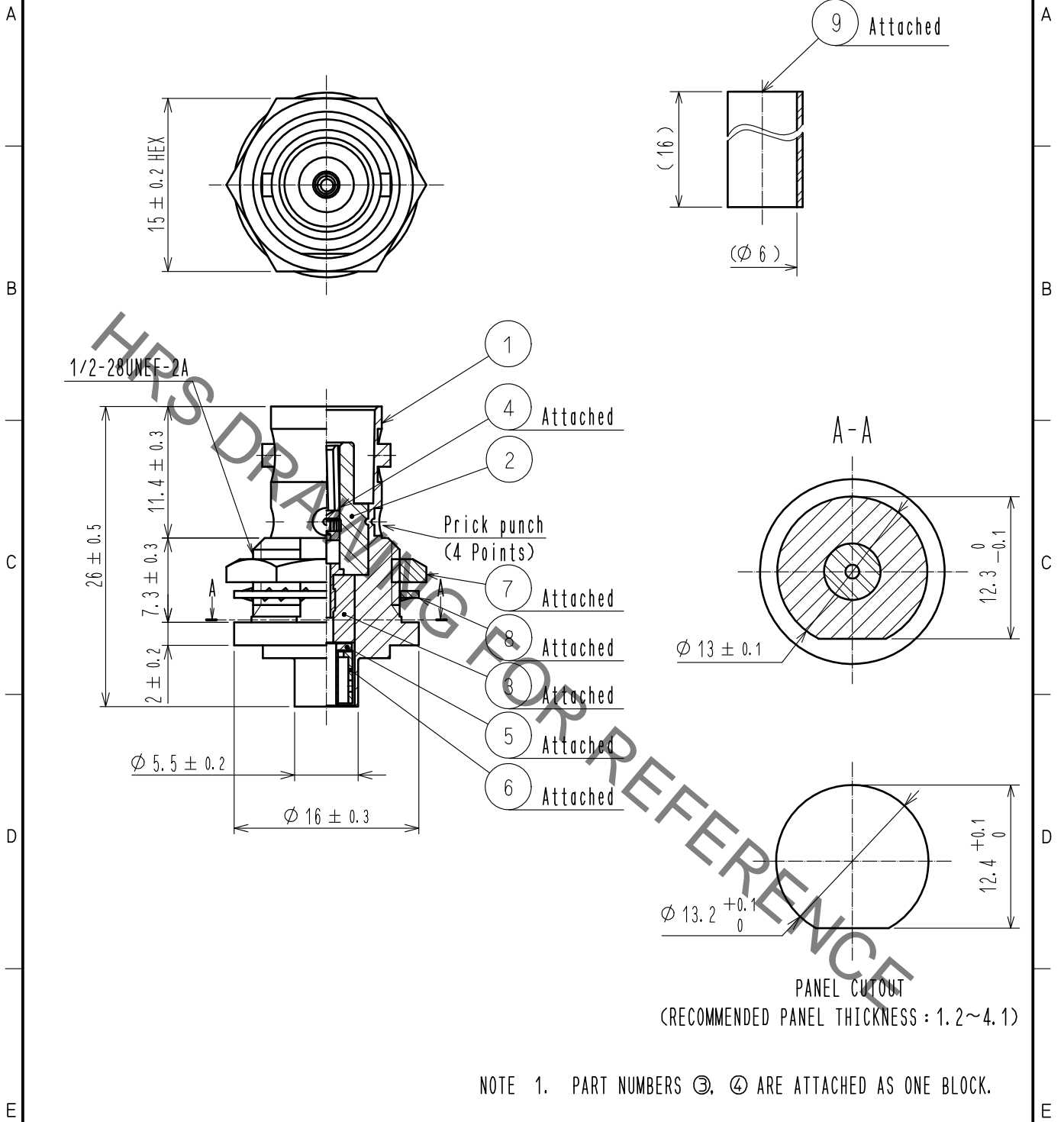

NOTE 1. PART NUMBERS ③, ④ ARE ATTACHED AS ONE BLOCK.

5	BRASS	NICKEL PLATING						
4	BERYLLIUM COPPER	GOLD PLATING	9	POLYOLEFIN	HEAT SHRINK TUBING			
3	PTFE		8	STEEL	NICKEL PLATING			
2	PTFE		7	BRASS	NICKEL PLATING			
1	BRASS	NICKEL PLATING	6	BRASS	NICKEL PLATING			
NO.	MATERIAL	FINISH .	REMARKS	NO.	MATERIAL	FINISH .	REMARKS	
UNITS mm		SCALE 2 : 1	COUNT 	DESCRIPTION OF REVISIONS		DESIGNED	CHECKED	DATE
HRS HIROSE ELECTRIC CO., LTD.	APPROVED	·NK. NINOMIYA	20211115	DRAWING NO.	EDC-304212-40-00			
	CHECKED	·NK. NINOMIYA	20211115	PART NO.	BNC-BPJ-1.5DW(40)			
	DESIGNED	·MT. KANEKO	20211112	CODE NO.	CL0302-0400-6-40			
	DRAWN	·NK. OOSHIMA	20211112		1/1			