

TECHNICAL DATA

Electrical

Current Rating: 3A maxi
 Dielectric withstanding: 1000V AC for one minute
 Insulation resistance: 5000MΩmini
 Contact resistance: 20mΩ max

Mechanical

Temperature rating: -40° to +105°C
 Soldering Temperature: 230°C/30-60 sec
 260°C/10 sec

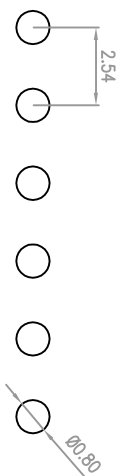
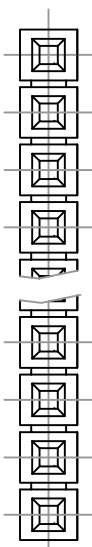
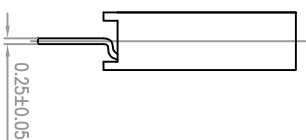
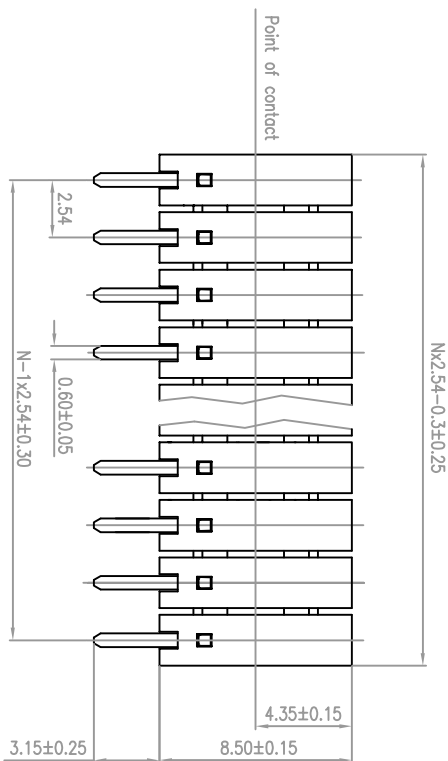

Recommended PCB Layout
 (PCB TOLERANCE ±0,05)

A	05-09-08	Update overall dimension, update number of contact, update PCB hole
INDEX	DATA	MODIFICA

KONTEK ELECTRONIC CONNECTORS MANUFACTURING		KONTEK ELECTRONIC CONNECTORS MANUFACTURING	
Denomination Female headers straight		Denomination Female headers straight	
pitch 2.54mm, single row.		pitch 2.54mm, single row.	
XX=N=Number of contacts (02÷45)		XX=N=Number of contacts (02÷45)	
Cod. 47782051XX4Y0	File: 47782051XX4Y0	Cod. 47782051XX4Y0	File: 47782051XX4Y0
Dis. Nr.		Dis. Nr.	
UNIT: mm general tolerance X: ±0.25mm XX: ±0.15mm		UNIT: mm general tolerance X: ±0.25mm XX: ±0.15mm	
Date 30-07-08	Date 30-07-08	Date 30-07-08	Date 30-07-08
Design Gambino L.	Design Gambino L.	Design Gambino L.	Design Gambino L.
Contr.	Contr.	Contr.	Contr.
KONTEK - Comatel		KONTEK - Comatel	
Note		Note	
Housing: LCP UL94V-0		Housing: LCP UL94V-0	
Contact: Phosphore bronze		Contact: Phosphore bronze	
Material		Material	
Platings Y= 4: TIN 4µm Y= 1: Gold flash		Platings Y= 4: TIN 4µm Y= 1: Gold flash	
Protection		Protection	
TOLERANCES FOR FREE DIMENSIONS		TOLERANCES FOR FREE DIMENSIONS	
ANGULAR VALUES	from 0.5° to 3°	> 3°	> 6°
	< 6°	< 10°	< 18°
	< 10°	< 18°	< 30°
	< 18°	< 30°	< 50°
	< 30°	< 50°	< 80°
	< 50°	< 80°	< 120°
	< 80°	< 120°	< 180°
	< 120°	< 180°	< 250°
	< 180°	< 250°	< 315°
	< 250°	< 315°	> 250°
	< 315°	> 250°	
± 30°	±0.125	±0.150	±0.180
	±0.180	±0.215	±0.250
	±0.310	±0.370	±0.435
	±0.500	±0.575	±0.650