

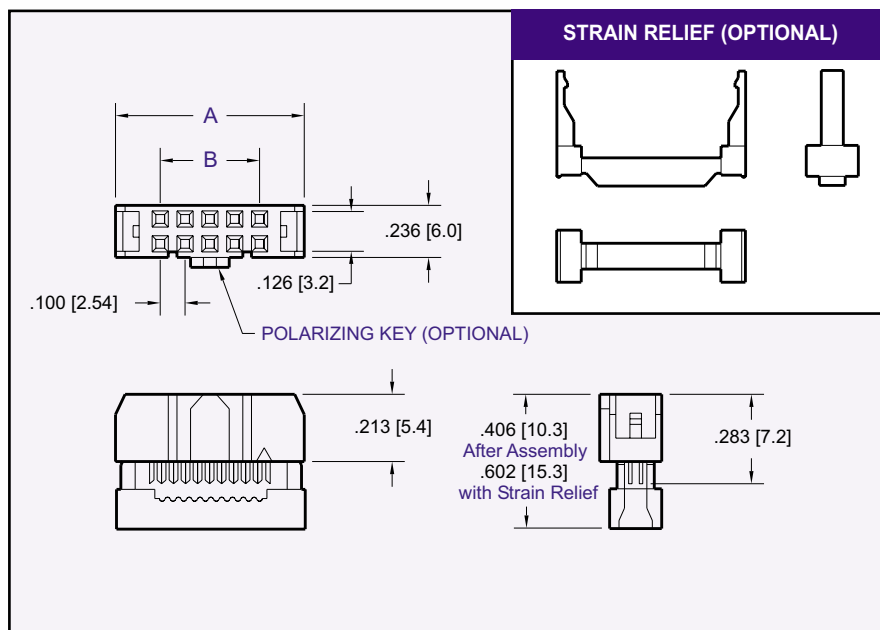

9200S Series IDC Flat Ribbon Cable Socket .100 [2.54]

Specifications

Insulator Material: Glass filled polyester, Type PBT, 94V-O, UL Recognized.
 Contact Material: Copper Alloy
 Contact Plating: Gold and/or Tin over .000050" Ni (See contact plating options).
 Insulation Resistance: 5000 M ohms min.
 Dielectric Withstand Voltage: 1000 VAC
 Contact Resistance: 20 m ohms max.
 Current Rating: 3 AMP
 Operating Temperature: -40°C To +105°C
 Recommended Cable: 26 or 28 AWG Flat Cable
 UL File Numbers: E146967 & E176234

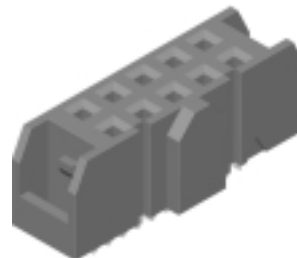

DIMENSIONS ARE IN INCHES & [MM]

CONTACTS	A	B
06	0.479 [12.16]	0.200 [05.08]
08	0.580 [14.74]	0.300 [07.62]
10	0.680 [17.27]	0.400 [10.16]
12	0.781 [19.85]	0.500 [12.70]
14	0.882 [22.40]	0.600 [15.24]
16	0.982 [24.94]	0.700 [17.78]
20	1.181 [30.00]	0.900 [22.86]
24	1.382 [35.10]	1.100 [27.94]
26	1.480 [37.59]	1.200 [30.48]
30	1.680 [42.66]	1.400 [35.56]
34	1.882 [47.80]	1.600 [40.64]
36	1.980 [50.29]	1.700 [43.18]
40	2.180 [55.37]	1.900 [48.26]
44	2.384 [60.56]	2.100 [53.34]
50	2.684 [68.18]	2.400 [60.96]
56	2.982 [75.74]	2.700 [68.58]
60	3.181 [80.80]	2.900 [73.66]
62	3.281 [83.35]	3.000 [76.20]
64	3.382 [85.90]	3.100 [78.74]

SUGGESTED MATING CONNECTOR	
93XX-BX-XX-XX	(PAGE F-42)
93XX-B3-XX-XX	(PAGE F-43)
93XX-B5-XX-XXX	(PAGE F-44)
92XX-XXX-XX	(PAGE F-51)

PART NUMBERING

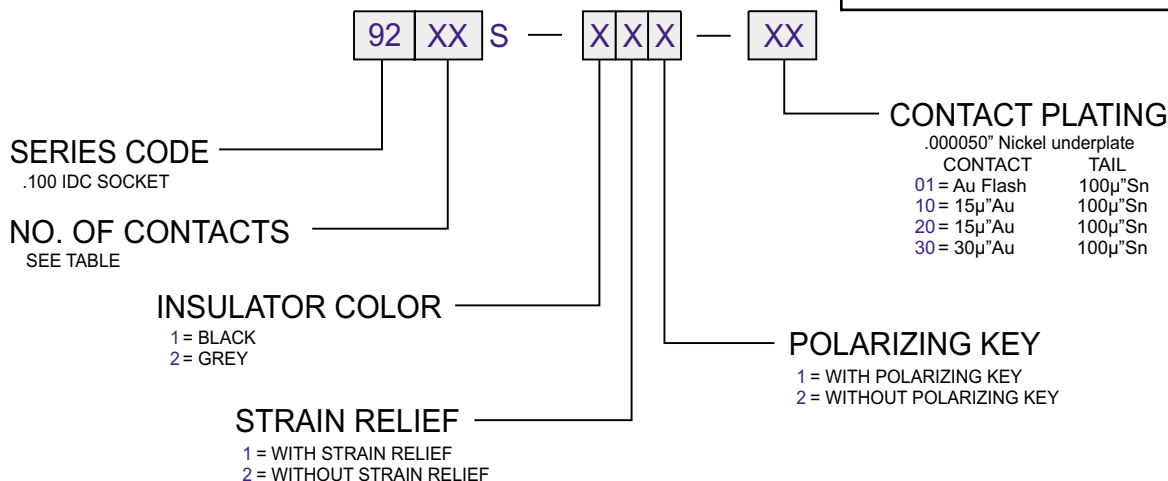

CONSULT FACTORY FOR CUSTOM CONNECTORS BUILT TO YOUR SPECIFICATION