

RoHS COMPLIANT

* Material: High-temperature materials, UL94V-0

* Contact : Brass

* Plating : Matte tin plated 80μ " min over 30μ " min. nickel overall

* Ordering information:

1252P**V0T*

1. NO. of circuits

2. Color: 0=Natural,1=Black,2=Brown,7=Blue

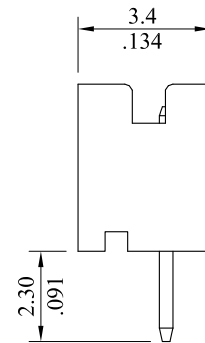
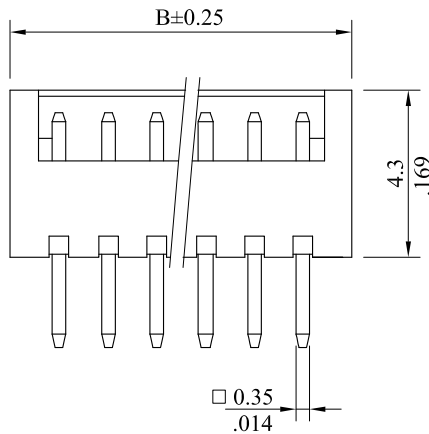
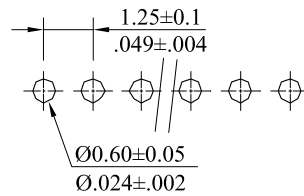
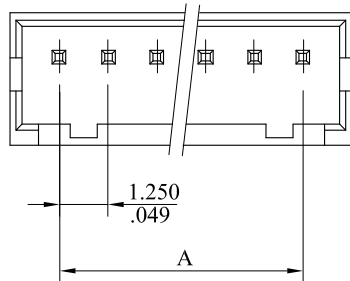

No. of circuits	DIM. A	DIM. B	No. of circuits	DIM. A	DIM. B
2	1.25(.049)	3.75(.148)	12	13.75(.541)	16.25(.640)
3	2.50(.098)	5.00(.197)	13	15.00(.591)	17.50(.689)
4	3.75(.148)	6.25(.246)	14	16.25(.640)	18.75(.738)
5	5.00(.197)	7.50(.295)	15	17.50(.689)	20.00(.787)
6	6.25(.246)	8.75(.344)	16	18.75(.738)	21.25(.837)
7	7.50(.295)	10.00(.394)	17	20.00(.787)	22.50(.886)
8	8.75(.344)	11.25(.443)	18	21.25(.837)	23.75(.935)
9	10.00(.394)	12.50(.492)	19	22.50(.886)	25.00(.984)
10	11.25(.443)	13.75(.541)	20	23.75(.935)	26.25(1.033)
11	12.50(.492)	15.00(.591)			

				LECO CORPORATION		APPROVED: CHARD DATE: 2015.08.04		PART NO.: 1252P**V0T*				
				GENERAL TOLERANCES: (UNLESS SPECIFIED)		CHECKED:		TITLE: HEADER				
						DATE:		DRAWING NO.: 125206S				
						DRAWN: AIMEE DATE: 2015.08.04						
DO								UNITS	SCALE	SIZE	SHEET	REV.
C	ES110629							mm	5:1	A4	1/1	D0
B	ES110507							inch				
A	DWG REL											
REV.	ECO. NO.	CHG.	APP.	ANGULAR ± (1°)								