

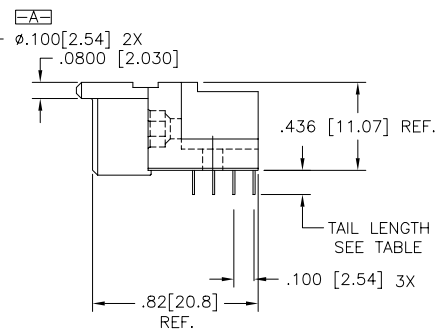

FCIconnect.com

Copyright FCI

PRODUCT NUMBER
SEE TABLE

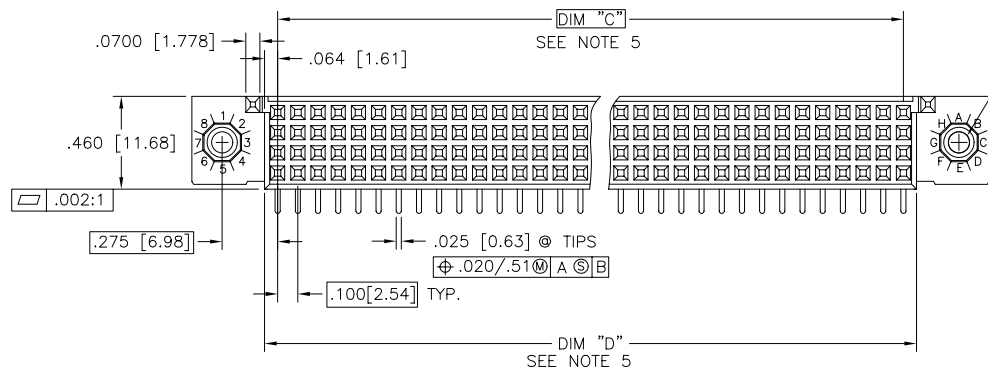
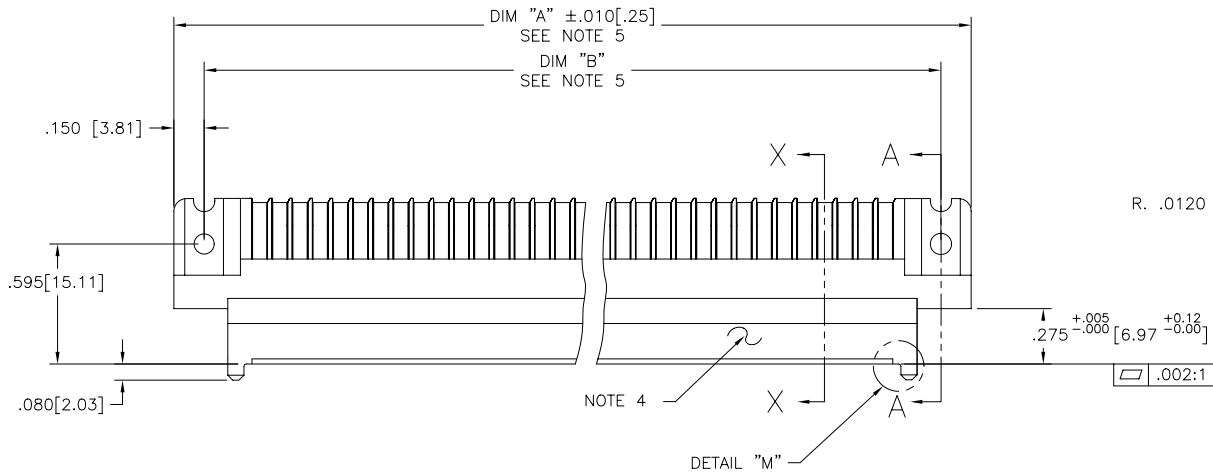

mat'l. code SEE NOTE 3		surface ISO 1302 <input checked="" type="checkbox"/>		tolerance ISO 406 ISO 1101		projection 		product family HPC	
ltr	ecm no	dr	date	tolerances unless otherwise specified		INCH/MM		title	
C	v40839	GIP	5/04/94	angles	linear	.xx $\pm 0.1/3$	4 ROW R/A RECEPTACLE		
D	v60781	GIP	5/16/96			.xxx $\pm 0.05/.13$	SOLDER TAIL W/NIBS, 0 G.P.		
E	v00293	JWS	2/07/00	$\sigma \pm 2'$.xxxx $\pm 0.020/.051$	scale 1:1		
F	v05-0969	DAI	10/25/05	dr	G. PETERS	9/19/93	dwg no		sheet 1 of 3 size
G	M06-0261	AEA	5/10/06	enr	S. CLARK	9/19/93	50736		A3
				chr	S. CLARK	12/13/93	type		Product Customer Drawing
				appd	S. CLARK	12/14/93			
sheet index	revision sheet	G	G	G	G	G			
		1	2	3					

form: A3

PRODUCT NUMBER
SEE TABLE

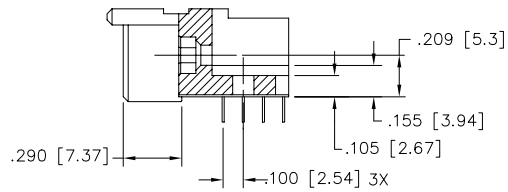

SECTION A-A

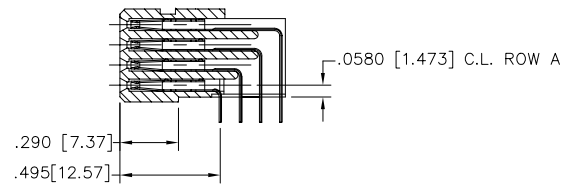

SECTION X-X

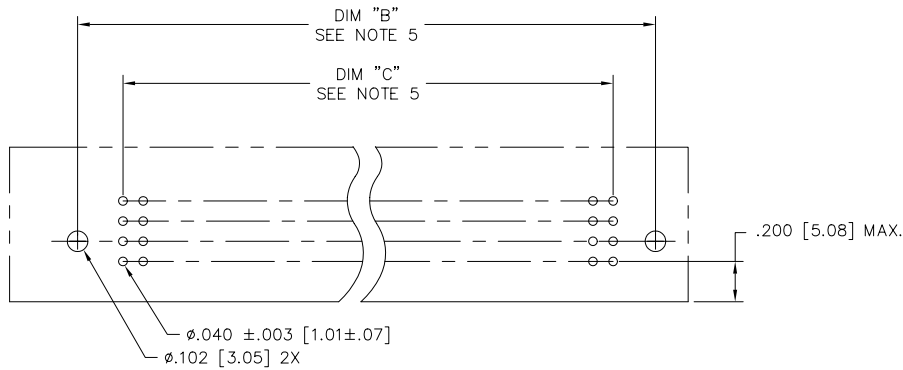

RECOMMENDED PCB LAYOUT
ALL HOLES LOCATED ON .100[2.54] GRID
UNLESS OTHERWISE SPECIFIED.

mat'l. code SEE NOTE 3		surface ISO 1302 ✓		tolerance ISO 406 ISO 1101		projection ⊕		product family HPC	
ltr	ecn	no	dr	date		tolerances unless otherwise specified		title	
G						angles	linear	.xx ±.01/.3 .xxx ±.005/.13 .xxxx ±.0020/.051	INCH/MM
						σ±2'		scale 1:1	
				dr		G. PETERS		9/19/93	
				enr		S. CLARK		9/19/93	
				chr		S. CLARK		12/13/93	
				appd		S. CLARK		12/14/93	
sheet		revision							
index		sheet							



Copyright FCJ

PRODUCT NUMBER	NUMBER OF POSITIONS, NOTE 2	SOLDER TAIL TAIL LENGTH	PLATING	CONTACT AREA PLATING
50736-1YYYYE	YYY	.125±.010/3.18±.25	TIN-LEAD	30μ"/.76μ GOLD
50736-1YYYYF	YYY	.145±.010/3.68±.25	TIN-LEAD	30μ"/.76μ GOLD
50736-1YYYYH	YYY	.180±.010/4.57±.25	TIN-LEAD	30μ"/.76μ GOLD
50736-3YYYYE	YYY	.125±.010/3.18±.25	TIN-LEAD	50μ"/1.25μ GOLD
50736-3YYYYF	YYY	.145±.010/3.68±.25	TIN-LEAD	50μ"/1.25μ GOLD
50736-3YYYYH	YYY	.180±.010/4.57±.25	TIN-LEAD	50μ"/1.25μ GOLD
50736-5YYYYE	YYY	.125±.010/3.18±.25	TIN-LEAD	30μ"/.76μ GXT
50736-5YYYYELF	YYY	.125±.010/3.18±.25	TIN	30μ"/.76μ GXT
50736-5YYYYF	YYY	.145±.010/3.68±.25	TIN-LEAD	30μ"/.76μ GXT
50736-5YYYYFLF	YYY	.145±.010/3.68±.25	TIN	30μ"/.76μ GXT
50736-5YYYYH	YYY	.180±.010/4.57±.25	TIN-LEAD	30μ"/.76μ GXT
50736-5YYYYHLF	YYY	.180±.010/4.57±.25	TIN	30μ"/.76μ GXT

NOTES:

- ① PRODUCT DESCRIPTION CODE:
 50736 - X YYY Z LF
 LEAD FREE (OPTIONAL)
 TAIL LENGTH SEE TABLE
 NO. OF POSITIONS SEE NOTE 2
 PLATING SEE TABLE
 BASE NUMBER
- ② THIS PRODUCT IS CONFIGURED IN SIZES OF 6 THRU 80 COLUMNS IN INCREMENTS OF ONE.
 i.e. 6,7,8,9.....79,80.
- ③ MATERIALS:
 HOUSING - GLASS AND MINERAL FILLED
 HIGH TEMP. THERMOPLASTIC, FLAME RETARDANT
 PER UL94V-0. COLOR: BLACK.
 PINS - PHOS BRONZE
- ④ MANUFACTURE'S NAME, P/N, & LOT CODE TO APPEAR ON THIS SURFACE PER BUS-12-108.

- ⑤ LENGTH FORMULAS
 DIM "A" = .100/2.54 x NO. OF COLUMNS + .750/19.05
 DIM "B" = .100/2.54 x NO. OF COLUMNS + .450/11.43
 DIM "C" = .100/2.54 x NO. OF COLUMNS - .10/2.5
 DIM "D" = .100/2.54 x NO. OF COLUMNS + .028/71
- 6. THIS PRODUCT (WITH "LF") MEETS EUROPEAN UNION DIRECTIVES AND OTHER COUNTRY REGULATIONS AS DESCRIBED IN GS-22-008.
- 7. THIS HOUSING WILL WITHSTAND EXPOSURE TO 260° C PEAK TEMPERATURE FOR 10-30 SECONDS IN A CONVECTION, INFRA-RED OR VAPOR PHASE REFLOW OVEN.

FCJ
 FCJconnect.com
 Copyright FCJ

mat'l. code SEE NOTE 3		surface ISO 1302 ✓	tolerance ISO 406 ISO 1101	projection 	product family HPC
ltr	ecn	no	dr	date	tolerances unless otherwise specified
G					angles linear
					.xx ±.01/.3 .xxx ±.005/.13 .xxxx ±.0020/.051
					dr G. PETERS 9/19/93 enr S. CLARK 9/19/93 chr S. CLARK 12/13/93 appd S. CLARK 12/14/93
sheet index	revision sheet				
				title 4 ROW R/A RECEPTACLE SOLDER TAIL W/NIBS, 0 G.P. scale 1:1 dwg no 50736 sheet 3 of 3 size A3 type Product Customer Drawing	