

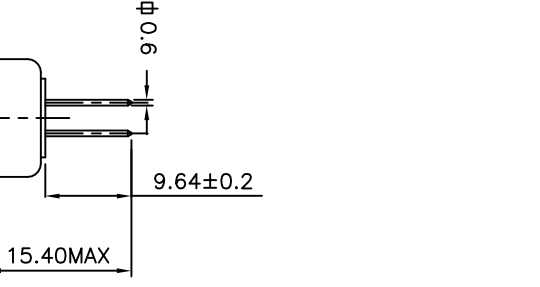

A

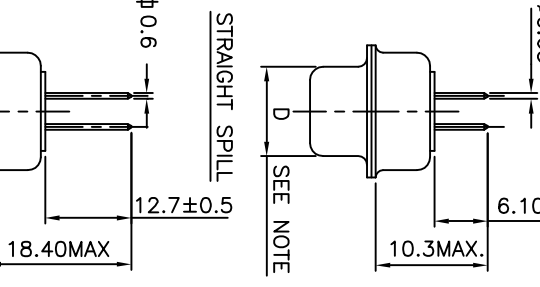

B

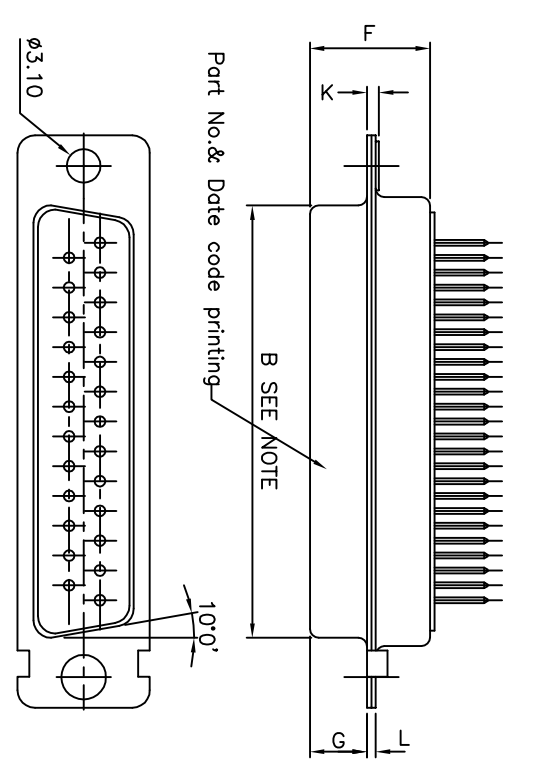
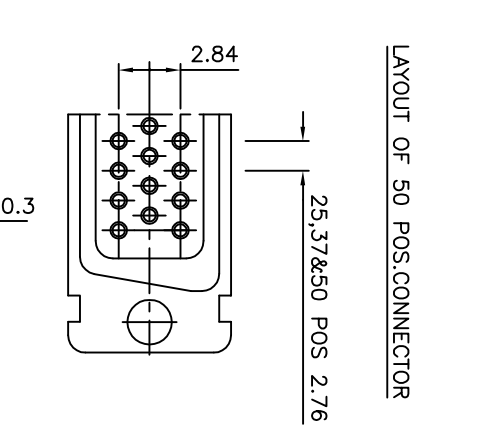
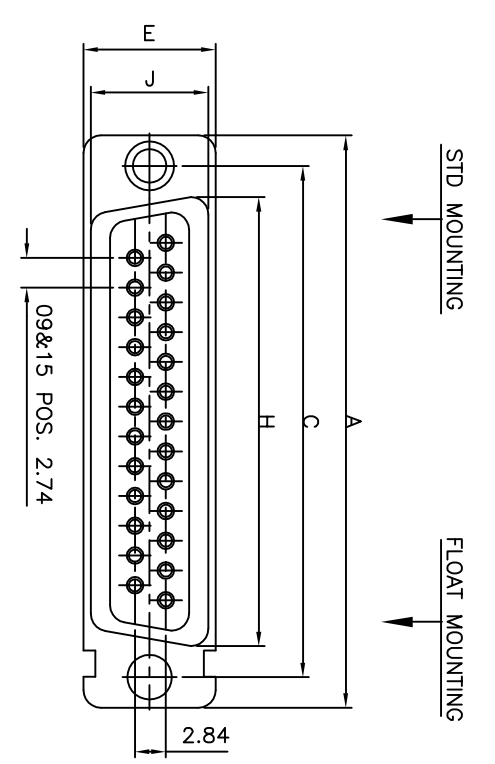
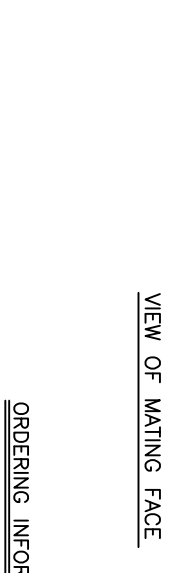

ORDERING INFORMATION

SERIES: D B P V 25 P 3 64 C T X XXX LF

SHELL SIZE: E,A,B,C,D

CHARACTERISATION: M-DM SERIES, P-DP SERIES

OPTIONS: BLANK-STANDARD, F-FLOAT MOUNTING, V-FEM. SCREW LOCK HEX. (UNC), W-RIVETED FEM. SCREW LOCK ROUND UNC, N-THREADED FEM. SCREW LOCK M3, L-CLINCH NUT (M3), O-CLINCH NUT (UNC), S-SPACER RIVETED TO SHELL (S/S ONLY), NO.OF CONTACTS: 09,15,25,37,50

CONTACTS: P - PIN, S - SOCKET

TERMINATION TYPE: 3-STRAIGHT SPILL, 4-WIRE WRAP TERMINATION 12.70MM, 6-WIRE WRAP TERMINATION 9.64MM

LEAD FREE

SPECIAL CODES

DIMPLES- OPTIONAL

X-ON MALE CONNECTORS ONLY

SHELL PLATING

BLANK-ZINC for DP/CDMILM for DM

T-STD. TIN over Cu or Zinc Cr-3

OPTIONS: BLANK-STANDARD, H-SHIELDING TERMINATION FINGERS, G-HARPOON, M-METAL BRACKET, C-WITHOUT BRACKET, N-OBLIGATORY FOR DM

CONTACT PLATING: BLANK - 0.2 µAu, 64 - Au FLASH, 65 - 0.75 µAu, 67 - 0.4 µAu, 32 - 1.27 µAu (APPLICABLE FOR DM SERIES ONLY)

D

form: A3

1

2

3

1

2 3

4

5

6

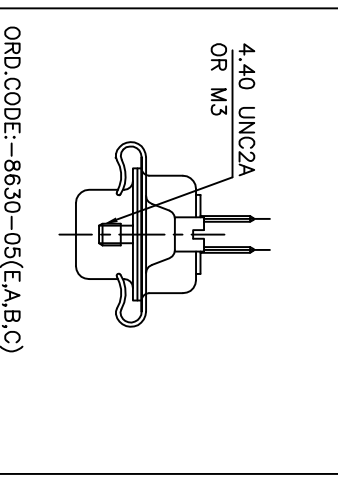

ORD.CODE:-8630-05(E,A,B,C)
ORD.CODE:-8630-03 D/SHELL FEMALE.
ORD.CODE:-8630-15 D/SHELL MALE.
ORD.CODE:-8630-04 E,A,B,C SHELL.
WITH METAL HOOD.
FOR 4.40UNC THREAD ADD 'N' TO THE CORRESPONDING ORD.CODE.

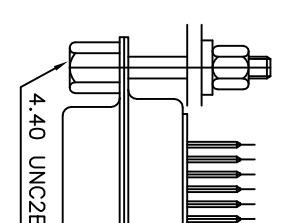

ORD.CODE:-8630-01-062

SPACERS RIVETED TO SHELL

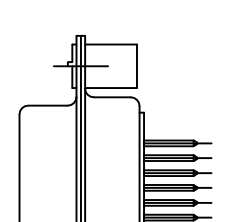

PREFIX:-S

NOTE:-INSIDE DIMENSIONS OF MALE AND OUTSIDE DIMENSIONS OF THE FEMALE CONNECTOR.

| SIZE | P | S | P | S | P | S | P | S | P | S | P | S | P | S | P | S | P | S | P | S | | |
|------|-------|-------|-------|-------|-------|-------|------|-------|-------|------|-----|-------|-------|-------|------|-------|-------|------|-------|-------|------|-----|
| 50 | 66.65 | 52.30 | 61.11 | 11.08 | 14.99 | 11.09 | 5.85 | 56.07 | 13.31 | 1.50 | 1.0 | 68.94 | 55.30 | 63.50 | 8.23 | 12.17 | 11.09 | 5.85 | 57.45 | 10.46 | 1.50 | 1.0 |
| 37 | 68.94 | 54.71 | 63.50 | 7.77 | 12.17 | 11.21 | 6.05 | 57.45 | 10.46 | 1.10 | 0.8 | 52.65 | 38.84 | 47.04 | 8.23 | 12.17 | 11.07 | 5.85 | 41.02 | 10.46 | 1.10 | 0.8 |
| 25 | 52.65 | 38.25 | 47.04 | 7.77 | 12.17 | 11.21 | 6.05 | 41.02 | 10.46 | 1.10 | 0.8 | 38.76 | 25.12 | 33.32 | 8.23 | 12.17 | 10.99 | 5.85 | 27.25 | 10.46 | 1.10 | 0.8 |
| 15 | 38.76 | 24.54 | 33.32 | 7.77 | 12.17 | 11.21 | 6.05 | 27.25 | 10.46 | 1.10 | 0.8 | 30.43 | 16.79 | 24.99 | 8.23 | 12.17 | 10.99 | 5.85 | 19.02 | 10.46 | 1.10 | 0.8 |
| 09 | 30.43 | 16.21 | 24.99 | 7.77 | 12.17 | 11.21 | 6.05 | 19.02 | 10.46 | 1.10 | 0.8 | | | | | | | | | | | |

TECHNICAL SPECIFICATIONS

SHELLS : TIN/CADMIUM/ZINC PLATED STEEL

INSULATOR MATERIAL : SELF EXTINGUISHING THERMOPLASTIC- TO UL CLASS 94 V0

CONTACTS DIA ON ACTIVE AREA : Ø1 MM.

CONTACTS MATERIAL : COPPER ALLOY

CONTACT PLATING : GOLD OVER NICKEL

OPERATING TEMPERATURE : -55°C +125°C

OPERATING CURRENT : 7.5 A PER CONTACT

CONTACT RESISTANCE : <7.3 mΩ

INSULATION RESISTANCE : >5000 MΩ

MAXIMUM VOLTAGE : 1000 V.r.m.s

MECHANICAL ENDURANCE : 500 MATINGS FOR >0.75µ GOLD PLATING

DAMP HEAT : 200 MATINGS FOR <0.40µ GOLD PLATING

56 DAYS FOR >0.75µ GOLD PLATING

21 DAYS FOR <0.40µ GOLD PLATING

"This LF product meets European Union Directives and other country regulations as described in GS-22-008"

The housing will withstand exposure to 260°C peak temperature for 3.5 seconds in a wave solder application with a 1.6mm minimum thick circuit board.

Pckaging as per GS-14-920

| mat'l. code | SEE NOTE 4 | surface | tolerance | projection | product family |
|-------------|----------------|------------|---------------------------------------|------------|--|
| ltr | ecn no dr | date | tolerances unless otherwise specified | MM | D-SUB |
| F | 106-0074 GVJ | 2006-06-08 | | | D-SUB S/S,W/W CONNECTOR |
| G | 108-0047 AMR | 2008-03-25 | | | (DP & DM SERIES WITH ASSEMBLY OPTIONS) |
| sheet index | revision sheet | 1 | | | |



dwg no sheet 1 of 1 size A3

type Product Customer Drawing