

PRODUCT NUMBER  
10082202-YXX-XXLF

PLATING

1= 0.76µm GOLD/GXT ON CONTACT AREA, 2µm TIN MIN ON TAILS

4= 2.0µm TIN MIN FULL PLATED

5= 0.25µm GOLD/GXT ON CONTACT AREA, 2µm TIN MIN ON TAILS

8= 0.38µm GOLD/GXT ON CONTACT AREA, 2µm TIN MIN ON TAILS

1.27µm NICKEL MIN UNDERLAYER FOR ALL PLATING VERSIONS

LEAD FREE, RoHS COMPATIBLE  
SEE NOTE 7

TOTAL NB OF POSITIONS  
04 TO 72

PACKAGING NOTE 3.

| PIN STYLE | DIM "B" | MATING SIDE |
|-----------|---------|-------------|
| 01        | 2.50    | 5.84        |
| 02        | 2.50    | 6.75        |
| 03        | 3.00    | 5.84        |
| 04        | 3.00    | 6.75        |

NOTES:

1. HOUSING MAT'L : HIGH TEMPERATURE THERMOPLASTIC. UL94V-0 COLOR: BLACK

2. PIN MATERIAL : PHOSPHOR BRONZE

3. PACKAGING :

- = POLY BAGS

A = TAPE & REEL WITH CAP, SEE TA840 FOR PRODUCT AVAILABILITY.

PICK-UP CAP 90° ROTATED FOR ODD NB OF CONTACTS ON PER ROW

4. 9N MIN RETENTION IN EITHER DIRECTION

5. TO DETERMINE DIMENSIONS :  
N = NUMBER OF POSITIONS PER ROW  
EXAMPLE : 8 POS N x 2.54 = 20.32mm

6. UNDERPLATING : 1.27µm Ni MIN

7. RoHS COMPATIBLE PRODUCT SPECIFICATIONS

a - PLATING:

- "LF" MEANS THE PRODUCT IS LEAD-FREE, 2µm MINIMUM MATTE TIN OVER 1.27µm MINIMUM NICKEL UNDERPLATE.

b - MANUFACTURING PROCESS COMPATIBILITY

- THE HOUSING WILL WITHSTAND EXPOSURE TO 260°C PEAK TEMP FOR 30 SECONDES IN A CONVECTION, INFRARED, OR VAPOR REFLOW OVEN

c - LABELING:

- MEETS PACKAGING SPECS AS PER GS-14-920

d - LEGAL STATEMENT: SEE GS-47-0004

0.62 SQUARE

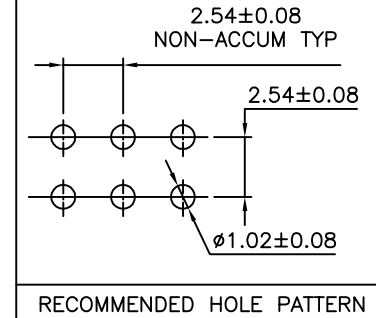
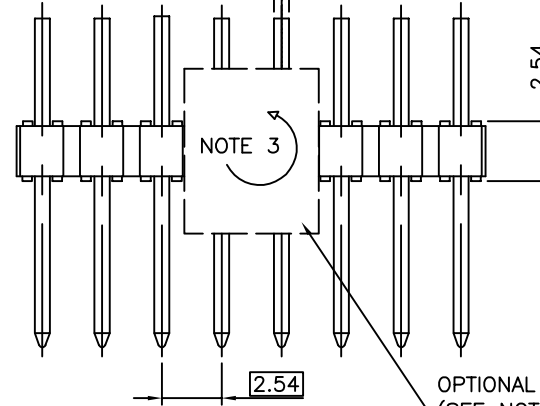

OPTIONAL PICK-UP CAP  
(SEE NOTE 3)

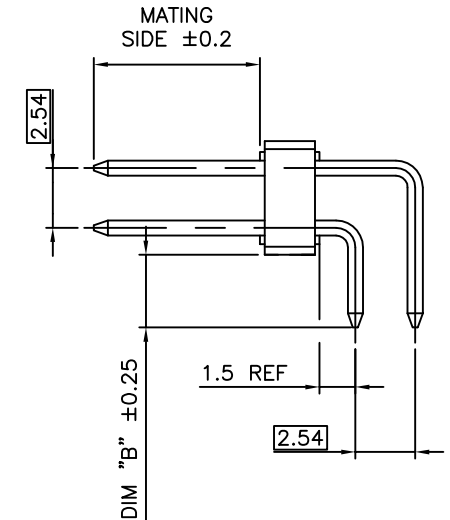
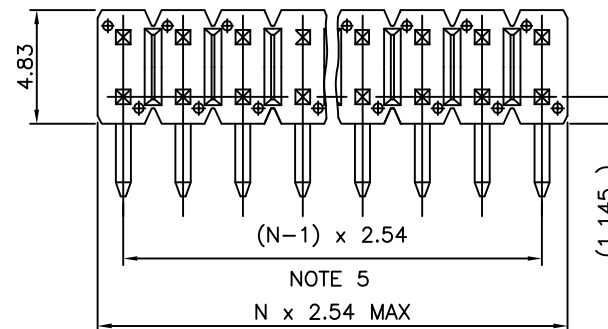

|                          |                |                     |                               |                                       |   |
|--------------------------|----------------|---------------------|-------------------------------|---------------------------------------|---|
| mat'l. code<br>SEE NOTES |                | surface<br>ISO 1302 | tolerance<br>ISO 406 ISO 1101 | projection<br>mm                      | product family<br>BERGSTIK                    |
| ltr                      | ecn no         | dr                  | date                          | tolerances unless otherwise specified | title   |
| A                        | F08-0104       | LMU                 | 08.01.15                      | angles .X ±0.3                        | UNSHR.HEADER<br>RA DR PIN IN PASTE            |
| B                        | F08-0129       | LMU                 | 08.02.22                      | linear .XX ±0.015                     |   |
| C                        | F09-0072       | JCO                 | 09.07.23                      | .XXX ±0.05                            | scale 5:1                                     |
| D                        | B-18990        | LMU                 | 14.10.06                      | dr L.MULIN 08.01.15                   | dwg no<br>10082202<br>sheet 1 of 1 size<br>A3 |
|                          |                |                     |                               | engr J.COMPAGNON 08.01.15             |   |
|                          |                |                     |                               | chr appd J.M.C 08.01.15               |   |
| sheet index              | revision sheet |                     |                               |                                       | type<br>CUSTOMER Drawing                      |