

KSC1008

Low Frequency Amplifier Medium Speed Switching

- Complement to KSA708
- High Collector-Base Voltage : $V_{CBO}=80V$
- Collector Current : $I_C=700mA$
- Collector Power Dissipation : $P_C=800mW$
- Suffix "-C" means Center Collector (1. Emitter 2. Collector 3. Base)

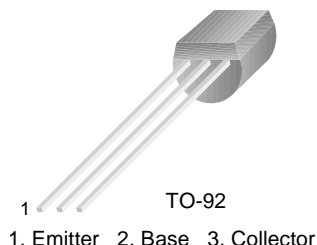

NPN Epitaxial Silicon Transistor

Absolute Maximum Ratings $T_a=25^\circ C$ unless otherwise noted

| Symbol | Parameter | Ratings | Units |
|-----------|-----------------------------|-----------|------------|
| V_{CBO} | Collector-Base Voltage | 80 | V |
| V_{CEO} | Collector-Emitter Voltage | 60 | V |
| V_{EBO} | Emitter-Base Voltage | 8 | V |
| I_C | Collector Current | 700 | mA |
| P_C | Collector Power Dissipation | 800 | mW |
| T_J | Junction Temperature | 150 | $^\circ C$ |
| T_{STG} | Storage Temperature | -55 ~ 150 | $^\circ C$ |

Electrical Characteristics $T_a=25^\circ C$ unless otherwise noted

| Symbol | Parameter | Test Condition | Min. | Typ. | Max. | Units |
|---------------|--------------------------------------|-----------------------------|------|------|------|---------|
| BV_{CBO} | Collector-Base Breakdown Voltage | $I_C=100\mu A, I_E=0$ | 80 | | | V |
| BV_{CEO} | Collector-Emitter Breakdown Voltage | $I_C=10mA, I_B=0$ | 60 | | | V |
| BV_{EBO} | Emitter-Base Breakdown Voltage | $I_E=10\mu A, I_C=0$ | 8 | | | V |
| I_{CBO} | Collector Cut-off Current | $V_{CB}=60V, I_E=0$ | | | 0.1 | μA |
| I_{EBO} | Emitter Cut-off Current | $V_{EB}=5V, I_C=0$ | | | 0.1 | μA |
| h_{FE} | DC Current Gain | $V_{CE}=2V, I_C=50mA$ | 40 | | 400 | |
| $V_{CE(sat)}$ | Collector-Emitter Saturation Voltage | $I_C=500mA, I_B=50mA$ | | 0.2 | 0.4 | V |
| $V_{BE(sat)}$ | Base-Emitter Saturation Voltage | $I_C=500mA, I_B=50mA$ | | 0.86 | 1.1 | V |
| f_T | Current Gain Bandwidth Product | $V_{CE}=10V, I_C=50mA$ | 30 | 50 | | MHz |
| C_{ob} | Output Capacitance | $V_{CB}=10V, I_E=0, f=1MHz$ | | 8 | | pF |

h_{FE} Classification

| Classification | R | O | Y | G |
|----------------|---------|----------|-----------|-----------|
| h_{FE} | 40 ~ 80 | 70 ~ 140 | 120 ~ 240 | 200 ~ 400 |

Typical Characteristics

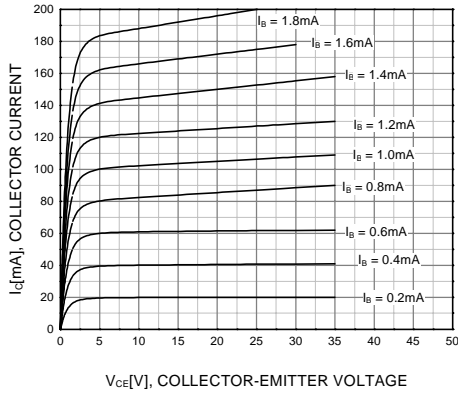

Figure 1. Static Characteristic

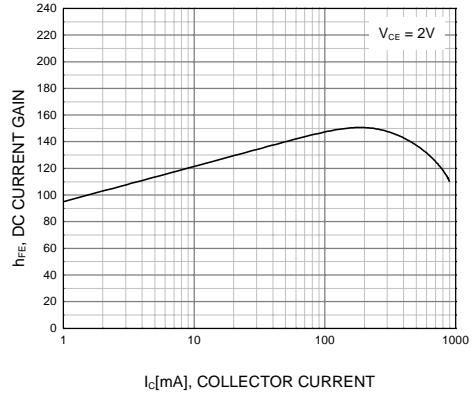

Figure 2. DC current Gain

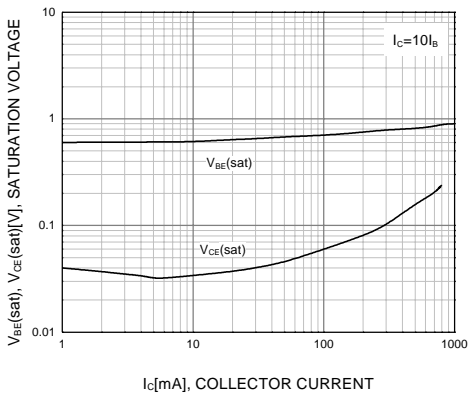

Figure 3. Base-Emitter Saturation Voltage
Collector-Emitter Saturation Voltage

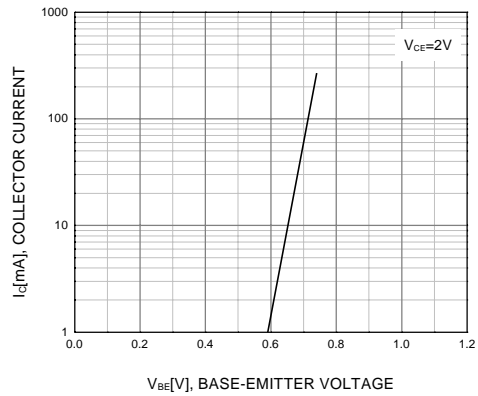

Figure 4. Base-Emitter On Voltage

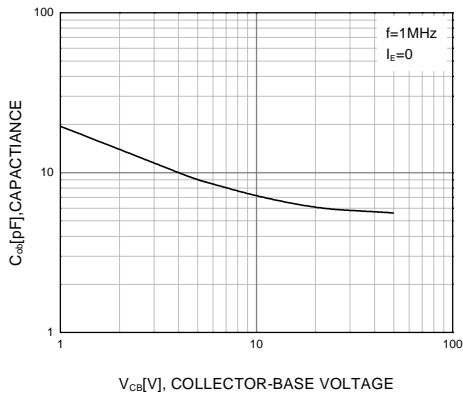
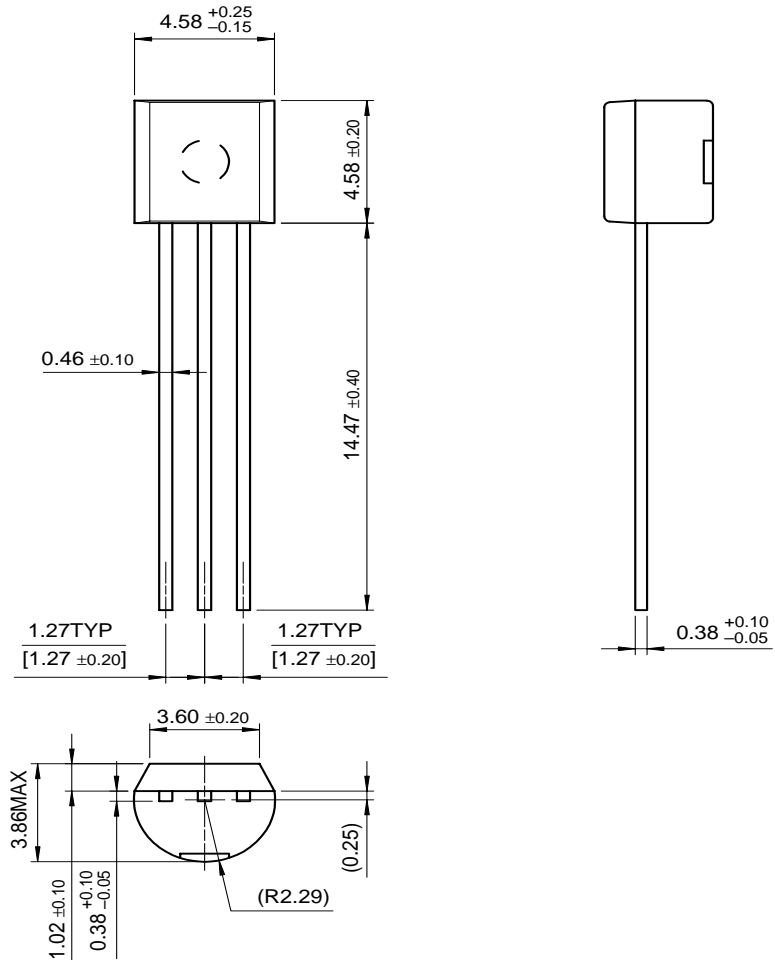

Figure 5. Collector Output Capacitance

Package Dimensions

KSC1008

TO-92



Dimensions in Millimeters

TRADEMARKS

The following are registered and unregistered trademarks Fairchild Semiconductor owns or is authorized to use and is not intended to be an exhaustive list of all such trademarks.

| | | | | |
|-----------------------------------|----------------------------------|----------------------------------|------------------------------|-------------------|
| ACE _x TM | FAST [®] | OPTOLOGIC TM | SMART START TM | VCX TM |
| Bottomless TM | FAST _r TM | OPTOPLANAR TM | STAR*POWER TM | |
| CoolFET TM | FRFET TM | PACMAN TM | Stealth TM | |
| CROSSVOLT TM | GlobalOptoisolator TM | POP TM | SuperSOT TM -3 | |
| DenseTrench TM | GTO TM | Power247 TM | SuperSOT TM -6 | |
| DOMET TM | HiSeC TM | PowerTrench [®] | SuperSOT TM -8 | |
| EcoSPARK TM | ISOPLANAR TM | QFET TM | SyncFET TM | |
| E ² CMOS TM | LittleFET TM | QS TM | TruTranslation TM | |
| EnSigna TM | MicroFET TM | QT Optoelectronics TM | TinyLogic TM | |
| FACT TM | MicroPak TM | Quiet Series TM | UHC TM | |
| FACT Quiet Series TM | MICROWIRE TM | SLIENT SWITCHER [®] | UltraFET [®] | |

STAR*POWER is used under license

DISCLAIMER

FAIRCHILD SEMICONDUCTOR RESERVES THE RIGHT TO MAKE CHANGES WITHOUT FURTHER NOTICE TO ANY PRODUCTS HEREIN TO IMPROVE RELIABILITY, FUNCTION OR DESIGN. FAIRCHILD DOES NOT ASSUME ANY LIABILITY ARISING OUT OF THE APPLICATION OR USE OF ANY PRODUCT OR CIRCUIT DESCRIBED HEREIN; NEITHER DOES IT CONVEY ANY LICENSE UNDER ITS PATENT RIGHTS, NOR THE RIGHTS OF OTHERS.

LIFE SUPPORT POLICY

FAIRCHILD'S PRODUCTS ARE NOT AUTHORIZED FOR USE AS CRITICAL COMPONENTS IN LIFE SUPPORT DEVICES OR SYSTEMS WITHOUT THE EXPRESS WRITTEN APPROVAL OF FAIRCHILD SEMICONDUCTOR CORPORATION.

As used herein:

1. Life support devices or systems are devices or systems which, (a) are intended for surgical implant into the body, or (b) support or sustain life, or (c) whose failure to perform when properly used in accordance with instructions for use provided in the labeling, can be reasonably expected to result in significant injury to the user.
2. A critical component is any component of a life support device or system whose failure to perform can be reasonably expected to cause the failure of the life support device or system, or to affect its safety or effectiveness.

PRODUCT STATUS DEFINITIONS

Definition of Terms

| Datasheet Identification | Product Status | Definition |
|--------------------------|------------------------|---|
| Advance Information | Formative or In Design | This datasheet contains the design specifications for product development. Specifications may change in any manner without notice. |
| Preliminary | First Production | This datasheet contains preliminary data, and supplementary data will be published at a later date. Fairchild Semiconductor reserves the right to make changes at any time without notice in order to improve design. |
| No Identification Needed | Full Production | This datasheet contains final specifications. Fairchild Semiconductor reserves the right to make changes at any time without notice in order to improve design. |
| Obsolete | Not In Production | This datasheet contains specifications on a product that has been discontinued by Fairchild semiconductor. The datasheet is printed for reference information only. |

Fairchild Semiconductor

SEARCH | [Parametric](#) | [Cross Reference](#)[space](#)[Product Folders and](#)[Applies](#)

find products

[Home >> Find products >>](#)[Products groups](#)[Analog and Mixed](#)[Signal](#)[Discrete](#)[Interface](#)[Logic](#)[Microcontrollers](#)[Non-Volatile](#)[Memory](#)[Optoelectronics](#)[Markets and](#)[applications](#)[New products](#)[Product selection and](#)[parametric search](#)[Cross-reference](#)[search](#)

KSC1008

NPN Epitaxial Silicon Transistor

Contents

[Features](#) | [Applications](#) | [Product status/pricing/packaging](#)

Features

- Complement to KSA708
- High Collector-Base Voltage : $V_{CBO}=80V$
- Collector Current : $I_C=700mA$
- Collector Dissipation : $P_C=800mW$
- Suffix "-C" means Center Collector (1. Emitter 2. Collector 3. Base)

Datasheet

[Download this datasheet](#)[PDF](#)[e-mail this datasheet](#)[\[E-](#)

This page

[Print version](#)

Related Links

[Request samples](#)[How to order products](#)[Product Change Notices \(PCNs\)](#)[Support](#)[Distributor and field sales representatives](#)[Quality and reliability](#)[Design tools](#)[technical information](#)[buy products](#)[technical support](#)[my Fairchild](#)[company](#)[back to top](#)

Applications

Low Frequency Amplifier Medium Speed Switching[back to top](#)

Product status/pricing/packaging

| Product | Product status | Pricing* | Package type | Leads | Packing method |
|-------------|-----------------|----------|-----------------------|-------|----------------|
| KSC1008YTA | Full Production | \$0.058 | TO-92 | 3 | TAPE REEL |
| KSC1008CYBU | Full Production | \$0.058 | TO-92 | 3 | BULK |
| KSC1008OBU | Full Production | \$0.058 | TO-92 | 3 | BULK |
| KSC1008CYTA | Full Production | \$0.058 | TO-92 | 3 | TAPE REEL |
| KSC1008GTA | Full Production | \$0.058 | TO-92 | 3 | TAPE REEL |
| KSC1008RBU | Full Production | \$0.058 | TO-92 | 3 | BULK |
| KSC1008GBU | Full Production | \$0.058 | TO-92 | 3 | BULK |
| KSC1008YBU | Full Production | \$0.058 | TO-92 | 3 | BULK |

| | | | | | |
|-------------|-----------------|---------|-----------------------|---|-----------|
| KSC1008COBU | Full Production | \$0.058 | TO-92 | 3 | BULK |
| KSC1008COTA | Full Production | \$0.058 | TO-92 | 3 | TAPE REEL |
| KSC1008YTF | Full Production | \$0.058 | TO-92 | 3 | TAPE REEL |
| KSC1008OTA | Full Production | \$0.058 | TO-92 | 3 | TAPE REEL |
| KSC1008RTA | Full Production | \$0.058 | TO-92 | 3 | TAPE REEL |

* 1,000 piece Budgetary Pricing

[back to top](#)

[Home](#) | [Find products](#) | [Technical information](#) | [Buy products](#) |
[Support](#) | [Company](#) | [Contact us](#) | [Site index](#) | [Privacy policy](#)

© Copyright 2002 Fairchild Semiconductor