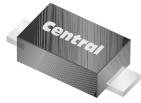

CMMR1 SERIES

**SURFACE MOUNT SILICON
GENERAL PURPOSE RECTIFIERS
1 AMP, 200 THRU 1000 VOLT**

**SOD-123F CASE**www.centrasemi.com**DESCRIPTION:**

The CENTRAL SEMICONDUCTOR CMMR1 Series of High Current Density Rectifiers, in a SOD-123F surface mount package are designed for all types of commercial, industrial computer and automotive applications.

**MARKING CODE: SEE MARKING CODE TABLE
ON FOLLOWING PAGE**

MAXIMUM RATINGS: ($T_A=25^\circ\text{C}$ unless otherwise noted)

| | SYMBOL | CMMR1-02 | CMMR1-04 | CMMR1-06 | CMMR1-10 | UNITS |
|--|----------------|----------|-------------|----------|----------|--------------------|
| Peak Repetitive Reverse Voltage | V_{RRM} | 200 | 400 | 600 | 1000 | V |
| DC Blocking Voltage | V_R | 200 | 400 | 600 | 1000 | V |
| RMS Reverse Voltage | $V_{R(RMS)}$ | 140 | 280 | 420 | 700 | V |
| Average Forward Current ($T_L=75^\circ\text{C}$) | I_O | | 1.0 | | | A |
| Peak Forward Surge Current (8.3ms) | I_{FSM} | | 30 | | | A |
| Operating and Storage Junction Temperature | T_J, T_{stg} | | -65 to +150 | | | $^\circ\text{C}$ |
| Thermal resistance (Note 1) | θ_{JA} | | 180 | | | $^\circ\text{C/W}$ |
| Thermal resistance (Note 2) | θ_{JA} | | 65 | | | $^\circ\text{C/W}$ |

ELECTRICAL CHARACTERISTICS: ($T_A=25^\circ\text{C}$ unless otherwise noted)

| SYMBOL | TEST CONDITIONS | TYP | MAX | UNITS |
|--------|--|-----|-----|---------------|
| I_R | $V_R=\text{Rated } V_{RRM}$ | | 10 | μA |
| I_R | $V_R=\text{Rated } V_{RRM}, T_A=125^\circ\text{C}$ | | 50 | μA |
| V_F | $I_F=1.0\text{A}$ | | 1.1 | V |
| C_J | $V_R=4.0\text{V}, f=1.0\text{MHz}$ | 6.0 | | pF |

Notes: (1) FR-4 Epoxy PCB with copper mounting pad area of 2.2mm^2
(2) FR-4 Epoxy PCB with copper mounting pad area of 36mm^2

CMMR1 SERIES
SURFACE MOUNT SILICON
GENERAL PURPOSE RECTIFIERS
1 AMP, 200 THRU 1000 VOLT



SOD-123F CASE - MECHANICAL OUTLINE

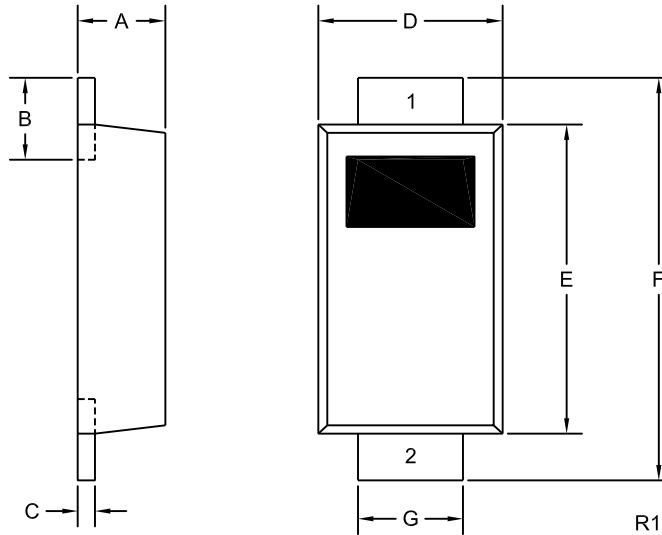

| DEVICE | MARKING CODE |
|----------|--------------|
| CMMR1-02 | C02F |
| CMMR1-04 | C04F |
| CMMR1-06 | C06F |
| CMMR1-10 | C10F |

| SYMBOL | DIMENSIONS | | | |
|--------|------------|-------|-------------|------|
| | INCHES | | MILLIMETERS | |
| | MIN | MAX | MIN | MAX |
| A | 0.035 | 0.043 | 0.88 | 1.08 |
| B | 0.020 | 0.031 | 0.50 | 0.80 |
| C | 0.004 | 0.008 | 0.10 | 0.20 |
| D | 0.065 | 0.077 | 1.65 | 1.95 |
| E | 0.104 | 0.116 | 2.65 | 2.95 |
| F | 0.140 | 0.156 | 3.55 | 3.95 |
| G | 0.030 | 0.041 | 0.75 | 1.05 |

SOD-123F (REV:R1)

LEAD CODE:
 1) Cathode
 2) Anode

R3 (29-September 2014)

OUTSTANDING SUPPORT AND SUPERIOR SERVICES



PRODUCT SUPPORT

Central's operations team provides the highest level of support to insure product is delivered on-time.

- Supply management (Customer portals)
- Inventory bonding
- Consolidated shipping options
- Custom bar coding for shipments
- Custom product packing

DESIGNER SUPPORT/SERVICES

Central's applications engineering team is ready to discuss your design challenges. Just ask.

- Free quick ship samples (2nd day air)
- Online technical data and parametric search
- SPICE models
- Custom electrical curves
- Environmental regulation compliance
- Customer specific screening
- Up-screening capabilities
- Special wafer diffusions
- PbSn plating options
- Package details
- Application notes
- Application and design sample kits
- Custom product and package development

REQUESTING PRODUCT PLATING

1. If requesting Tin/Lead plated devices, add the suffix "TIN/LEAD" to the part number when ordering (example: 2N2222A TIN/LEAD).
2. If requesting Lead (Pb) Free plated devices, add the suffix "PBFREE" to the part number when ordering (example: 2N2222A PBFREE).

CONTACT US

Corporate Headquarters & Customer Support Team

Central Semiconductor Corp.
145 Adams Avenue
Hauppauge, NY 11788 USA
Main Tel: (631) 435-1110
Main Fax: (631) 435-1824
Support Team Fax: (631) 435-3388
www.centrasemi.com

Worldwide Field Representatives:
www.centrasemi.com/wwreps

Worldwide Distributors:
www.centrasemi.com/wwdistributors

For the latest version of Central Semiconductor's **LIMITATIONS AND DAMAGES DISCLAIMER**, which is part of Central's Standard Terms and Conditions of sale, visit: www.centrasemi.com/terms