

I/O CONNECTOR

D-Sub Connector Right-Angle Type(Socket)

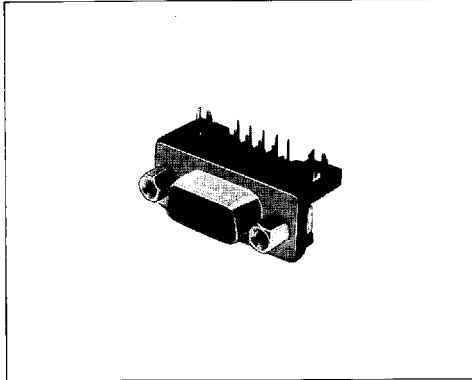

Part No.

36 □ □ 0-0 4 □ - □ □ □ □

- Series Name
Right-Angle Type
- No. of Pins
- No. of Option
- 0=Socket
- Insulator Color
- 0=Black
- Shell Plating
- 4=Tin
- Contact Plating
- 0=G/F
- 1=0.127 μm
- 2=0.254 μm
- 3=0.381 μm
- 4=0.508 μm
- 5=0.635 μm
- 6=0.762 μm
- Screw Size
- E=Dimensions
- Board Mount Option
- A=Board Lock
- B=Outside Ground
- C=Tapping Screw
- D=Only Hole
- Screw Jack
- B=Without (Tapping Screw)
- C=With (Can be removed)
- D=Without(Only Hole)
- D Dimensions

Features

1. Availability of a wide variety of accessories.

Specifications

1. Rating: 5A 300V DC
2. Contact Resistance: 15mΩ max.
3. Insulation Resistance: 1000MΩ min. at 500V DC
4. Breakdown Voltage: 1200V AC for one minute
5. Operating Temperature: -55°C to +105°C

Material and Plating

- Shell: Steel Tin plating
- Bracket: Copper Alloy Tin plating
- Screw Jack: Copper Alloy Nickel plating or Tin plating
- Contact: Copper Alloy Gold plating over Nickel
- Housing: Polybutylene Terephthalate with Glass Fiber Reinforced UL94V-0(Black or Blue)

NOTE

A wide variety of types are available for selection depending on the application. Please contact the company.

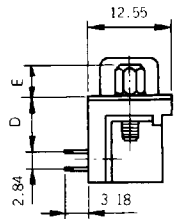
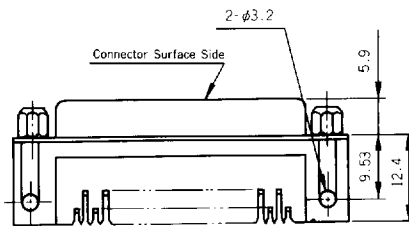
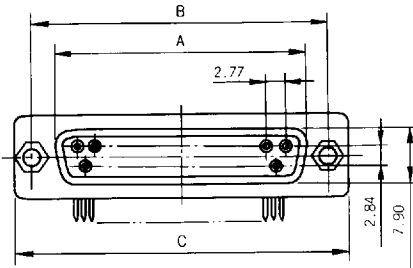

No. of Pins (Shell Size)	Dimensions		
	A	B	C
9	16.33	24.99	30.81
15	24.66	33.32	39.14
25	38.38	47.04	53.04
37	54.84	63.50	69.32

Sign	D Dimensions
S	8.08
M	10.20
L	14.99

Sign	Screw Size	E Dimensions	Ditch
S	M2.6	5.0	—
M	M3.0	5.0	I
L	4-40UNC	5.0	—
Y	4-40UNC	5.9	2

RECTANGULAR CONNECTOR