

SPECIFICATIONS

Mechanical

Contact Retention Force: 1.36Kgf min.

Electrical

Voltage Rating: 250V

Current Rating: 2.0A max.per pin

Dielectric Withstanding Voltage: 1000V AC

Insulation Resistance: 1000M Ω min.

Physical

Housing: High Temperature Nylon, UL 94V-0 Rating In Color Black

Contact: Copper alloy

Plating: See "ORDERING INFORMATION"

Operating Temperature: -40°C to +85°C

Header Connector

HL59 Series

R/A Type

Plug

2.00mm [.079"] Pitch

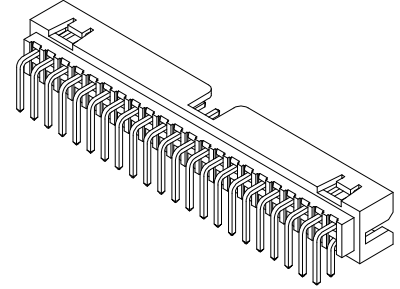

DRAWING

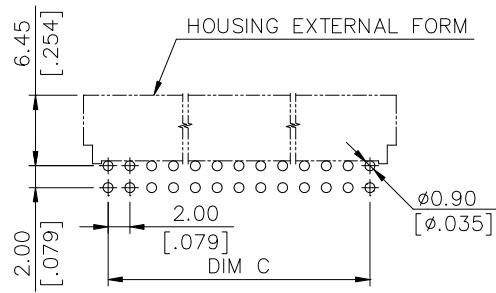
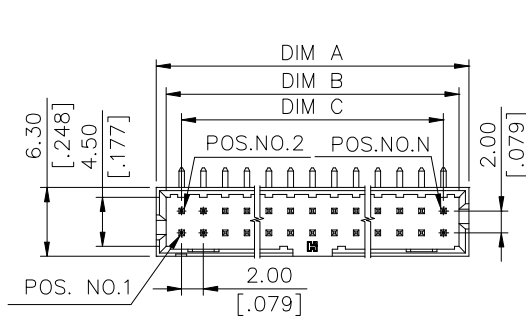

RECOMMENDED P.C.B LAYOUT

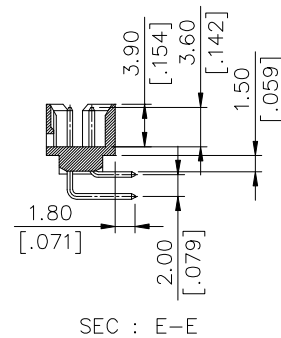
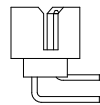
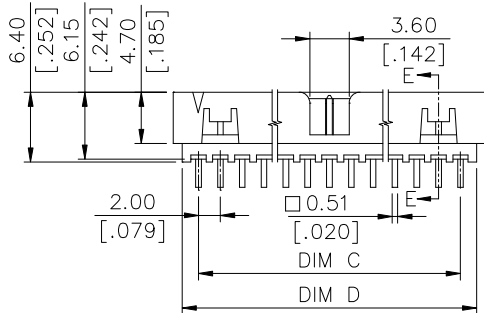

SEC : E-E

ORDERING INFORMATION

Header HL59** *
 Shrouded Header
 Terminal & Contact Type
 NO. OF SINGLE ROW POS.
 02: 02/04 POS.
 03: 03/06 POS.
 ⋮
 CONTACT AREA PLATING CODE
 F: GOLD FLASH WITH RoHS COMPLIANCE
 V: 15 μ " MIN. GOLD PLATING WITH RoHS COMPLIANCE
 H: 30 μ " MIN. GOLD PLATING WITH RoHS COMPLIANCE

P/N	DIM A	DIM B	DIM C	DIM D
HL5922*	46.65 [1.838]	44.85 [1.767]	42.00 [1.655]	45.00 [1.773]