



EVERLIGHT ELECTRONICS CO.,LTD.

Device Number : CDLE-051-010 REV.: 3

2.0*5.0mm Rectangle Type LED Lamps

PART NO. : 513GD

ECN: _____

Page: 1/4

■ Features :

- Choice of various viewing angles
- Available on tape and reel.
- Reliable and robust

■ Descriptions :

- The series is specially designed for applications requiring higher brightness
- The led lamps are available with different colors, intensities,

■ Applications :

- TV set
- Monitor
- Telephone
- Computer

■ Package Dimensions:

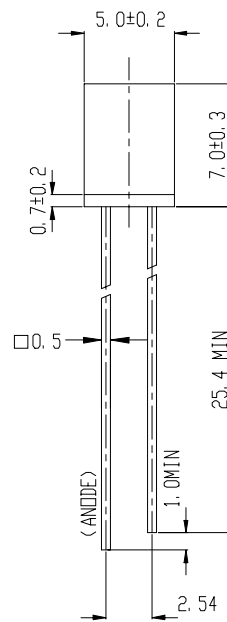
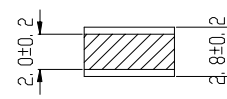

■ Notes :

1. All dimensions are in millimeters.
2. An epoxy meniscus may extend about 1.5mm(0.059") down to the lead.
3. Tolerances unless Dimension ± 0.25 mm.

| PART NO. | Chip | | Lens Color |
|----------|----------|---------------|----------------|
| | Material | Emitted Color | |
| 513GD | GaP | Green | Green Diffused |

Office : 7C Building, Lian Hua Port Industrial District, Lian Hua Shan
 Bonded Processing Zone Pan Yu, Guang Zhou, China
 TEL. : (020)84860913,84860914
 FAX : (020)84860600
 http : //www.everlight.com



EVERLIGHT ELECTRONICS CO.,LTD.

Device Number : CDLE-051-010 REV.: 3

2.0*5.0mm Rectangle Type LED Lamps

PART NO. : 513GD

ECN : _____ Page: 3/4

■ Typical Electro-Optical Characteristic Curves:

(G)

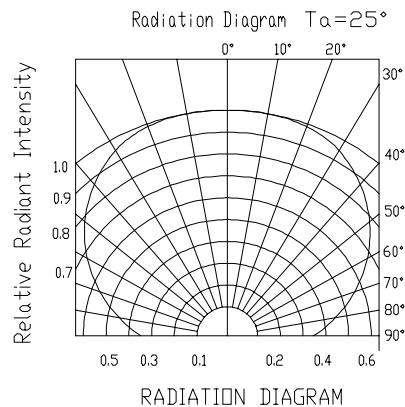
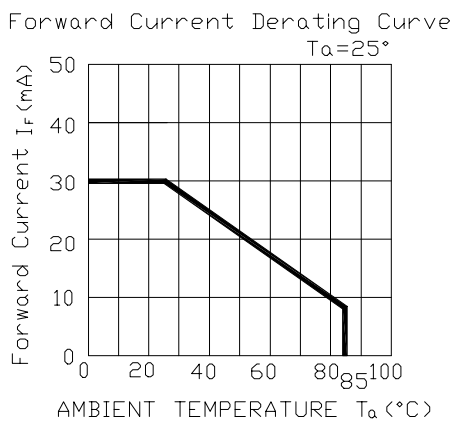
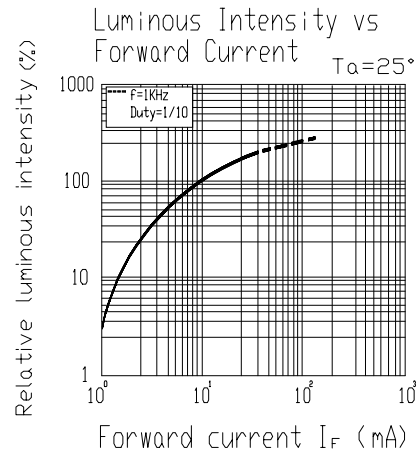
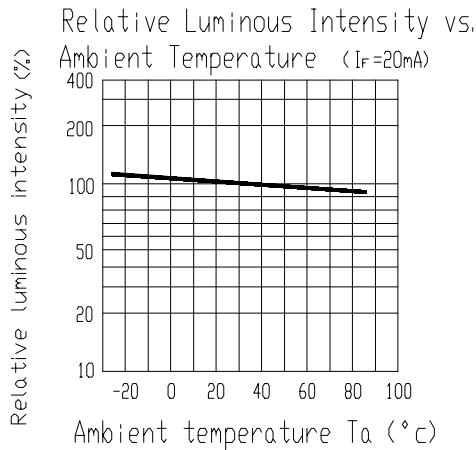
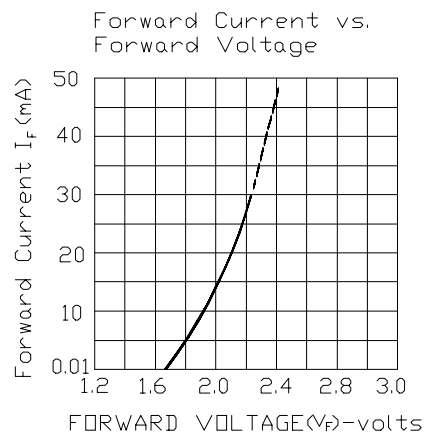
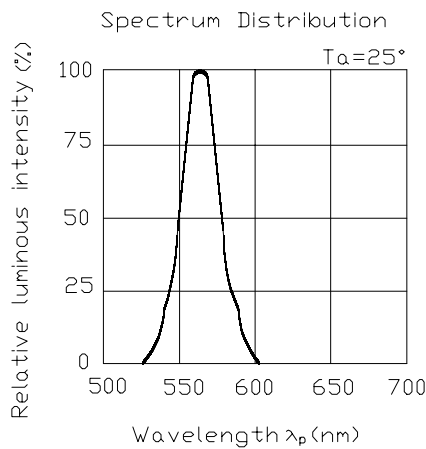



EVERLIGHT ELECTRONICS CO.,LTD.

Device Number : CDLE-051-010 REV.: 3

2.0*5.0mm Rectangle Type LED Lamps

PART NO. : 513GD ECN : Page: 4/4

■ Reliability test items and conditions:

| NO | Item | Test Conditions | Test Hours/Cycle | | Ac/Re |
|----|----------------------------------|---|------------------|--------|-------|
| 1 | Solder Heat | TEMP : 260°C ± 5 °C | 5 SEC | 76 PCS | 0/1 |
| 2 | Temperature Cycle | H : +85°C 30min ∫ 5 min L : -55°C 30min | 50 CYCLES | 76 PCS | 0/1 |
| 3 | Thermal Shock | H : +100°C 5min ∫ 10 sec L : -10°C 5min | 50 CYCLES | 76 PCS | 0/1 |
| 4 | High Temperature Storage | TEMP : 100°C | 1000 HRS | 76 PCS | 0/1 |
| 5 | Low Temperature Storage | TEMP : -55°C | 1000 HRS | 76 PCS | 0/1 |
| 6 | DC Operating Life | TEMP : 25°C IF = 20mA | 1000 HRS | 76 PCS | 0/1 |
| 7 | High Temperature / High Humidity | 85°C / 85% RH | 1000 HRS | 76 PCS | 0/1 |