

REV.	DESCRIPTION	DATE
—	RELEASE	Oct. 30, 2000
1	MATERIALS MODIFY	Jun 1, 2001
2		

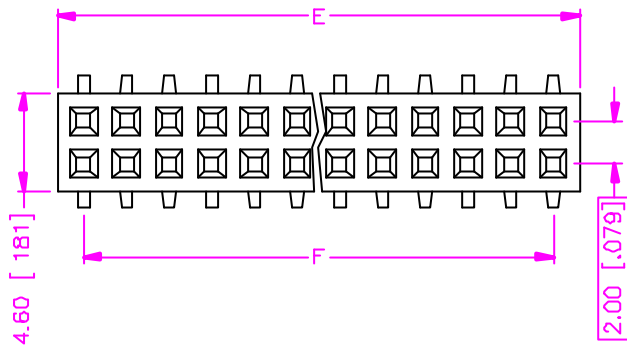

$$E = (\text{NO. OF POSITION PER ROW}) \times 2.00 + 0.50 \pm 0.40$$

$$(\text{NO. OF POSITION PER ROW}) \times 0.079 + 0.020 \pm 0.016$$

$$F = (\text{NO. OF POSITION PER ROW} - 1) \times 2.00$$

$$(\text{NO. OF POSITION PER ROW} - 1) \times 0.079$$

MATERIALS

1. HOUSING : POLYAMIDE (UL 94V-0), BLACK.
2. TERMINAL : PHOSPHOR BRONZE. (t=0.20mm)

SPECIFICATION

1. CURRENT RATING : 1 AMP. MAX.
2. DIELECTRIC WITHSTANDING VOLTAGE : 500V AC R.M.S. FOR ONE MINUTE.
3. INSULATION RESISTANCE : 5000M OHMS MIN. AT 500V DC.
4. CONTACT RESISTANCE : 30m OHMS MAX.
5. OPERATING TEMPERATURE : -55°C TO +105°C.

ORDER INFORMATION :

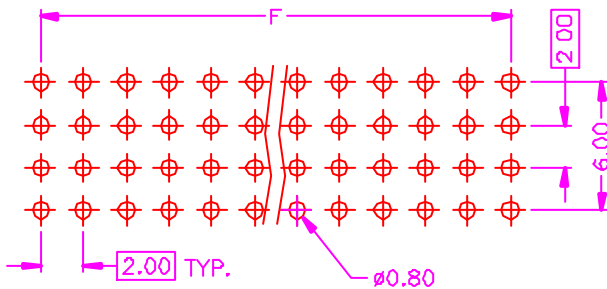
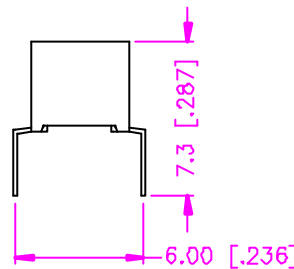
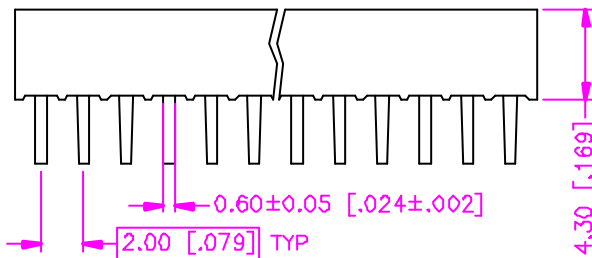
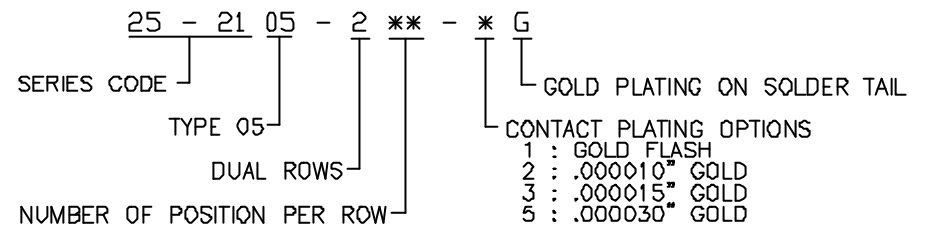

RECOMMEND P.C.B. LAYOUT
BOTTOM VIEW

TOLERANCE .0=±0.30 [.012] .00=±0.20 [.008] .000=±.XXX .0000=± ANG.=±3°		DRAWER <i>PUB</i>	Astron ASTRON TECHNOLOGY CORP.
UNITS . mm [inch]		CHECK <i>Katherine</i>	
SCALE NONE	SIZE A4	APP'D <i>WJESLY</i>	NAME POST HEADER RECEPTACLE 2.00mm PITCH, P.C.B. MOUNT VERTICAL
SHEET 1 OF 1		REV. [Green Box]	DRAW NO. C342-1004
REV. 1 OF 1			13001