

REV	ECN NO.	APP.	DATE
A	NEW DESIGN		

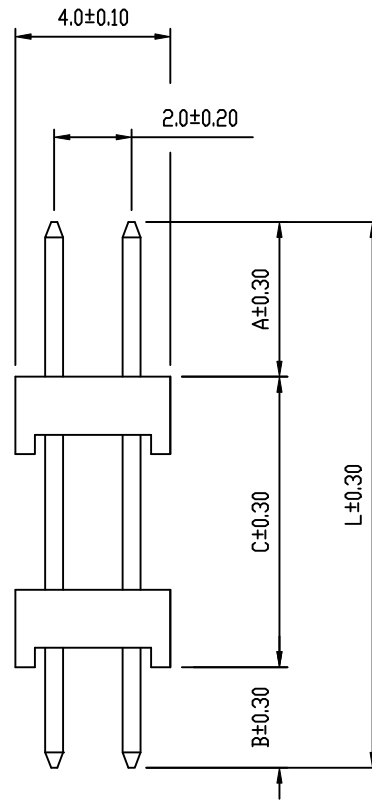
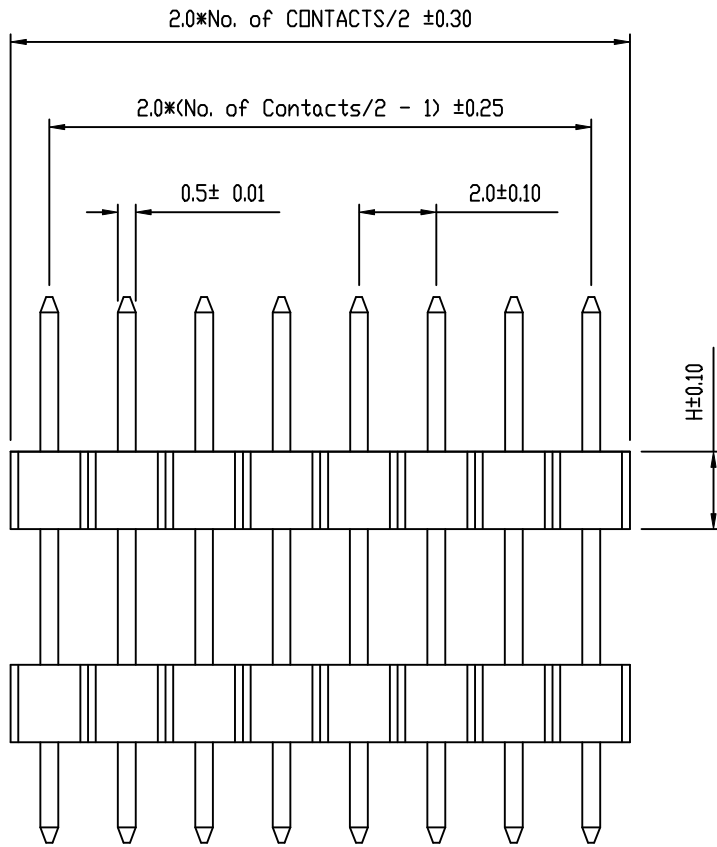

SPECIFICATION

- * Current Rating: 1 A
- * Withstanding Voltage: 600 VAC (1 min.)
- * Insulation Resistance: 1000 Megohms MIN.
- * Contact Resistance: 30 Milliohms MAX.
- * Operating Temperature: -40°C to +85°C
- * Retention Force: 600g MIN.

ORDER INFORMATION

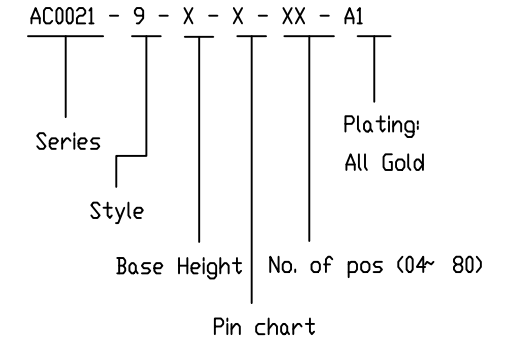

MATERIAL

- * Contact: BRASS
0.50mm square post
- * Insulator: PBT & 30% G.F.
- * Plating: All Gold

Pin Chart

Pin	A	B	C	L
1	4.00	2.80	7.50	14.30
2	3.25	3.25	10.0	16.50
3				
4				

Base Height

Base	H
1	2.0
2	1.5
3	
4	

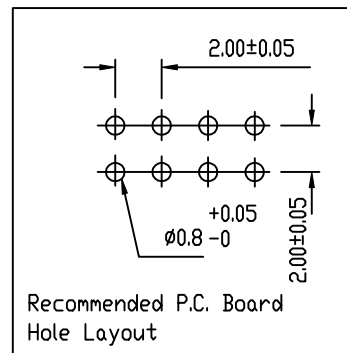

TECHWIN OPTO-ELECTRONICS CO., LTD.

0.0±	SCALE:	TITLE:	PART NO:
0.00±	UNIT:	2.00X2.00MM (.079"*.079") PIN	APP BY:
0.000±	MM	HEADER Double Base Bual Row	CHK BY:
		MATL: PBT + 30% G.F.	DR BY: 張金枝
		DWG. NO. A108A	