

025 CONNECTORS

Latched Pin Headers

A range of latched 0.635 mm square pin headers, mates with crimp sockets shown on page G6.

- End stackable to make longer lengths.
- Stand off feature.
- Up to 12 way single row and 12+12 double row.

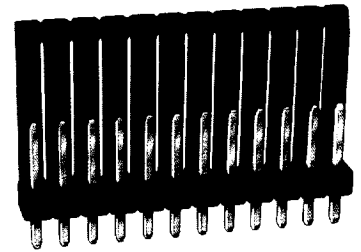
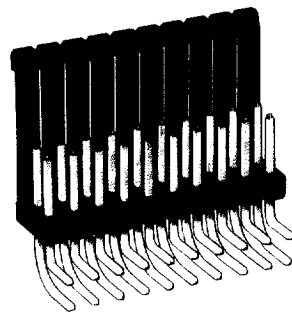

VERTICAL SINGLE ROW

Recommended PC Board Pattern

Single Row

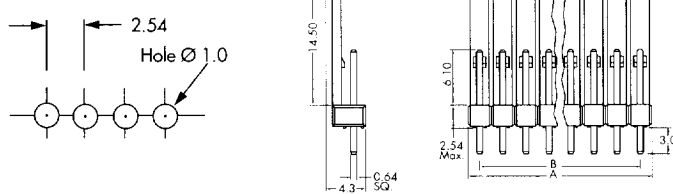

HORIZONTAL SINGLE ROW

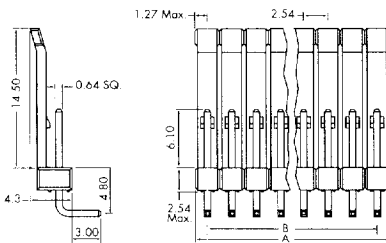

No. of Ways	A	B	Order Code	
			Tin	Gold
2	5.08	2.54	M20-9470206	M20-9470205
3	7.62	5.08	M20-9470306	M20-9470305
4	10.16	7.62	M20-9470406	M20-9470405
5	12.70	10.16	M20-9470506	M20-9470505
6	15.24	12.70	M20-9470606	M20-9470605
7	17.78	15.24	M20-9470706	M20-9470705
8	20.32	17.78	M20-9470806	M20-9470805
9	22.86	20.32	M20-9470906	M20-9470905
10	25.40	22.86	M20-9471006	M20-9471005
11	27.94	25.40	M20-9471106	M20-9471105
12	30.48	27.94	M20-9471206	M20-9471205

No. of Ways	A	B	Order Code	
			Tin	Gold
2	5.08	2.54	M20-9450206	M20-9450205
3	7.62	5.08	M20-9450306	M20-9450305
4	10.16	7.62	M20-9450406	M20-9450405
5	12.70	10.16	M20-9450506	M20-9450505
6	15.24	12.70	M20-9450606	M20-9450605
7	17.78	15.24	M20-9450706	M20-9450705
8	20.32	17.78	M20-9450806	M20-9450805
9	22.86	20.32	M20-9450906	M20-9450905
10	25.40	22.86	M20-9451006	M20-9451005
11	27.94	25.40	M20-9451106	M20-9451105
12	30.48	27.94	M20-9451206	M20-9451205

VERTICAL DOUBLE ROW

Recommended PC Board Pattern

Double Row

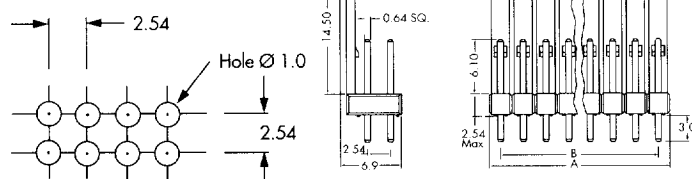

HORIZONTAL DOUBLE ROW

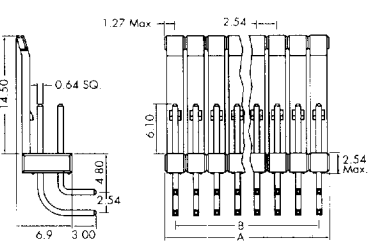

No. of Ways	A	B	Order Code	
			Tin	Gold
2+2	5.08	2.54	M20-9460206	M20-9460205
3+3	7.62	5.08	M20-9460306	M20-9460305
4+4	10.16	7.62	M20-9460406	M20-9460405
5+5	12.70	10.16	M20-9460506	M20-9460505
6+6	15.24	12.70	M20-9460606	M20-9460605
7+7	17.78	15.24	M20-9460706	M20-9460705
8+8	20.32	17.78	M20-9460806	M20-9460805
9+9	22.86	20.32	M20-9460906	M20-9460905
10+10	25.40	22.86	M20-9461006	M20-9461005
11+11	27.94	25.40	M20-9461106	M20-9461105
12+12	30.48	27.94	M20-9461206	M20-9461205

No. of Ways	A	B	Order Code	
			Tin	Gold
2+2	5.08	2.54	M20-9440206	M20-9440205
3+3	7.62	5.08	M20-9440306	M20-9440305
4+4	10.16	7.62	M20-9440406	M20-9440405
5+5	12.70	10.16	M20-9440506	M20-9440505
6+6	15.24	12.70	M20-9440606	M20-9440605
7+7	17.78	15.24	M20-9440706	M20-9440705
8+8	20.32	17.78	M20-9440806	M20-9440805
9+9	22.86	20.32	M20-9440906	M20-9440905
10+10	25.40	22.86	M20-9441006	M20-9441005
11+11	27.94	25.40	M20-9441106	M20-9441105
12+12	30.48	27.94	M20-9441206	M20-9441205