

CATALOG NO.	NO. OF POS	A MAX	B	C ±.004 ±0,10	D	F	G ±.004 ±0,10	J
RPIG48U30PB----	48	2,470 62,74	2,284 58,14	1,758 44,65	2,086 52,98	1,500 38,10	1,970 50,04	2,284 58,01
RPIG72U30PB----	72	3,270 83,06	3,084 78,33	2,558 64,97	2,886 73,30	2,300 58,42	2,770 70,36	3,084 78,33
RPIG96U30PB----	96	4,070 103,38	3,884 98,65	3,358 85,19	3,686 93,62	3,100 78,74	3,570 90,68	3,884 98,65
RPIG120U30PB----	120	4,870 123,70	4,684 118,97	4,158 105,61	4,486 113,94	3,900 99,06	4,370 111,00	4,684 118,97
RPIG150U30PB----	150	5,870 149,10	5,684 144,37	5,158 131,91	5,486 139,34	4,900 124,46	5,370 136,40	5,684 144,37

TAIL LENGTH VARIATION	L ±.020 ±0,50
RPIG____U30PB-12	.138 3,51
RPIG____U30PB-14	.177 4,50
RPIG____U30PB-15	.114 2,90

NOTES: UNLESS OTHERWISE SPECIFIED;
 MATERIAL:
 BODY - GLASS REINFORCED POLYESTER UL94V-0, COLOR-BLACK.
 CONTACTS - COPPER ALLOY.
 CONTACT FINISH:
 B: 30 MICRONS [0,75 MICRONS] MIN GOLD IN CONTACT AREA AND 200 MICRONS [5,08 MICRONS] MIN TIN/LEAD ALLOY ON CONTACT TAILS; 50 MICRONS [1,27 MICRONS] MIN NICKEL UNDERPLATE ALL OVER.

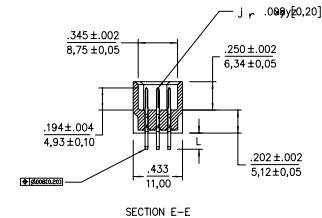
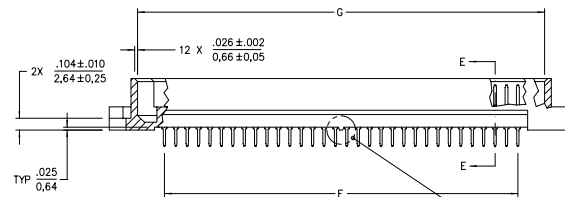
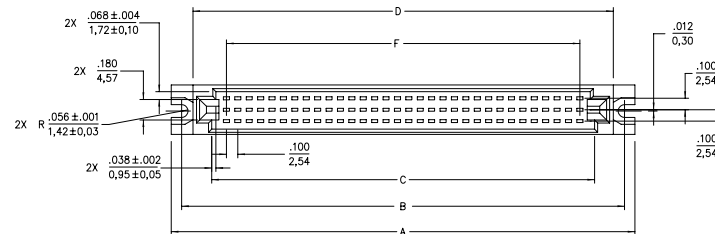
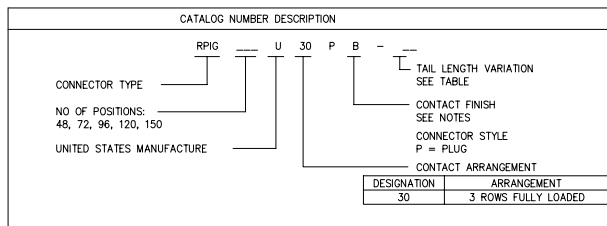
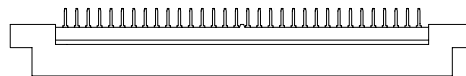

CATALOG NO. RPIG96U30PB-15 SHOWN
 STANDOFF - CATALOG NOS. RPIG120_, RPIG150_ ONLY.

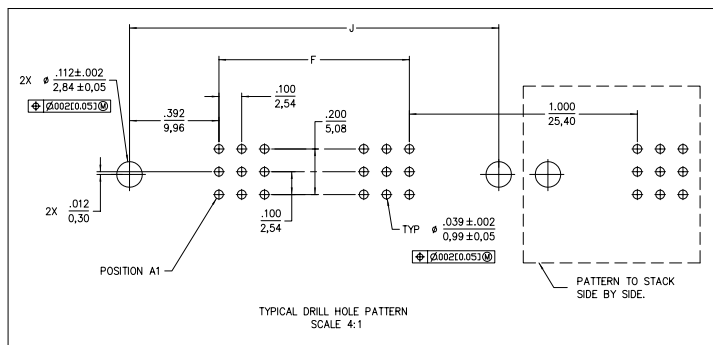

mat'l. code		surface ISO 1302 ✓		tolerance ISO 406 ISO 1101		projection		product family		
ltr		ecn no dr		date		tolerances unless otherwise specified		DIN		
2	ECN1409	VCE	3/30/90	angles	.XX±.01/.3	INCH/MM		title		
3	ECN1986	KFD	5/07/92	linear	.XXX±.005/.13	scale 2:1		PCB CONNECTOR PLUG W/ALIGNMENT GROOVES		
E	V20210	TAB	1/29/02	0°±2'	.XXX±.0020/.051	FCI		dwg no sheet 1 of 1 size		
F	C21032	TAB	6/11/02	dr	BC 6/18/870			SE93322 A3		
G	M06-0330	ACS	8/28/06	engr	PJB 6/19/87			type Product Customer Drawing		
				chr	PZ 7/28/87					
				appd	MSM 7/28/87					
sheet index	revision sheet	G	1							

FCI
 FCIconnect.com

Copyright FCI