

Assembly Layout

Straight Angle (V-Type)

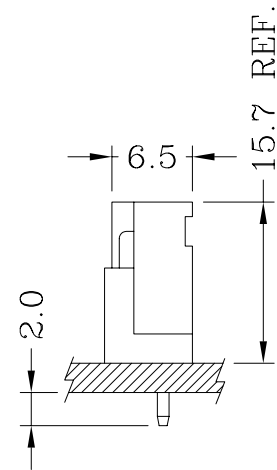

Right Angle (R-Type)

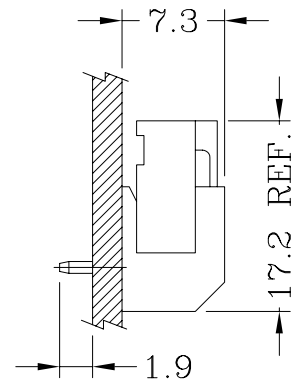

Specifications:

Poles	2~14 Poles
Pitch between poles	2.50mm
Rated Voltage	250V AC,DC
Rated Current	3A (AWG #22)
Withstand Voltage	800V AC/minute
Contact Resistance	10mΩ(MAX.)
Insulation Resistance	1,000MΩ (MIN.)
Temperature Range	-25°~+85°C
Applicable P.C.B. Thickness	1.6mm
Applicable P.C.B. Hole dia.	ø1.10±0.05mm
Applicable Wire Range	AWG #22~#28

UL:Recognized No. E144544

CSA:Certified No. LR78619

A2506 Series 2.50mm pitch crimp terminal socket

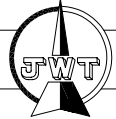

Features:

- * Available in 2 through 14 circuits
- * Material: P.B.T UL 94V-0 w/ 30% GF (Flesh)
- * Suitable for JWT A2506 series terminal
- * Mates with JWT A2506 series wafer

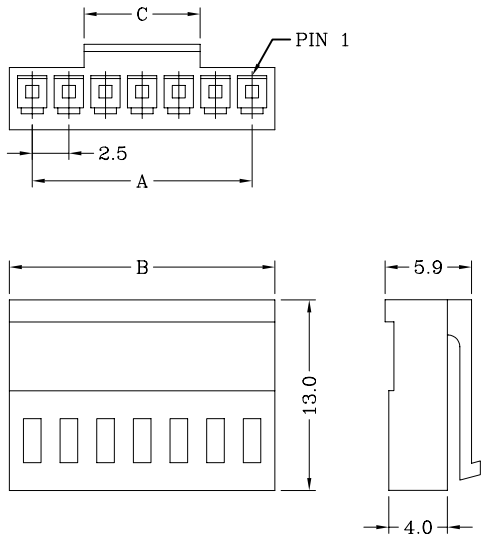

Dimensional & Ordering Information:

Circuits	Part No	Dimensions			PCS/BAG
		A	B	C	
2	A2506H02-2P	2.5	5.5	2.0	1000
3	A2506H02-3P	5.0	8.0	2.5	1000
4	A2506H02-4P	7.5	10.5	5.0	1000
5	A2506H02-5P	10.0	13.0	5.0	1000
6	A2506H02-6P	12.5	15.5	6.0	1000
7	A2506H02-7P	15.0	18.0	8.0	500
8	A2506H02-8P	17.5	20.5	10.0	500
9	A2506H02-9P	20.0	23.0	10.0	500
10	A2506H02-10P	22.5	25.5	10.0	500
11	A2506H02-11 P	25.0	28.0	11.0	500
12	A2506H02-12P	27.5	30.5	11.0	500
13	A2506H02-13P	30.0	33.0	13.0	500
14	A2506H02-14P	32.5	35.5	13.0	500

A2506 Series 2.50mm pitch crimp terminal

Features:

- * Dual beam contact point
- * Used in JWT A2506 series socket
- * Back-carrier style

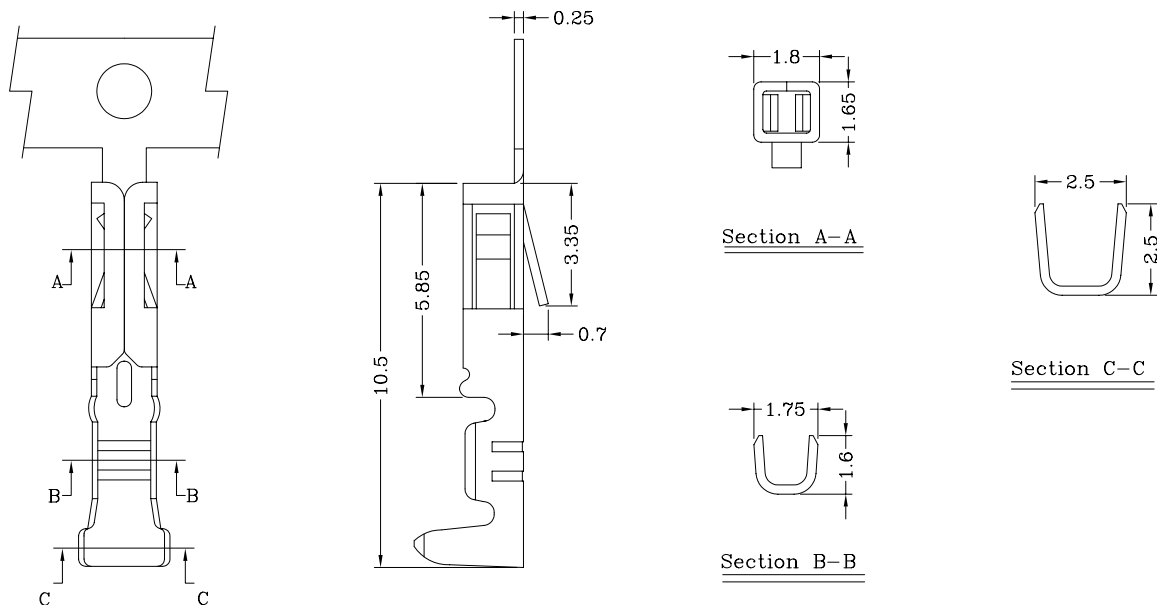

Specification & Ordering Information:

Part No	Wire Range	Insulation O.D.	Material	Finish	Qty/reel
A2506TOP-2	AWG #22~#28	1.70mm(max)	Phosphor bronze	Tin-plated	10,000 PCS

A2506 Series 2.50mm pitch wafer

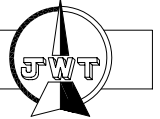

Features:

- * Available in 2 through 14 circuits
- * Material: Insulator: P.B.T UL 94V-0 w/ 30% GF (Flesh)
Contact: 0.64mm(.025") square pin, brass, tin plated
- * Mates with A2506 series socket

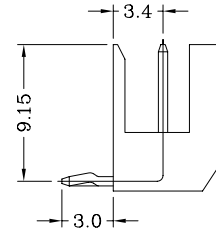
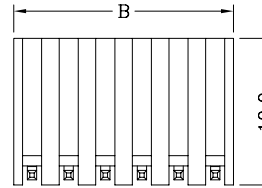
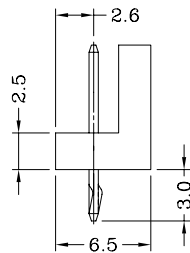
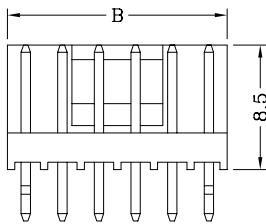
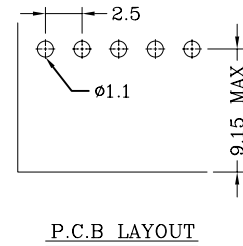
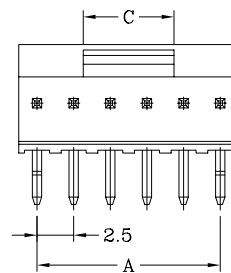
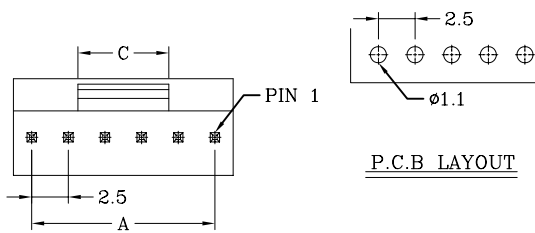

Straight Angle

Right Angle

Dimensional & Ordering Information:

Circuits	Part No		Dimensions			PCS/BAG
	Straight Angle	Right Angle	A	B	C	
2	A2506WV2-2P	A2506WR2-2P	2.5	5.0	2.2	1000
3	A2506WV2-3P	A2506WR2-3P	5.0	7.5	2.7	1000
4	A2506WV2-4P	A2506WR2-4P	7.5	10.0	5.2	1000
5	A2506WV2-5P	A2506WR2-5P	10.0	12.5	5.2	1000
6	A2506WV2-6P	A2506WR2-6P	12.5	15.0	6.2	1000
7	A2506WV2-7P	A2506WR2-7P	15.0	17.5	8.2	500
8	A2506WV2-8P	A2506WR2-8P	17.5	20.0	10.2	500
9	A2506WV2-9P	A2506WR2-9P	20.0	22.5	10.2	500
10	A2506WV2-10P	A2506WR2-10P	22.5	25.0	10.2	500
11	A2506WV2-11P	A2506WR2-11P	25.0	27.5	11.2	500
12	A2506WV2-12P	A2506WR2-12P	27.5	30.0	11.2	500
13	A2506WV2-13P	A2506WR2-13P	30.0	32.5	13.2	500
14	A2506WV2-14P	A2506WR2-14P	32.5	35.0	13.2	500