

D-SUBMINIATURE CONNECTORS:
KF22X Series
 Right Angle PCB Mount 0.318" Footprint with Ferrite

KF22X Series Dimensions
 Dimensions in mm

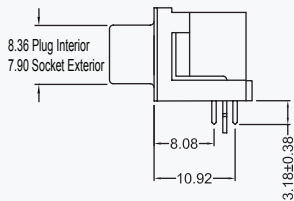
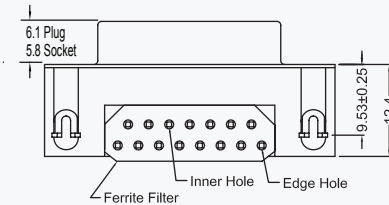
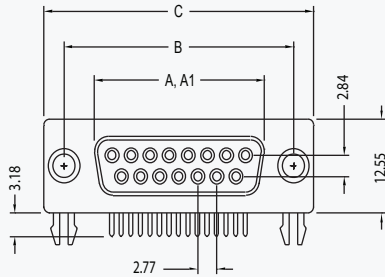

Shell Size	In mm	A	A1	B	C
		±.010 ±0.25	±.010 ±0.25	±.005 ±0.13	±.015 ±0.38
9 (E)	.643 16.33	.666 16.92	.984 24.99	1.213 30.81	
15 (A)	.971 24.66	.994 25.25	1.312 33.32	1.541 39.14	
25 (B)	1.511 38.38	1.534 38.96	1.852 47.04	2.088 53.04	
37 (C)	2.159 54.84	2.182 55.42	2.500 63.50	2.729 69.32	

A = Exterior of Female Shell (S)
 A1 = Interior of Male Shell (P)

2D Drawing	IGES	STEP	3D PDF
Solder Profile	CofC RoHS Compliant	CofC REACH Compliant	UL Plastic File
Certificate of Origin	Check Stock	Request a Sample	Send Us An Email

Generated Part Number

Part Number Builder

Series - Shell Size Contact - Contact Type - Mounting Option - Plating Option

Series

KF22X - D-Subminiature Connector, 0.318" Footprint with Ferrite

Shell Size-Contact Option

- E - 9 Contacts
- A - 15 Contacts
- B - 25 Contacts
- C - 37 Contacts

Contact Type

- P - Pin Contact (Plug)
- S - Socket Contact (Receptacle)

Mounting Option

- N - With Boardlocks and #4-40 UNC Threaded Inserts
- NJ - With Boardlocks and #4-40 Jackscrews Installed
- NR - With Boardlocks and #4-40 Round Jackscrews
- NT - With Boardlocks and Non-Threaded Inserts
- NJM - With Boardlocks and Metric Jackscrews Installed

Plating Option

- Blank - Gold Flash
- 15 - 15µ" Gold
- 30 - 30µ" Gold

Contact Kycon for Other Options