

**NOTES:**  
 Rated Current:0.5AMP  
 Rated Voltage:50V AC/DC  
 Contact Resistance:30mΩ max  
 Insulation Resistance:100MΩ min  
 Operation Temperature:-20? to +105?

Contact Material:Phosphor bronze  
 Contact Plating:Au or Sn Over Ni  
 Insulator Material:Polyester UL94V-0  
 Standard: LCP+30%G.F

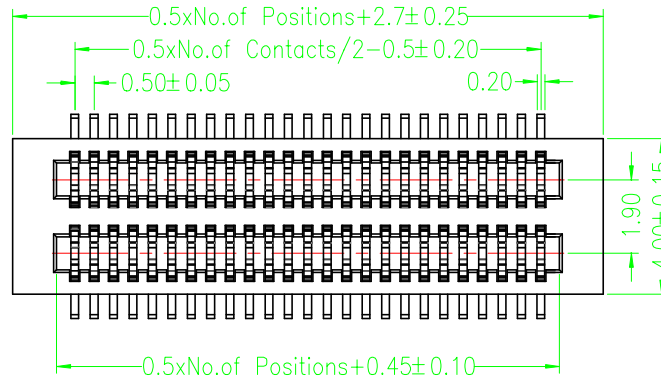

Recommended P.C.B Layout(Top Side)  
 (PCB BOARD TOLERANCE± 0.05)

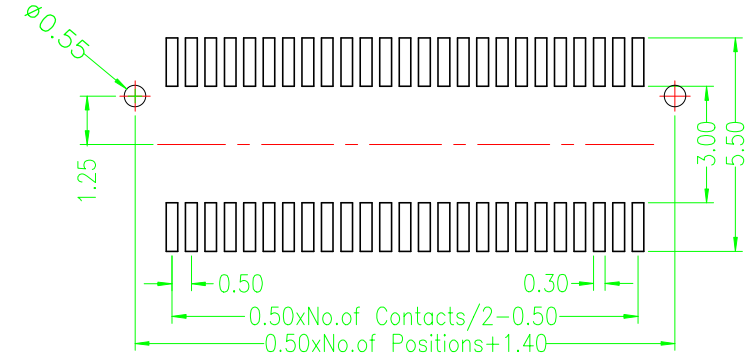

### Ordering Information

W3620 - S XX XX XX 01

High	No.of Pins Per	Contact Plating
Plug=H1	05~25P	G0=Gold Flash
Socket=H2	30P	S0=Gold Flash/Tin
	40P	
	50P	

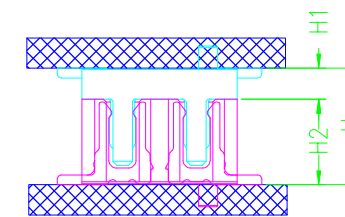
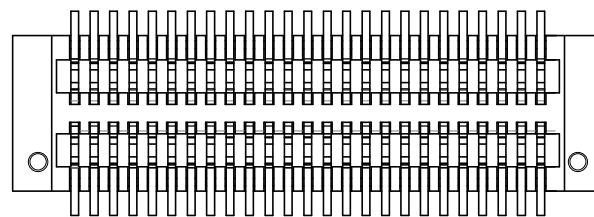
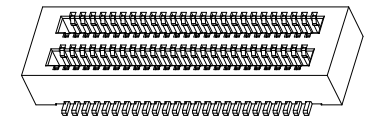
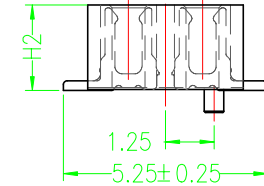
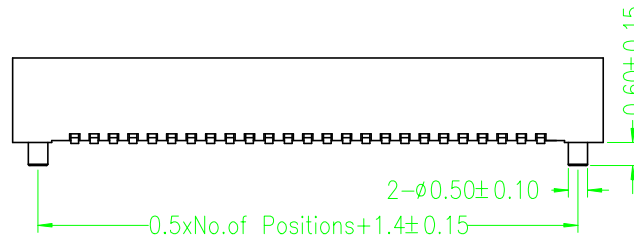

ASSEMBLY

ASS'Y HIGH(H)	PLUG(H1)	SOCKET(H2)
3.00	1.00	2.00
3.50	1.50	2.00
4.00	2.00	2.00
4.50	1.50	3.00
5.00	2.00	3.00
5.50	2.50	3.00
6.00	3.00	3.00

					OPERATION	DRAW	William Chen	09.02.14	SCALE	1:1		
					X.X	±0.20			UNIT	mm		
					X.XX	±0.10			SIZE	A4	PART NO.	W3620-SXXXXXXX01
A0	09/02/14		NEW		X.XXX	±0.05			SHEET	1/1	TITLE:	0.50mm BO TO BO SOCKET
REV	DATE	MODIFICATION DESCRIPTION		CHANGE	APPROVE	Angle DIM	± 3' TOL	APPROVE	PROJ.	Customer NO.		