

Global Connector Technology Ltd. - BD031: 1.27mm PITCH SHROUDED PIN HEADER, DUAL ROW, THROUGH HOLE, VERTICAL

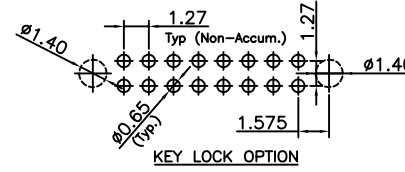

RECOMMENDED PCB LAYOUT

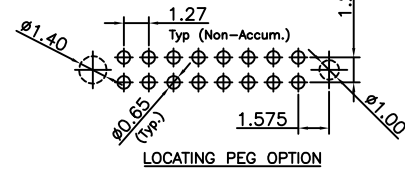
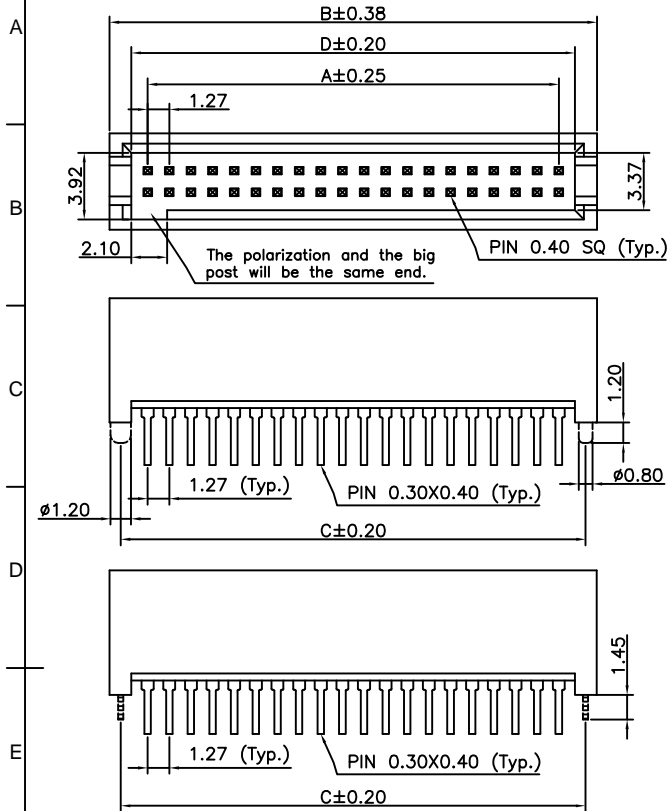
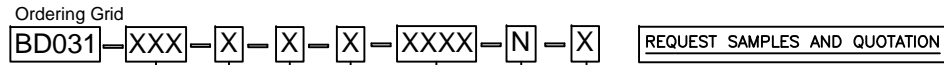
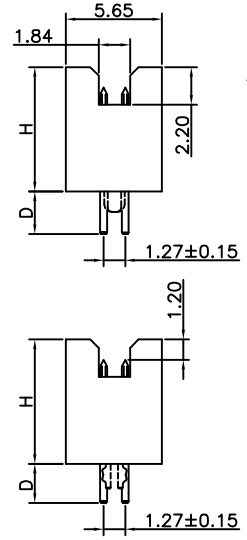
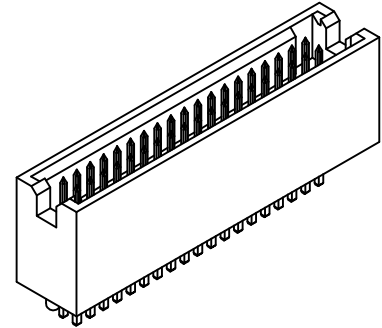

- No. of Contacts: 10 to 120, e.g. 10 = 010
- Contact Plating: A = Gold Flash All Over, B = Selective Gold Flash Contact Area/Tin On Tail, C = Tin All Over
- Insulator Height 'H': S = 5.70mm, T = 7.30mm, Standard = 5.70mm
- Insulator Material: N = Nylon 6T (Standard)
- Packing Options: D = Tube (Standard), H = Tray
- Dimension D (1/100mm) (Tail Length): Standard - 2.30mm = 0230, or specify Dimension D, e.g. 2.50mm = 0250, Tol +/- 0.2mm
- Locating Peg: 0 = No Peg/No Key Lock, 1 = With Peg, 2 = With Key Lock

SPECIFICATIONS 规格:

CURRENT RATING 电流额定值: 1 AMP
 INSULATOR RESISTANCE 绝缘电阻值: 1000 MEGOHMS MIN.
 DIELECTRIC WITHSTANDING 耐电压: AC 300 V
 CONTACT RESISTANCE 接触电阻值: 20mΩ Max.
 OPERATING TEMPERATURE 工作温度: -40°C TO +105°C
 CONTACT MATERIAL 端子物料: COPPER ALLOY
 INSULATOR MATERIAL 绝缘体物料:
 STANDARD 标准物料: POLYAMIDE 聚酰胺, NYLON 6T, UL 94-V0
 SOLDERING PROCESS 可焊性:
 NYLON 6T (STANDARD 标准物料) -
 IR REFLOW 回流焊: 260°C for 10 sec.
 WAVE 波峰焊: 230°C for 5-10 sec.
 MANUAL SOLDER 人工焊接: 350°C for 3-5sec

MATES WITH 配套之母座 (SUBJECT TO PIN LENGTH 在端子长度适合的条件下):
 BD065

By	AE	AE
DETAIL	DRAWING RELEASE	INSULATOR INFO AMMENDED
REV	A	B
DATE	27/03/08	27/07/09

CONTACTS	DIMENSIONS			
	A	B	C	D
10	5.08	9.55	8.23	6.95
12	6.35	10.82	9.50	8.22
14	7.62	12.09	10.77	9.49
16	8.89	13.36	12.04	10.76
18	10.16	14.63	13.31	12.03
20	11.43	15.90	14.58	13.30
22	12.70	17.17	15.85	14.57
24	13.97	18.44	17.12	15.84
26	15.24	19.71	18.39	17.11
28	16.51	20.98	19.66	18.38
30	17.78	22.25	20.93	19.65
32	19.05	23.52	22.20	20.92
34	20.32	24.79	23.47	22.19
36	21.59	26.06	24.74	23.46
38	22.86	27.33	26.01	24.73
40	24.13	28.60	27.28	26.00
42	25.40	29.87	28.55	27.27
44	26.67	31.14	29.82	28.54
46	27.94	32.41	31.09	29.81
48	29.21	33.68	32.36	31.08
50	30.48	34.95	33.63	32.35
52	31.75	36.22	34.90	33.62
54	33.02	37.49	36.17	34.89
56	34.29	38.76	37.44	36.16
58	35.56	40.03	38.71	37.43
60	36.83	41.30	39.98	38.70
62	38.10	42.57	41.25	39.97
64	39.37	43.84	42.52	41.24
66	40.64	45.11	43.79	42.51
68	41.91	46.38	45.06	43.78
70	43.18	47.65	46.33	45.05
72	44.45	48.92	47.60	46.32
74	45.72	50.19	48.87	47.59
76	46.99	51.46	50.14	48.86
78	48.26	52.73	51.41	50.13
80	49.53	54.00	52.68	51.40
82	50.80	55.27	53.95	52.67
84	52.07	56.54	55.22	53.94
86	53.34	57.81	56.49	55.21
88	54.61	59.08	57.76	56.48
90	55.88	60.35	59.03	57.75
92	57.15	61.62	60.30	59.02
94	58.42	62.89	61.57	60.29
96	59.69	64.16	62.84	61.56
98	60.96	65.43	64.11	62.83
100	62.23	66.70	65.38	64.10
102	63.50	67.97	66.65	65.37
104	64.77	69.24	67.92	66.64
106	66.04	70.51	69.19	67.91
108	67.31	71.78	70.46	69.18
110	68.58	73.05	71.73	70.45
112	69.85	74.32	73.00	71.72
114	71.12	75.59	74.27	72.99
116	72.39	76.86	75.54	74.26
118	73.66	78.13	76.81	75.53
120	74.93	79.40	78.08	76.80



Tolerances (Except as noted)	Part Number:-	Date:-
Dimensions in mm	BD031	30 MAR 08
X _i ± 0.30 X ₁ X ± 0.20 X ₂ XX ± 0.15 X ₃ XXX ± 0.10	Description:-	
X ₄ ± 5° X ₅ ± 2° XX ± 1° XXX ± 0.5°	1.27mm PITCH SHROUDED PIN HEADER, DUAL ROW, THROUGH HOLE, VERTICAL	
Third Angle Projection	THIS DRAWING IS CONFIDENTIAL AND MUST NOT BE COPIED OR DISCLOSED WITHOUT WRITTEN CONSENT	

Global Connector Technology

www.globalconnectortechnology.com

Scale NTS	Revision B	Material See Note	Drawn by AE	Sheet No. E & OE 1/1
-----------	------------	-------------------	-------------	----------------------