

ILC7362

SOT-23 CMOS Negative LDO

Features

- All-CMOS design in SOT-23 and SOT-89 packages gives optimal size and power performance
- $\pm 2\%$ precision outputs
- $3\mu\text{A}$ of I_q
- Package and Voltage options allow:
 - 100mA-5V Regulator
 - 50mA-3V Regulator
 - 100mA-5V to -3V Converter
 - 50mA-5V to -3V Converter

Applications

- Battery-powered Equipment
- Reference voltage sources
- Portable Cameras and Video Recorders
- Power Failure Detection
- PDAs

Description

100mA negative LDO in SOT-23 package.

This CMOS device regulates a negative supply down to a fixed voltage level at $\pm 2\%$ accuracy.

It offers exceptional LDO performance of 120mV dropout at 50mA current levels.

The device also comes in a 3-lead SOT-89 package, for a number of voltage and current offerings.

Block Diagram

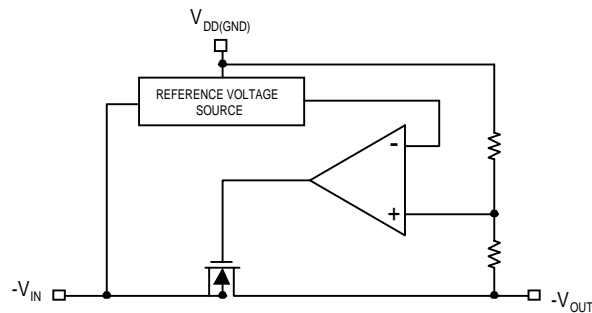

Pin Assignments

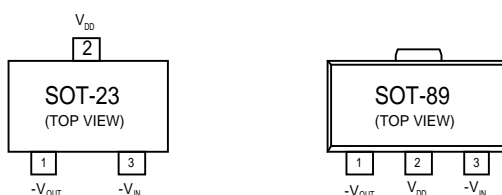

Absolute Maximum Ratings (T_A = 25°C)

Parameter	Symbol	Ratings	Units
Input Voltage	V _{IN}	-12	V
Output Current	I _{OUT}	200	mA
Output Voltage	V _{OUT}	-V _{DD} -0.3~V _{IN} +0.3	V
Continuous Total SOT-23 Power Dissipation	SOT-23	150	mW
	SOT-89	500	
Operating Ambient Temperature	T _{opr}	-30~+85	°C
Storage Temperature	T _{stg}	-40~+125	°C

Electrical Characteristics ILC7362CP-50

Parameter	Symbol	Conditions	Min.	Typ.	Max.	Units
Output Voltage	V _{OUT}	I _{OUT} = 20mA, V _{IN} = -7.0V	-4.90	-5.0	-5.10	V
Maximum Output Current	I _{OUTmax}	V _{IN} = -7.0V, V _{OUT} ≥ -4.5V	100			mA
Load Stability	ΔV _{OUT}	V _{IN} = -7.0V, 1mA ≤ I _{OUT} ≤ 50mA		40	80	mV
Input/Output Voltage Differential	V _{dif}	I _{OUT} = 50mA I _{OUT} = 100mA		120 380	300 600	mV
Supply Current	I _{SS}	V _{IN} = -7.0V		3.0	7.0	μA
Input Stability	$\frac{\Delta V_{OUT}}{\Delta V_{IN} \cdot V_{OUT}}$	I _{OUT} = 20mA -7.0 ≤ V _{IN} ≤ -10.0V		0.1	0.3	%/V
Input Voltage	V _{IN}				10.0	V
Output Voltage Temperature Characteristics	$\frac{\Delta V_{OUT}}{\Delta T_{opr}} \cdot V_{OUT}$	I _{OUT} = 20mA -30°C ≤ T _{opr} ≤ 80°C		±100		ppm/°C

Note:

- V_{OUT} means the output voltage when “V_{OUT}-2.0V” is provided at the V_{IN} pin while maintaining a certain I_{OUT} value.
- V_{dif} is defined as “V_{IN} - V_{OUT}.”
- I_{OUTmax} = This is specified for SOT-89 package. For SOT-23, it is limited by continuous total power dissipation.

Electrical Characteristics ILC7362CP-30

Parameter	Symbol	Conditions	Min.	Typ.	Max.	Units
Output Voltage	V_{OUT}	$I_{OUT} = 20\text{mA}$, $V_{IN} = -5.0\text{V}$	-2.92	-3.0	-3.06	V
Maximum Output Current	I_{OUTmax}	$V_{IN} = -5.0\text{V}$, $V_{OUT} \geq -2.7\text{V}$	100			mA
Load Stability	ΔV_{OUT}	$V_{IN} = -5.0\text{V}$, $1\text{mA} \leq I_{OUT} \leq 40\text{mA}$		40	80	mV
Input/Output Voltage Differential	V_{dif}	$I_{OUT} = 40\text{mA}$ $I_{OUT} = 80\text{mA}$		120 380	300 600	mV
Supply Current	I_{SS}	$V_{IN} = -5.0\text{V}$		2.5	6.0	μA
Input Stability	$\frac{\Delta V_{OUT}}{\Delta V_{IN} \cdot V_{OUT}}$	$I_{OUT} = 20\text{mA}$ $-5.0 \leq V_{IN} \leq -10.0\text{V}$		0.1	0.3	%/V
Input Voltage	V_{IN}				-10.0	V
Output Voltage Temperature Characteristics	$\frac{\Delta V_{OUT}}{\Delta T_{opr} \cdot V_{OUT}}$	$I_{OUT} = 20\text{mA}$ $-30^{\circ}\text{C} \leq T_{opr} \leq 80^{\circ}\text{C}$		± 100		ppm/ $^{\circ}\text{C}$

Typical Performance Characteristics

General conditions for all curves; 4.7mF on output

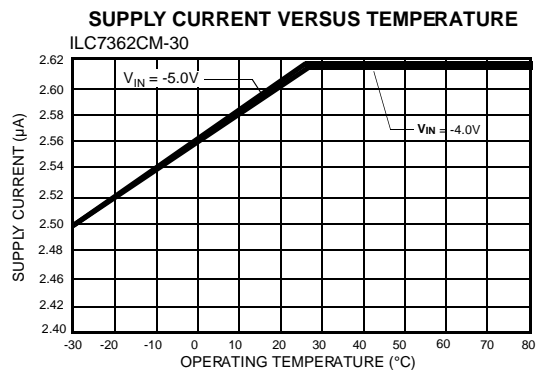
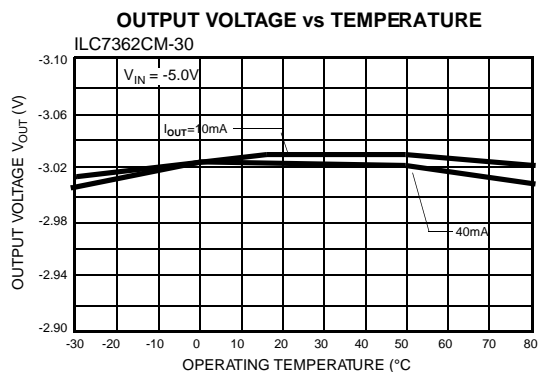
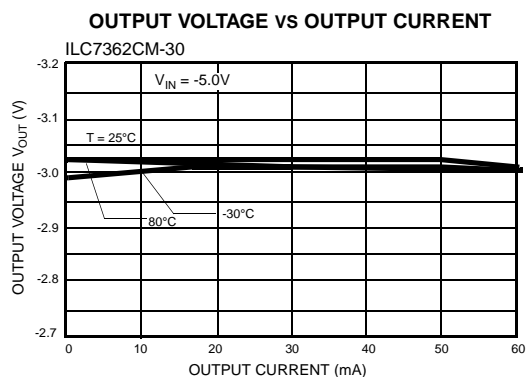
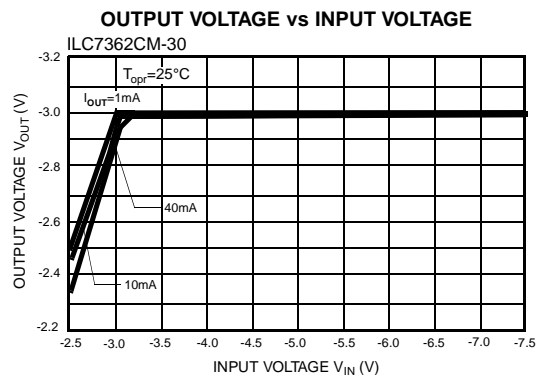
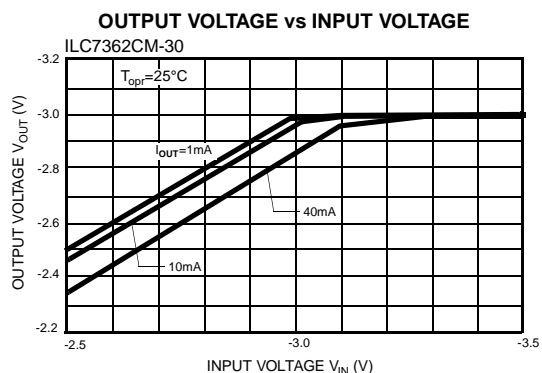

Packaging Information

SOT-23

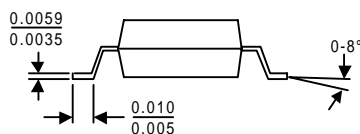
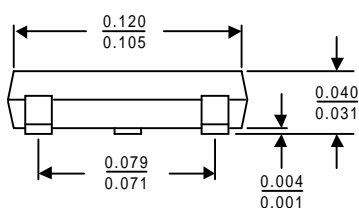
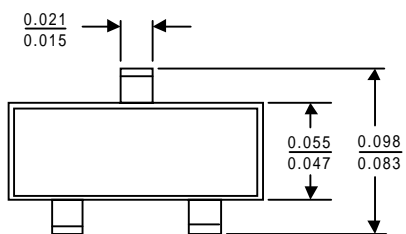

SOT-89

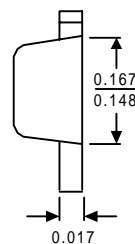
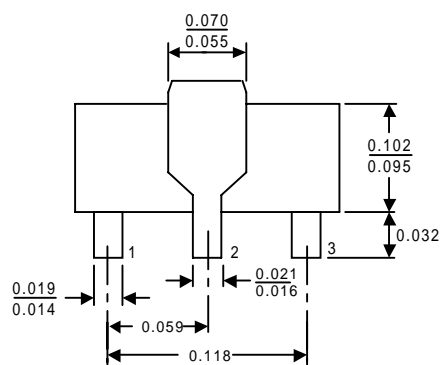
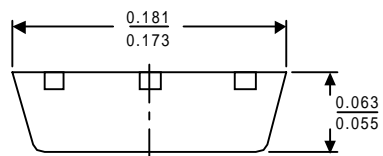

Ordering Information

Product Number	Package
ILC7362CP-50	100mA-5V Regulator
	SOT-89 Package
ILC7362CP-30	100mA-5V to -3V Converter, or 50mA-5V Regulator
	SOT-89 Package
ILC7362CM-30	50mA-5V to -3V Converter
	SOT-23 Package

DISCLAIMER

FAIRCHILD SEMICONDUCTOR RESERVES THE RIGHT TO MAKE CHANGES WITHOUT FURTHER NOTICE TO ANY PRODUCTS HEREIN TO IMPROVE RELIABILITY, FUNCTION OR DESIGN. FAIRCHILD DOES NOT ASSUME ANY LIABILITY ARISING OUT OF THE APPLICATION OR USE OF ANY PRODUCT OR CIRCUIT DESCRIBED HEREIN; NEITHER DOES IT CONVEY ANY LICENSE UNDER ITS PATENT RIGHTS, NOR THE RIGHTS OF OTHERS.

LIFE SUPPORT POLICY

FAIRCHILD'S PRODUCTS ARE NOT AUTHORIZED FOR USE AS CRITICAL COMPONENTS IN LIFE SUPPORT DEVICES OR SYSTEMS WITHOUT THE EXPRESS WRITTEN APPROVAL OF THE PRESIDENT OF FAIRCHILD SEMICONDUCTOR CORPORATION. As used herein:

1. Life support devices or systems are devices or systems which, (a) are intended for surgical implant into the body, or (b) support or sustain life, and (c) whose failure to perform when properly used in accordance with instructions for use provided in the labeling, can be reasonably expected to result in a significant injury of the user.
2. A critical component in any component of a life support device or system whose failure to perform can be reasonably expected to cause the failure of the life support device or system, or to affect its safety or effectiveness.