

PRODUCT NO.
XXXXX-YYYP LF

- LEAD FREE OPTION (SEE NOTE 8 & 10)
- PACKAGING OPTIONS (SEE NOTE 6)
- NO. OF POSITIONS (SEE NOTE 5)
- PLATING NUMBER (SEE SHEET 2)
- BASE PART NUMBER (SEE SHEET 4)

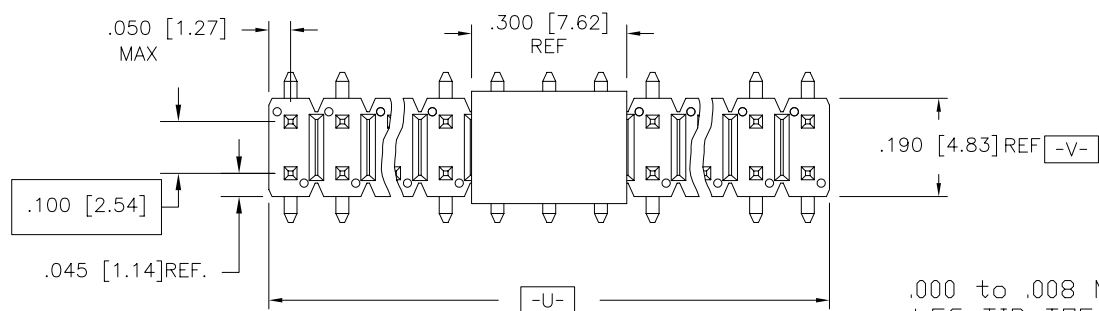

□ .025±.001 [0.64±0.03] TYP.
 ⊕ ∅.020/0.51 U Ⓢ V
 NOTE 4

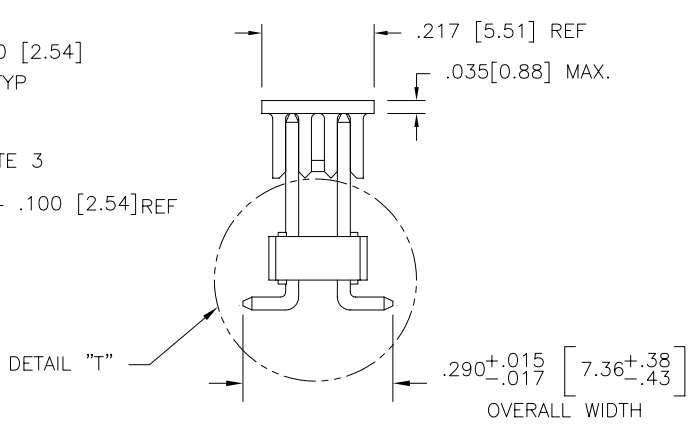
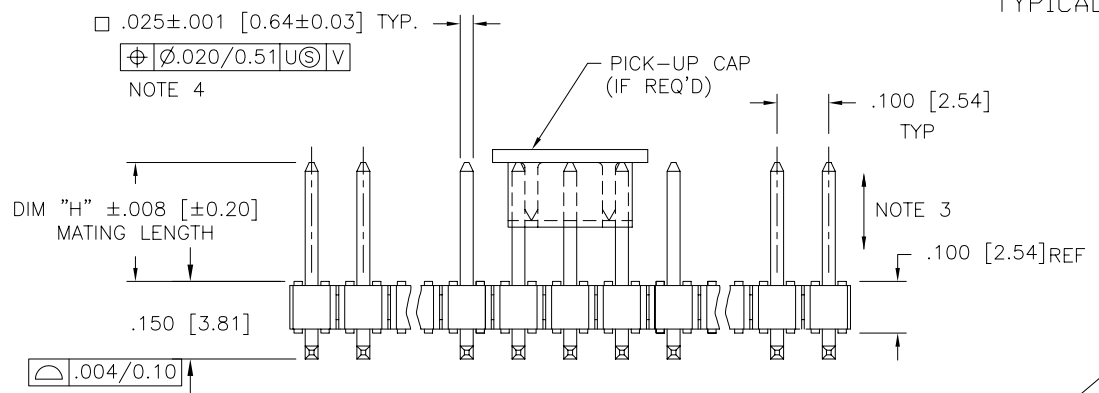

mat'l. code				surface ISO 1302 ✓		tolerance ISO 406 ISO 1101		projection INCH/MM		product family BERGSTIK			
ltr	ecn	no	dr	date		tolerances unless otherwise specified		INCH/MM		title			
S	E20022	TAB	1/06/03	1/06/03		angles	linear	.xx±.01/0.3		BERGSTIK® II HEADER DR			
T	v03-0658	DAI	6/16/03	6/16/03				.xxx±.005/0.13		.100cc DUPLEX VERT. SMT.			
U	v05-0222	LP	3/14/05	3/14/05		0°±2'		.xxx±.0020/0.051		scale 3:1		dwg no	
V	M05-0118	AGS	6/03/05	6/03/05		dr	M. CLOUSER	4/28/95		sheet 1 of 4		size	
W	M06-0271	AGS	7/15/06	7/15/06		enrg	T. HANNA	4/28/95		95157		A3	
X	M06-0360	MHT	9/13/06	9/13/06		chr	T. HANNA	4/28/95		type		Product Customer Drawing	
Y	M07-0449	AGS	10/10/07	10/10/07		appd	T. HANNA	4/28/95					
sheet	revision	Y	Y	Y	Y	Y	Y						
index	sheet	1	2	3	4								



Copyright FCI

PRODUCT NUMBER	CONTACT AREA "DIM D" PLATING	TAIL PLATING	
XXXXX-1YY	30u"/0.76u Au OVER 50u"/1.27u Ni.	100u"/2.54u TIN OVER 50u"/1.27u Ni.	(NOTE 11)
XXXXX-2YY	15u"/0.38u Au OVER 50u"/1.27u Ni.	100u"/2.54u TIN OVER 50u"/1.27u Ni.	(NOTE 11)
XXXXX-1YYLF	30u"/0.76u Au OVER 50u"/1.27u Ni.	100u"/2.54u TIN OVER 50u"/1.27u Ni.	(NOTE 11)
XXXXX-2YYLF	15u"/0.38u Au OVER 50u"/1.27u Ni.	100u"/2.54u TIN OVER 50u"/1.27u Ni.	(NOTE 11)
XXXXX-4YYLF	100u"/2.54u" min Sn OVER 50u"/1.27u min Ni.	100u"/2.54u TIN OVER 50u"/1.27u Ni.	(NOTE 11)

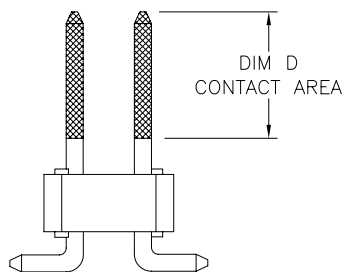

DOUBLE ROW SMT
END VIEW

NOTES:

- ① BODY MATERIAL: GLASS FIBER REINFORCED PCT FLAME RETARDENT PER UL-94V-0. COLOR: BLACK
- ② PIN MATERIAL: PHOS-BRONZE.
- ③ 2 Lbs / 0.9 Kg MIN PIN RETENTION IN EITHER DIRECTION.
- ④ MEASURED WITH PART IN RESTRAINED CONDITION.
- ⑤ NUMBER OF POSITIONS FROM 4(2X2) THRU 40(2X20) EXCEPT TAPE-ON-REEL AVAILABLE 4(2X2) THRU 34(2X17) ONLY.
- ⑥ PACKAGING OPTIONS: CHECK SPECIFIC PART NUMBERS FOR AVAILABILITY.
PART NUMBERS WITHOUT A SUFFIX ARE PACKAGED IN POLY BAGS.
PART NUMBERS FOLLOWED BY A "T" SUFFIX ARE PACKAGED IN TUBES.
PART NUMBERS FOLLOWED BY A "V" SUFFIX ARE PACKAGED TAPE-ON-REEL WITH A PICK-UP CAP INSTALLED CENTRALLY LOCATED.
PART NUMBERS FOLLOWED BY A "W" SUFFIX ARE PACKAGED TAPE-ON-REEL WITHOUT A PICK-UP CAP.
- ⑦ CONTACT MARKETING BEFORE ORDERING ODD POSITION PART NUMBERS (2X3,2X5,2X7,ETC.).
- ⑧ ADD LF TO THE END OF PART NUMBER FOR LEAD FREE OPTION.
- ⑨ THE HOUSING WILL WITHSTAND EXPOSURE TO 260°C PEAK TEMPERATURE FOR 20 SECONDS IN A CONVECTION, INFRA-RED OR VAPOR PHASE REFLOW OVEN. SEE APPLICATION NOTES/PROCEDURES IF THEY ARE AVAILABLE.
- ⑩ THESE PRODUCTS MEETS EUROPEAN UNION DIRECTIVES AND OTHER COUNTRY REGULATION AS DESCRIBED IN GS-22-008.
- ⑪ "THIS PRODUCT HAS 100% TIN PLATING IN THE INTERFACE AND HAS NOT BEEN TESTED FOR WISKER GROWTH IN ALL INTERCONNECT ENVIROMENTS".

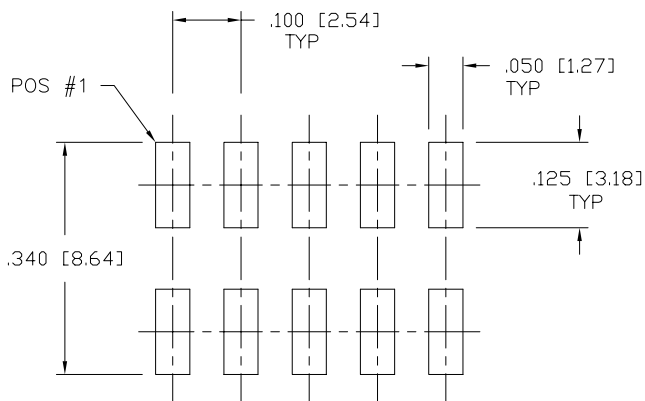

DOUBLE ROW
RECOMMENDED PAD LAYOUT
SCALE: 4/1

mat'l. code		surface ISO 1302 ✓		tolerance ISO 406 ISO 1101		projection INCH/MM		product family BERGSTIK	
ltr	ecn	no	dr	date		tolerances unless otherwise specified		title	
Y						angles	linear	BERGSTIK® II HEADER DR	
						0°±2'	.xx±.01/0.3 .xxx±.005/0.13 .xxxx±.0020/0.051	.100cc DUPLEX VERT. SMT.	
						dr	M. CLOUSER	4/28/95	dwg no
						enr	T. HANNA	4/28/95	sheet2 of 4
						chr	T. HANNA	4/28/95	size
						appd	T. HANNA	4/28/95	A3
sheet index		revision sheet						type Product Customer Drawing	

PRODUCT NUMBER
SEE TABLE

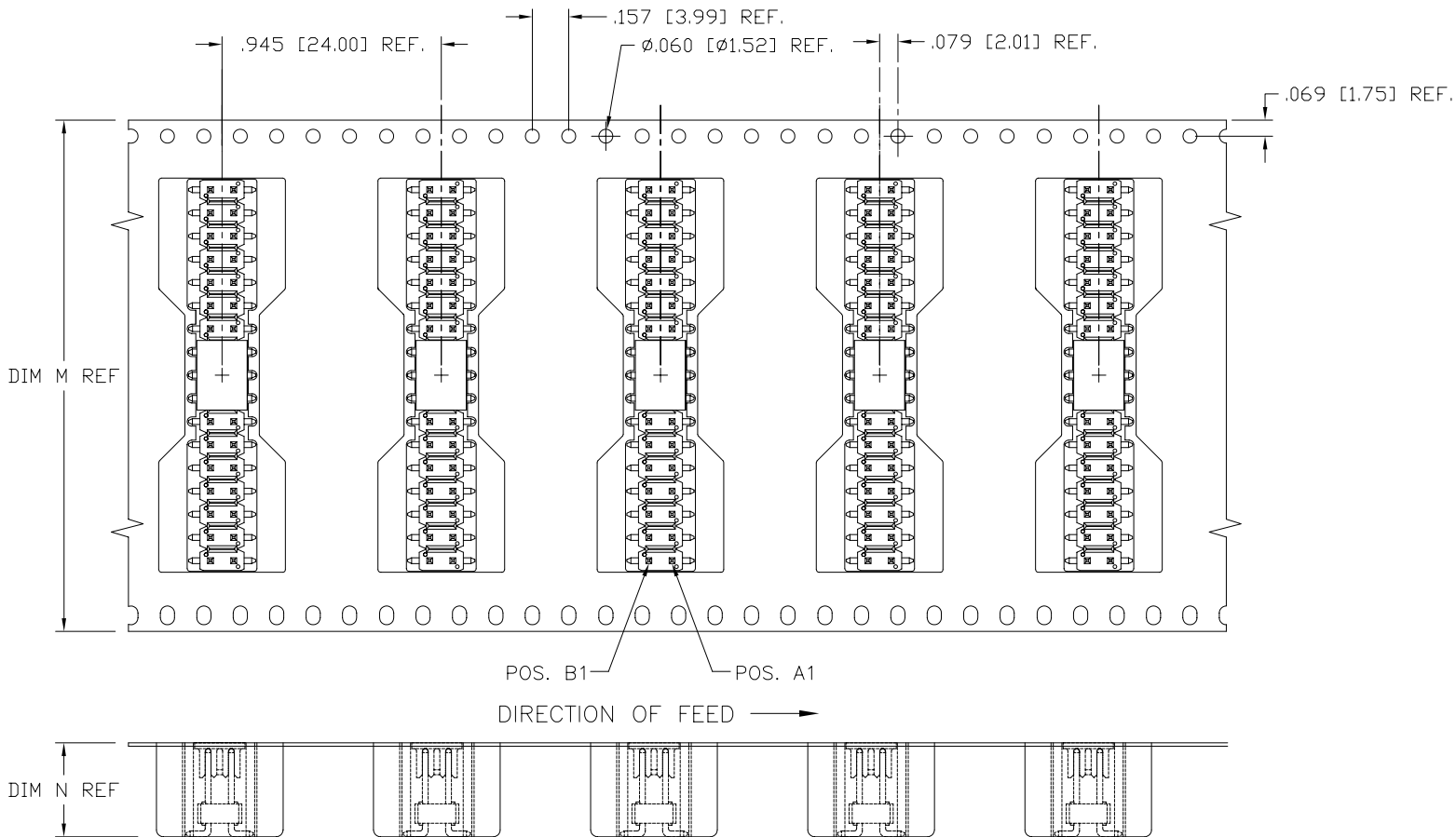

Copyright FCI

mat'l. code		surface ISO 1302 ✓	tolerance ISO 406 ISO 1101	projection ⊕-∇	product family BERGSTIK
ltr	ecn no dr	date		tolerances unless otherwise specified	title
Y				linear .xx±.01/0.3 .xxx±.005/0.13 .xxxx±.0020/0.051	BERGSTIK® II HEADER DR .100cc DUPLEX VERT. SMT.
		angles 0°±2'		INCH/MM scale 3:1	dwg no sheet 3 of 4 size
		dr M. CLOUSER 4/28/95			95157 A3
		enr T. HANNA 4/28/95			type Product Customer Drawing
		chr T. HANNA 4/28/95			
		appd T. HANNA 4/28/95			
sheet index	revision sheet				

form: A3

PRODUCT NUMBER	MATING LENGTH DIM H	CONTACT AREA DIM D	TAPE WIDTH DIM M	POCKET DEPTH DIM N	PACKAGING	LF OPTION
55426-XXY	NOT AVAILABLE					SEE NOTES 8, 9, 10
72598-XXY	.330/8.38	.200/5.08	-/-	-/-	POLY BAGS	
84731-XXY	NOT AVAILABLE					
84733-XXY	NOT AVAILABLE					
95157-XXY	.230/5.84	.185/4.70	2.20/55.9	.43/11.0	POLY BAGS/TAPE-ON-REEL/TUBES	
95157-210V	.230/5.84	.185/4.70	1.26/32	.43/11.0	TAPE ON REEL	
95157-216V	.230/5.84	.185/4.70	1.73/44	.43/11.0	TAPE ON REEL	
95159-XXY	.318/8.08	.200/5.08	2.20/55.9	.52/13.2	POLY BAGS/TAPE-ON-REEL/TUBES NOTE 7	
98273-XXY	.360/9.14	.200/5.08	-/-	-/-	POLY BAGS	



Copyright FCI

mat'l. code		surface ISO 1302 <input checked="" type="checkbox"/>	tolerance ISO 406 ISO 1101	projection 	product family BERGSTIK
ltr	ecn no dr	date		tolerances unless otherwise specified	title
Y				angles linear 0°±2'	BERGSTIK® II HEADER DR .100cc DUPLEX VERT. SMT.
				.xx±.01/0.3 .xxx±.005/0.13 .xxxx±.0020/0.051	INCH/MM
				dr M. CLOUSER 4/28/95 enr T. HANNA 4/28/95 chr T. HANNA 4/28/95 appd T. HANNA 4/28/95	scale 3:1
					FCJ
sheet index	revision sheet				dwg no 95157 sheet 4 of 4 size A3
					type Product Customer Drawing