

DESCRIPTION/APPLICATION

Designed to European specifications, these two piece blocks provide interconnection between wire and PC board. Wire is terminated at the connector and the header is mounted to the PC board. The pluggable design expedites field servicing and troubleshooting.

DESIGN ADVANTAGES

- Pitches Available:
 - 3,5mm (0.138")
 - 5,0mm (0.197")
 - 5,08mm (0.200")
 - 7,0mm (0.276")
 - 10,0mm (0.394")
 - 10,16mm (0.400")
- Locking fingers provide secure "vibration-proof" connection.
- Mate with either closed-end or open-end shrouded headers.
- Available in two connection styles:
 - Cage clamp for superior connection.
 - Wire protection for economical designs.
- Vertical, horizontal, or universal mounting.
- Optional press-on coding key and polarizing clip system for B52 series. Polarized feature of connector and header allows for varied applications.
- UL94V-0 rated thermoplastic insulator housing.
- Gold and silver plated terminals available in addition to standard tin plating.
- Terminal marking available.
- Shrouded headers provide increased circuit isolation with 4 sided barrier protection.

TWO PIECE / PLUGGABLE CONNECTORS

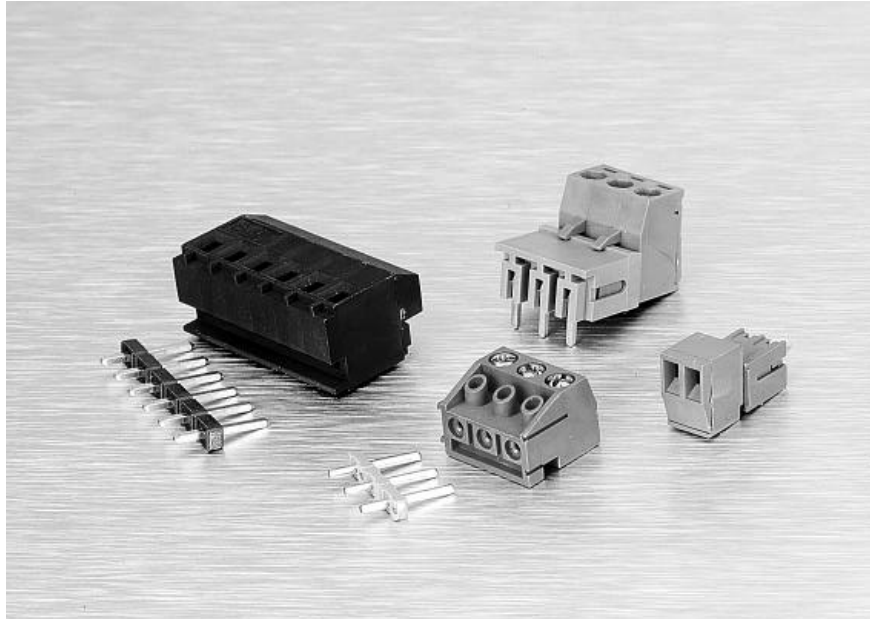

CONNECTOR INDEX

3,5mm Connector with Cage Clamp	32
3,5mm Header	33
5mm Flush Connector with Cage Clamp	34
5mm Flush Header	35
5mm Locking Connector with Cage Clamp	36
5mm Open End Header	37
5mm Closed End Header	38, 39
5mm Fastening Block, Latch	40
5mm Flush Connector and Header Combo	41
5mm Flush Connector with Wire Protector	42
5mm Flush Header	43
5,08mm Flush Connector with Cage Clamp	44
5,08mm Flush Header	45
5,08mm Locking Connector with Cage Clamp	46
5,08mm Header	47
3,5mm Polarizing Accessories	48

5,08MM PLUG-IN LOCKING CONNECTORS WITH CAGE CLAMP SERIES 2ESD

PHYSICAL PROPERTIES

Housing:

HOUSING MATERIAL: Thermoplastic

FLAMMABILITY: UL94V-0

COLORS: Green or Black

Terminal:

CONTACTS: Bright acid-tin plated copper alloy

CAGE CLAMP: Zinc plated steel with yellow chromate coating M2.5

Mechanical:

RECOMMENDED TIGHTENING TORQUE: 4.5 in. lb.

ELECTRICAL PROPERTIES

RATING: 10 Amps, 300 volts/15 amps, 150 volts (limited ratings)

WIRE RANGE: 14-28 AWG (solid)
14-30 AWG (stranded)

ENVIRONMENTAL PROPERTIES

MAX. OPERATING TEMPERATURE: 105° C .



5,08mm and 10,16mm Pitch

2ESDV (vertical mounting)

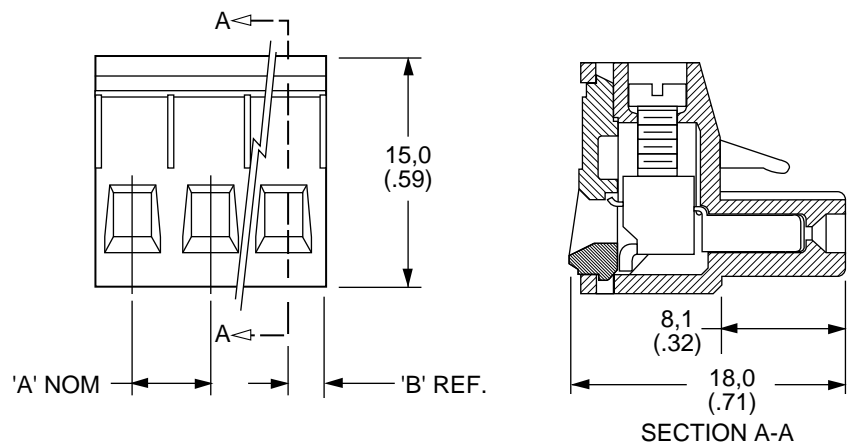

Ordering Information

# OF TERMINALS	5,08MM VERTICAL GREEN	5,08MM VERTICAL BLACK
2	2ESDV-02	2ESDV-02-1
3	2ESDV-03	2ESDV-03-1
4	2ESDV-04	2ESDV-04-1
5	2ESDV-05	2ESDV-05-1
6	2ESDV-06	2ESDV-06-1
7	2ESDV-07	2ESDV-07-1
8	2ESDV-08	2ESDV-08-1
9	2ESDV-09	2ESDV-09-1
10	2ESDV-10	2ESDV-10-1
11	2ESDV-11	2ESDV-11-1
12	2ESDV-12	2ESDV-12-1

A	B
5,08 (.200")	2,54 (.100")

NOTE: For 13-24 positions molded to length, minimum order is 2500 pieces

5,08MM HEADERS (FOR SERIES 2ESD CONNECTORS) SERIES 2EHD

PHYSICAL PROPERTIES

Housing:

HOUSING MATERIAL: Thermoplastic
FLAMMABILITY: UL94V-0
COLORS: Green or Black

Terminal:

CONTACTS: Bright acid-tin plated copper alloy
SOLDERABILITY: MIL STD 202, Method 208

Mechanical:

PITCH (TERMINAL LENGTH): 5,08mm
RECOMMENDED PCB HOLE DIA.: .067" diameter

ELECTRICAL PROPERTIES

RATING: 10 Amps, 300 volts/15 amps, 150 volts
(limited ratings)

ENVIRONMENTAL PROPERTIES

MAX. OPERATING TEMPERATURE: 105° C.



5,08mm Pitch

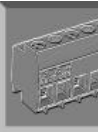

2EHDR (right angle solder pins)

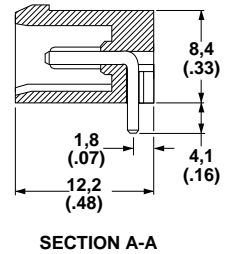
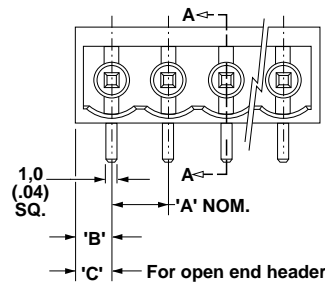

Ordering Information

# OF TERMINALS	5,08MM VERTICAL CLOSED END	5,08MM RIGHT ANGLE CLOSED END
2	2EHDV-02	2EHDR-02
3	2EHDV-03	2EHDR-03
4	2EHDV-04	2EHDR-04
5	2EHDV-05	2EHDR-05
6	2EHDV-06	2EHDR-06
7	2EHDV-07	2EHDR-07
8	2EHDV-08	2EHDR-08
9	2EHDV-09	2EHDR-09
10	2EHDV-10	2EHDR-10
11	2EHDV-11	2EHDR-11
12	2EHDV-12	2EHDR-12

2EHDV (vertical solder pins)

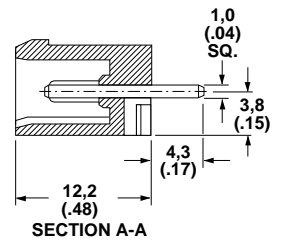
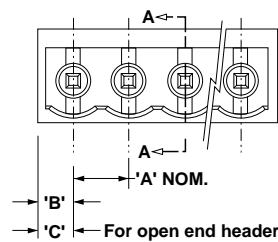

A	B	C
5,08	3,1	2,54
(.200")	(.12")	(.100)

NOTE: For 13-24 positions molded to length, min. order is 2500 pieces

NOTE: For open ended headers, consult factory. Min. order is 2500 pieces

NOTE: Add "-1" for molding color black