

MS1532

**RF & MICROWAVE TRANSISTORS
UHF TV LINEAR APPLICATIONS**

Features

- 470 – 860 MHz
- 26.5 VOLTS
- P_{OUT} = 20 WATTS
- G_P = 9.5 dB MINIMUM
- INTERNAL INPUT MATCHING
- COMMON EMITTER CONFIGURATION

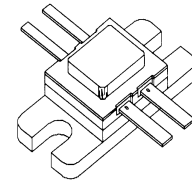

.400 x .425 4LFL (M119)
hermetically sealed

DESCRIPTION:

The MS1532 is a gold metallized epitaxial silicon NPN planar transistor designed for use in linear applications up to 1 GHz. Emitter Ballast resistors provide stable linear operation for UHF television transmitter, transponders and cellular base stations applications.

PIN CONNECTION

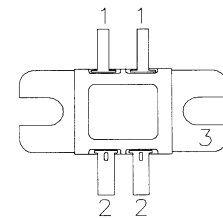

1. Collector 3. Emitter
2. Base

ABSOLUTE MAXIMUM RATINGS (T_{case} = 25°C)

Symbol	Parameter	Value	Unit
V _{CBO}	Collector-Base Voltage	60.0	V
V _{EBO}	Emitter-Base Voltage	4.0	V
V _{CES}	Collector-Emitter Voltage	60.0	V
P _{DISS}	Power Dissipation	88.8	W
I _C	Device Current	11.0	A
T _J	Junction Temperature	+200	°C
T _{STG}	Storage Temperature	-65 to +150	°C

Thermal Data

R _{TH(J-C)}	Thermal Resistance Junction-case	1.9	°C/W
----------------------	----------------------------------	-----	------

ELECTRICAL SPECIFICATIONS (T_{case} = 25°C)
STATIC

Symbol	Test Conditions		Value			Unit
			Min.	Typ.	Max.	
BV_{CES}	I_C = 50 mA	V_{BE} = 0 V	60	---	---	V
BV_{CEO}	I_C = 50 mA	I_B = 0 mA	28	---	---	V
BV_{EBO}	I_E = 10 mA	I_C = 0 mA	3	---	---	V
I_{CBO}	V_{CB} = 26.5 V	I_E = 0 mA	---	---	5	mA
HFE	V_{CE} = 5 V	I_C = 3 A	25	---	80	---

DYNAMIC

Symbol	Test Conditions			Value			Unit
				Min.	Typ.	Max.	
P_{OUT}	f = 836 MHz	P_{IN} = 2.2 W	V_{CE} = 26.5 V	20.0	---	---	W
G_p	f = 836 MHz	P_{IN} = 2.2 W	V_{CE} = 26.5 V	9.5	---	---	dB
C_{OB}	f = 860 MHz	V_{CB} = 26.5 V	(Per side)	---	---	36	pf

PACKAGE MECHANICAL DATA

PACKAGE STYLE M119

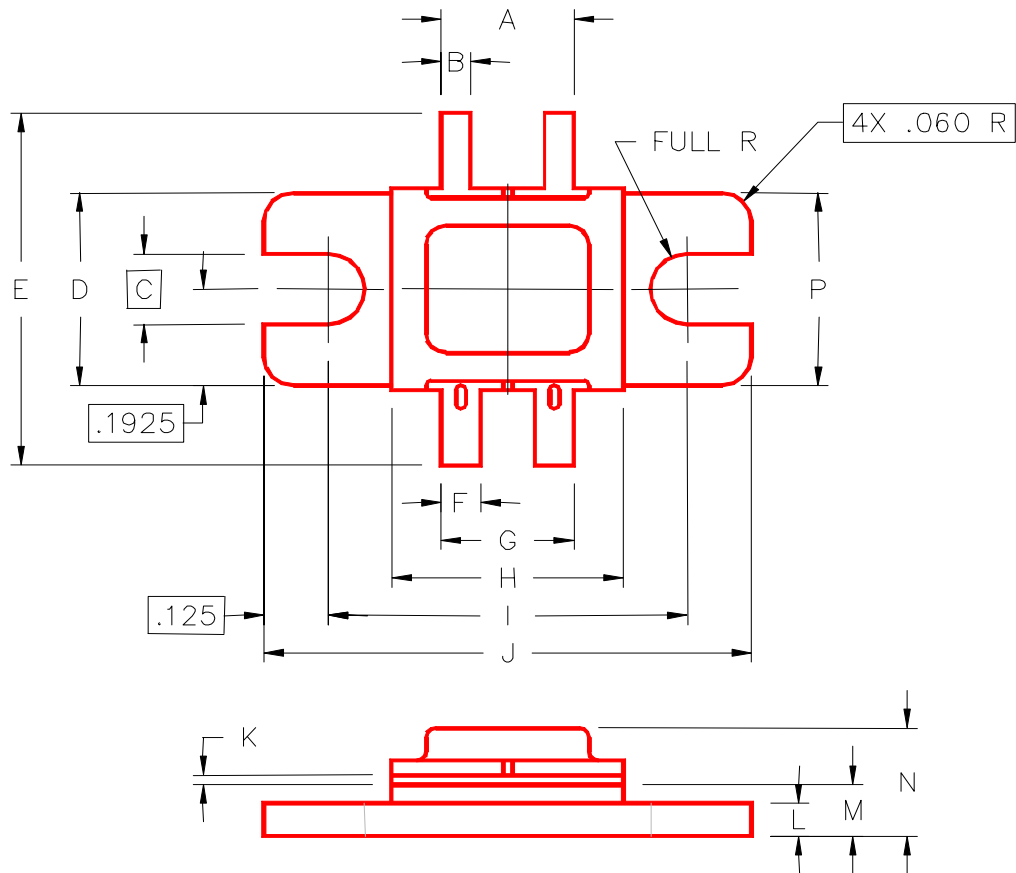

	MINIMUM INCHES/MM	MAXIMUM INCHES/MM		MINIMUM INCHES/MM	MAXIMUM INCHES/MM
A	.210/5,33	.230/5,84	I	.645/16,38	.655/16,64
B	.045/1,14	.055/1,40	J	.895/22,73	.905/22,99
C	.130/3,30		K	.002/0,05	.006/0,15
D	.380/9,65	.390/9,91	L	.058/1,47	.065/1,65
E	.770/19,56	.830/21,08	M	.115/2,92	.130/3,30
F	.070/1,78	.080/2,03	N	-----	.230/5,84
G	.215/5,46	.235/5,97	P	.395/10,03	.405/10,29
H	.420/10,67	.430/10,93			