

**IDC - FEMALE HEADER  
ID: 344**

BL 21/2-0760IDC

Series 735

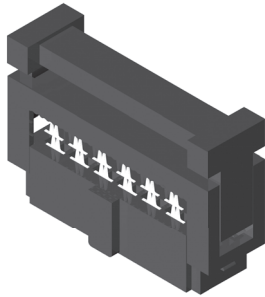

**TECHNICAL DATA**

Pitch	1,27 mm / 2,54 mm
Insulating Material	Thermoplast UL94V-0
Contact Material	phosphor bronze
Rated Current	0,5 Amp.
Rated Voltage	100 V <sub>RMS</sub> / 150 V <sub>DC</sub>
Withstanding Voltage	500 V <sub>AC</sub> for one minute
Operating Temperature	-40°C to +105°C

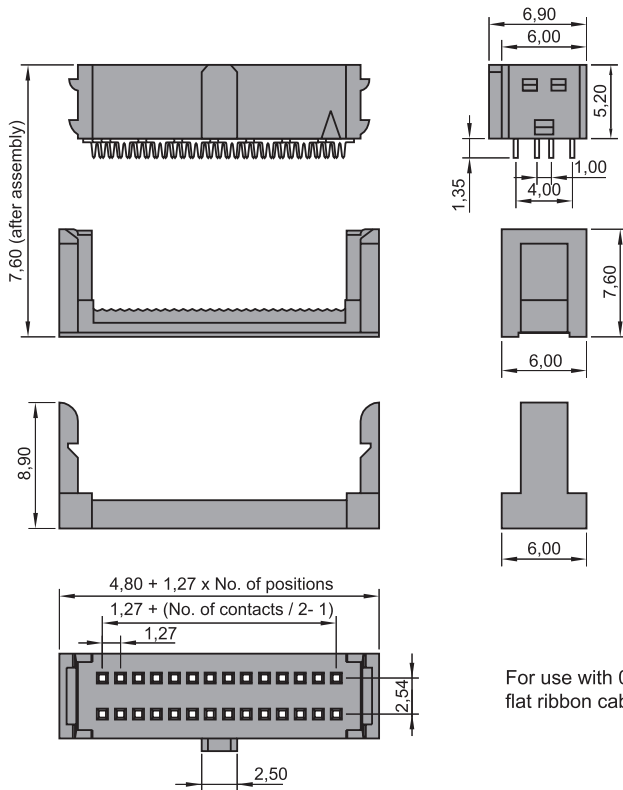

For use with 0,635 mm flat ribbon cable.

All dimensions in mm.  
Other dimensions upon request.

BL 21/2 - 0760 IDC - XX - X - XXX L

21/2: 2 rows, pitch 1,27/2,54mm

0760: mounting height 7,6mm

Plating: TT = Sn  
GT = sel. Au  
GG = Au

Version: 1 = with strain relief  
0 = without strain relief

L: RoHS-compliant with standard temp. plastic

Poles: 10 / 16 / 20 / 26 / 30 / 34 / 40 / 50 / 60 / 68 / 80 / 100 contacts

1,27 / 2,54 mm  
8