

RECOMMENDED PCB LAYOUT

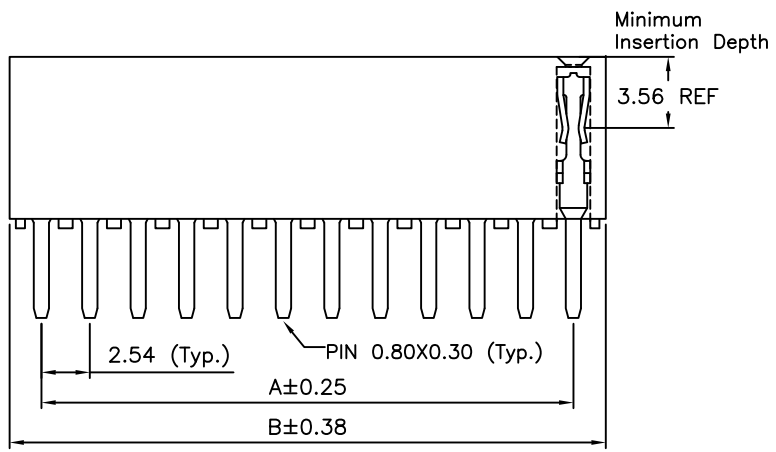
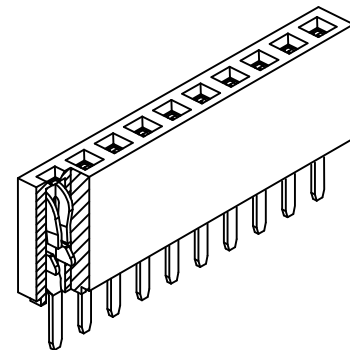
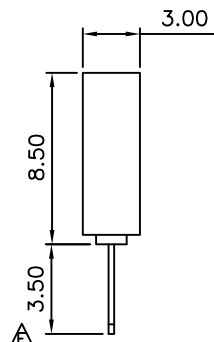

CONTACTS	DIMENSIONS	
	A	B
2	2.54	5.88
3	5.08	8.42
4	7.62	10.96
5	10.16	13.50
6	12.70	16.04
7	15.24	18.58
8	17.78	21.12
9	20.32	23.86
10	22.86	26.20
11	25.40	28.74
12	27.94	31.28
13	30.48	33.82
14	33.02	36.36
15	35.56	38.90
16	38.10	41.44
17	40.64	43.98
18	43.18	46.52
19	45.72	49.06
20	48.26	51.60
21	50.80	54.14
22	53.34	56.68
23	55.88	59.22
24	58.42	61.36
25	60.96	64.30
26	63.50	66.84
27	66.04	69.38
28	68.58	71.92
29	71.12	74.46
30	73.66	77.00
31	76.20	79.54
32	78.74	82.08
33	81.28	84.62
34	83.82	87.16
35	86.36	89.70
36	88.90	92.24
37	91.44	94.78
38	93.98	97.32
39	96.52	99.86
40	99.06	102.40

SPECIFICATIONS 规格

CURRENT RATING 电流额定值: 3 AMP
INSULATOR RESISTANCE 绝缘电阻值: 1000 MEGOHMS MIN.
DIELECTRIC WITHSTANDING 耐电压: AC 600 V
CONTACT RESISTANCE 接触电阻值: 20mΩ Max.
OPERATING TEMPERATURE 工作温度: -40°C TO +105°C
CONTACT MATERIAL 端子物料: COPPER ALLOY
INSULATOR MATERIAL 绝缘体物料:
 STANDARD 标准物料: POLYAMIDE 聚酰胺, NYLON 6T, UL 94-V0
 OPTIONS 可选物料: POLYESTER 聚酯, LCP, UL 94-V0
 OR POLYESTER 聚酯, PBT, UL94-V0
SOLDERING PROCESS 可焊性:
 NYLON 6T (STANDARD 标准物料) -
 IR REFLOW 回流焊: 260°C for 10 sec.
 WAVE 波峰焊: 230°C for 5-10 sec.
 MANUAL SOLDER 人工焊接: 350°C for 3-5 sec
 PBT (OPTION 可选物料) - MANUAL SOLDER 人工焊接: 330°C for 3-5 sec.
 (NOT SUITABLE FOR HI-TEMP PROCESS 不适合高温处理)
 LCP (OPTION 可选物料) -
 IR REFLOW 回流焊: 260°C for 10 sec. Δ
 WAVE 波峰焊: 250°C for 5-10 sec.
 MANUAL SOLDER 人工焊接: 350°C for 3-5 sec Δ
MATES WITH 配套之母座 (SUBJECT TO PIN LENGTH 在端子长度适合的条件下):
 BG020 BG030 BG035 BG055 BG060
 BG075 BG080

Ordering Grid

BG130	XX	X	0350	X	X	REQUEST SAMPLES AND QUOTATION
-------	----	---	------	---	---	-------------------------------

No. of Contacts: 02 to 40
 Contact Plating: A = Gold Flash All Over (Standard), B = Selective Gold Flash Contact Area/Tin On Tail, C = Tin All Over, G = 10µ" Gold Contact Area/Tin On Tail, I = 30µ" Gold Contact Area/Tin On Tail
 Insulator Material: N = Nylon 6T (Standard), P = PBT, L = LCP
 Tail Length (1/100mm): 0350 = 3.50mm Δ
 Packing Options: D = Tube (Standard), E = Tube with Cap, F = Tube with Film, G = Plastic Box

By	LYH	PN	CB	DR	AJO
DETAIL	DRAWING RELEASE	STANDARD INSULATOR MATERIAL CHANGED	PACKING OPTIONS CHANGED	CHANGE TO SOLDER TEMP. INFORMATION	SELECTABLE LENGTH REMOVED
REV	A	B	C	D	E
DATE	30/10/06	12/03/09	27/04/09	05/08/09	16/07/12



Tolerances (Except as noted)	Part Number:-	Date:-
Dimensions in mm	BG130	30 OCT 06
X. ± 0.30 X° ± 5°	Description:-	
X.X ± 0.20 X° ± 2°	2.54mm PITCH SOCKET, SINGLE ROW, THROUGH-HOLE, VERTICAL	
X.XX ± 0.15 XX° ± 1°		
X.XXX ± 0.10 XXX° ± 0.5°		
Third Angle Projection	THIS DRAWING IS CONFIDENTIAL AND MUST NOT BE COPIED OR DISCLOSED WITHOUT WRITTEN CONSENT	

GCT

www.globalconnectortechnology.com

Scale	Revision	Material	Drawn by	Sheet No.
NTS	E	See Note	LYH	E & OE 1/1