

**SPECIFICATIONS**

Current rating: 3 amps AC/DC  
 Voltage rating: 250 VAC  
 Contact resistance: 20 milliohms max.  
 Housing material: Nylon, UL94V-0  
 Insulation resistance: 1000 megohms min.  
 Withstanding: 1500 VAC/1-min.  
 Operating temp.: -40°C to +105°C  
 Terminal retention to housing 6.6 lbs (3.0kg) min.

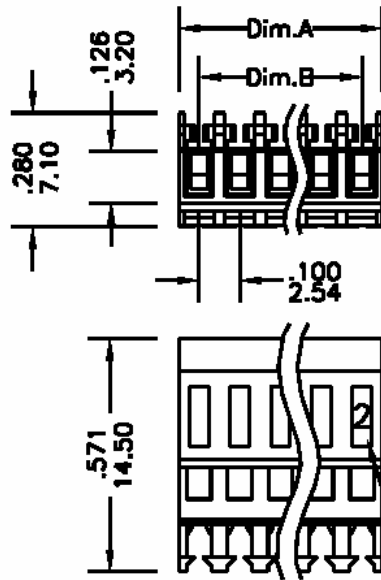

A=.100 X No. positions  
 B=.100 X No. spaces

**UNIT: INCH  
 MM**

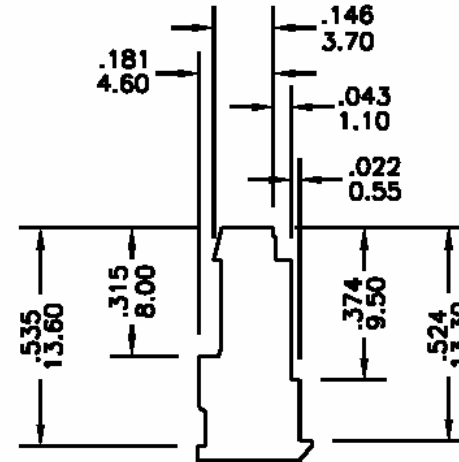

**Wire Gauge 2 = 22AWG  
 4 = 24AWG  
 6 = 26AWG  
 8 = 28AWG**

Series	Pitch	Wire size	Positions	Options
CMT	XXX	XX	XX	XX
Mass termination IDC type housing	254=0.100" 396=0.156"	22, 24, 26, 28 (254 pitch) 18, 20, 22, 24 (396 pitch)	2-28	[blank]=None FT=Feed thru type NR=No locking ramp V2=UL94V-2 P=Polarizing rib

**RoHS compliant**

Rev.	Description	Date	Approved	Drawing	Name	Date
				Approved	Howard	8/10/99
				Checked	Lizzy	8/10/99
				Drawn	Tina	8/10/99
				0.0 ± 0.35	0.00 ± 0.20	Angles ± 3'
					UNIT: mm	

**Central Components Manufacturing**  
 440 Lincoln Blvd., Middlesex, New Jersey 08846  
 Phone 732 469-5720 888 288-5152 Fax 732 469-1919

Part No.: **CMT-254-XX-XX-XX**

Description: Mass termination connector (Mascon)