

*** 2502 Series ***

* Insulator : UL 94V-0 NYLON 6/6

* Contact : Brass

* Ordering Information :

2502P *** 000

1 2

1. NO. of circuits

2. Plating :

0= Tin plated 120u" min. over 30u"min. nickel overall

U= Gold flash over 30u"min. nickel overall

Z= 30u"min. gold over 30u"min. nickel overall

W= 15u"min. gold over 30u"min. nickel overall

RoHS COMPLIANT

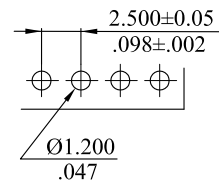
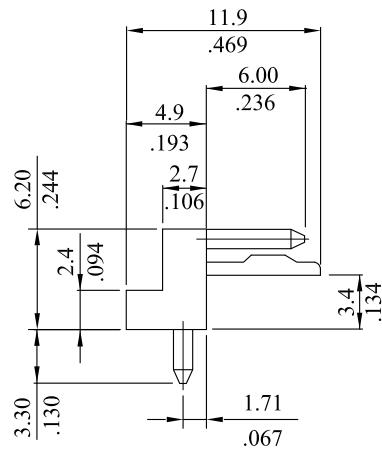
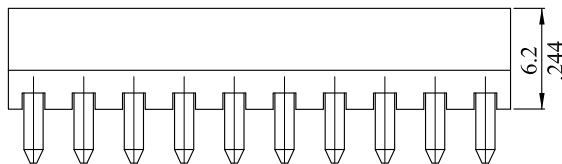
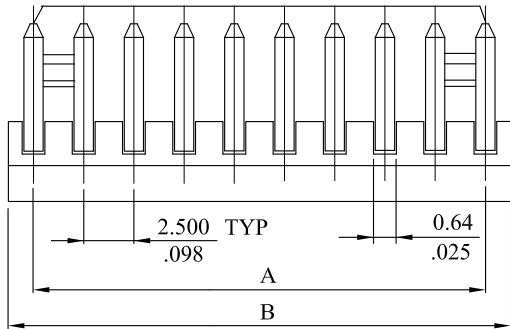

RECOMMENDED HOLE PATTERN

| CIRCUITS | PART NO. | DIMENSION | |
|----------|-------------|--------------|-------------|
| | | A | B |
| 2 | 2502P020000 | 2.50(.098) | 5.0(.197) |
| 3 | 2502P030000 | 5.00(.197) | 7.5(.295) |
| 4 | 2502P040000 | 7.50(.295) | 10.0(.394) |
| 5 | 2502P050000 | 10.00(.394) | 12.5(.492) |
| 6 | 2502P060000 | 12.50(.492) | 15.0(.591) |
| 7 | 2502P070000 | 15.00(.591) | 17.5(.689) |
| 8 | 2502P080000 | 17.50(.689) | 20.0(.787) |
| 9 | 2502P090000 | 20.00(.787) | 22.5(.886) |
| 10 | 2502P100000 | 22.50(.886) | 25.0(.984) |
| 11 | 2502P110000 | 25.00(.984) | 27.5(1.083) |
| 12 | 2502P120000 | 27.50(1.083) | 30.0(1.181) |
| 13 | 2502P130000 | 30.00(1.181) | 32.5(1.280) |
| 14 | 2502P140000 | 32.50(1.280) | 35.0(1.378) |
| 15 | 2502P150000 | 35.00(1.378) | 37.5(1.476) |
| 16 | 2502P160000 | 37.50(1.476) | 40.0(1.575) |
| 17 | 2502P170000 | 40.00(1.575) | 42.5(1.673) |
| 18 | 2502P180000 | 42.50(1.673) | 45.0(1.772) |
| 19 | 2502P190000 | 45.00(1.772) | 47.5(1.870) |
| 20 | 2502P200000 | 47.50(1.870) | 50.0(1.969) |

| | | | | | | | | | | | |
|------|----------|------|------|---|--|-----------|--|---|--|-----------------------------|--|
| | | | | LECO CORPORATION | | APPROVED: | | PART NO.: 2502P***000 | | | |
| D | ES101254 | | | GENERAL TOLERANCES: (UNLESS SPECIFIED) | | DATE: | | TITLE: HEADER | | | |
| C | ES050102 | | | | | CHECKED: | | | | | |
| B | E010080 | | | mm inch | | DATE: | | DRAWING NO.: 250203S | | | |
| A | DWG REL | | | | | DRAWN: | | | | | |
| REV. | ECO. NO. | CHG. | APP. | 4 PLACES ± -- ± .004 | | DATE: | | UNITS SCALE SIZE SHEET REV. | | | |
| | | | | ANGULAR ± (1°) | | | | mm inch | | 3:1 A4 1/1 D | |